

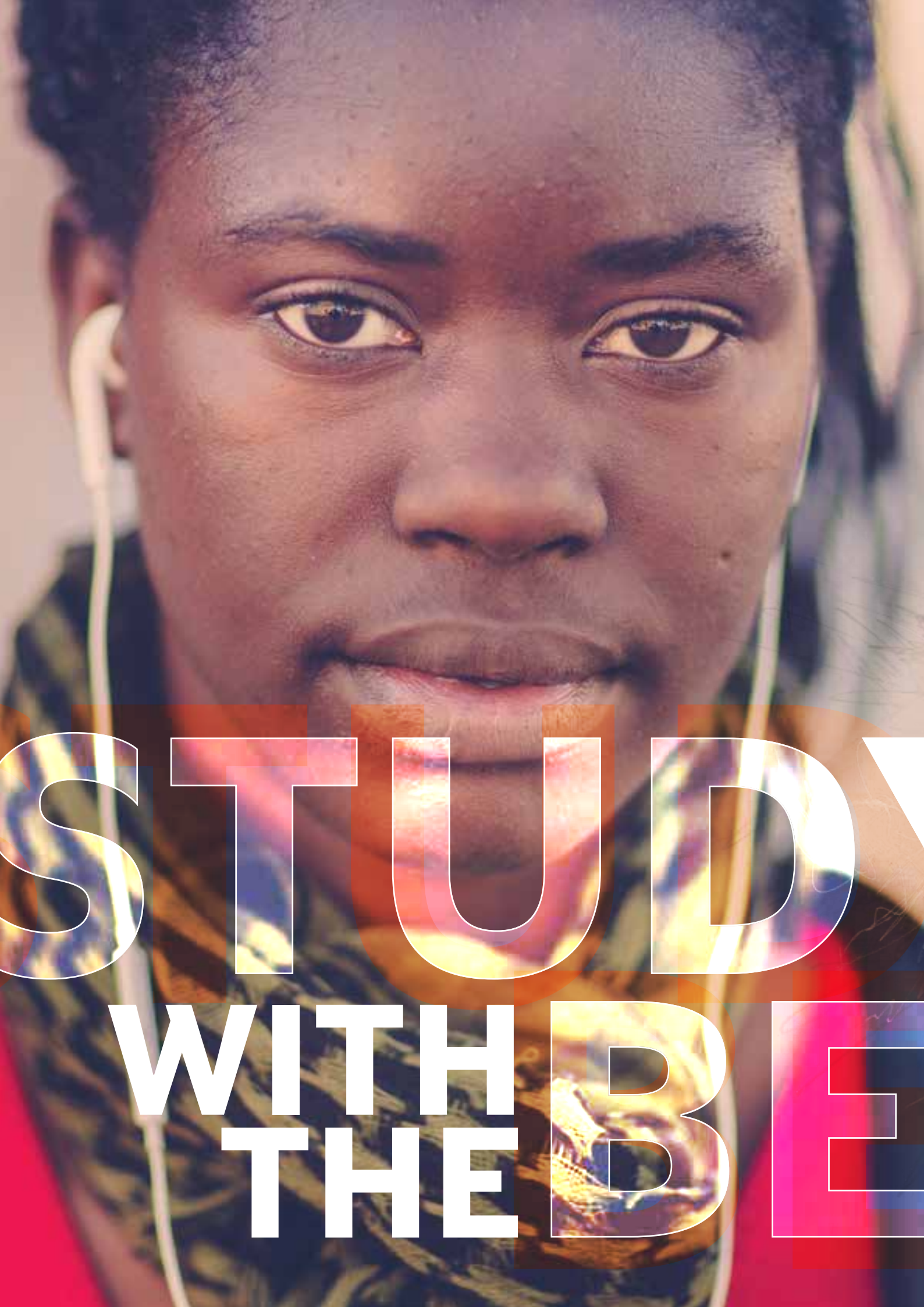

University of  
South Australia

# 2019 ART, ARCHITECTURE, PLANNING AND DESIGN





# STUDY WITH THE BE



**SA's #1**  
**UNIVERSITY**  
**FOR GRADUATE**  
**CAREERS**

*QILT: Graduate Destinations Survey 2015 and Graduate Outcomes Survey 2016–17 – Full-time Employment Indicator. Public SA-founded universities only.*

**No. 1**  
**INSA**  
**FOR STUDENT**  
**SATISFACTION**

*QILT: Course Experience Questionnaire 2016–17. Public SA-founded universities only.*

**RANKED 26th**  
**IN THE WORLD'S**  
**TOP 50 UNDER 50**

*2017 QS Top 50 Universities Aged Under 50*

To be the best in  
your field, you need a  
university that offers  
a choice of over 200  
world-class degrees,  
and is globally  
recognised for its  
teaching, research  
and facilities.

# GET CONNECTED

*with Australia's University of Enterprise*

## REAL CAREERS

We are number one in South Australia for graduate careers.\* We take a practical approach to teaching and learning so that our graduates can make a real impact in their chosen field.

*\*QILT: Graduate Destinations Survey 2015 and Graduate Outcomes Survey 2016–17 – Full-time Employment Indicator. Public SA-founded universities only.*

[unisa.edu.au/careers](http://unisa.edu.au/careers)



## WORLD-CLASS FACILITIES

Be surrounded by impressive, purpose-built facilities across all six campuses. Be supported by the latest technologies including our fully interactive online learning platform.

[unisa.edu.au/campus-facilities](http://unisa.edu.au/campus-facilities)



## TOP RANKING TEACHERS

Make your study experience relevant and learn from highly qualified academics and industry professionals. UniSA is Australia's best young university for teaching quality.

*\*Ranked Number 1, 2017 THE Top 200 Under 50 – Teaching Indicator.*

## GLOBAL EXPOSURE

Take part in international field trips, work placements, internships, study tours, short-term programs, volunteer opportunities, conferences or a student exchange.

[unisa.edu.au/globalopportunities](http://unisa.edu.au/globalopportunities)



**RIISING SUN** PICTURES



**Government of South Australia**  
Department for Education and  
Child Development



## POWERFUL PARTNERSHIPS

Our learning is influenced by industry, and the latest trends and demands. We collaborate with over 2,500 companies worldwide to bring our students placement, project, research and work opportunities.





University of  
South Australia

# Online

## STUDY ON DEMAND

Take full control over your study with our new 100% online, career-focused degrees. Get online student support seven days a week, plan your study to fit around your life, access learning resources 24/7, and log in to an online interactive learning environment anywhere, any time and on any device.

Explore our range of degrees in:

---

ACCOUNTING

---

---

BUILDING AND CONSTRUCTION

---

---

COMMUNICATION

---

---

COMMUNITY HEALTH

---

---

CRIMINAL JUSTICE

---

---

DIGITAL MEDIA

---

---

HUMAN RESOURCE MANAGEMENT

---

---

IT AND DATA ANALYTICS

---

---

MANAGEMENT

---

---

MARKETING

---

---

NUTRITION AND EXERCISE

---

---

PSYCHOLOGICAL SCIENCE AND SOCIOLOGY

---

**Take the next step and see if you're eligible  
by answering a few short questions.**

[unisaonline.edu.au](http://unisaonline.edu.au)

ASC

 **EY**  
Building a better  
working world

ANZ 

*tacsi* THE AUSTRALIAN  
CENTRE FOR SOCIAL  
INNOVATION

 **Calvary**

 **UNITING  
COMMUNITIES**

 **SA  
Power  
Networks**

---

## **No. 1 IN SA FOR GRADUATE CAREERS IN CREATIVE ARTS**

QILT: Graduate Destinations Survey 2015 and Graduate Outcomes Survey  
2016–17 – Full-time Employment Indicator. Public SA-founded universities only.

---

## **No. 1 IN SA FOR GRADUATE CAREERS IN ARCHITECTURE AND BUILDING**

QILT: Graduate Destinations Survey 2015 and Graduate Outcomes Survey  
2016–17 – Full-time Employment Indicator. Public SA-founded universities only.

---

## **JOIN THE AWARD-WINNING DESIGN CONSTRUCT PROGRAM ONE OF THE LARGEST STUDENT-LED CONSTRUCTION PROGRAMS IN THE WORLD**

# ART, ARCHITECTURE, PLANNING AND DESIGN

---





Develop your creativity and design thinking at a world-ranking school that integrates art, architecture, design and planning disciplines. Be mentored by professional artists, architects, designers and theorists who are leaders in their field. Explore your ideas and innovation through intensive studio practice in custom-built design workshops. Gain access to world-class facilities including the South Australian School of Art (SASA), Australia's only Architecture Museum and distinctive design spaces located on campus.

[unisa.edu.au/study](https://unisa.edu.au/study)

[unisa.edu.au/aad](https://unisa.edu.au/aad)

## REAL-WORLD EXPERIENCE

Engage with professional artists and designers during your studies through work placements, study tours, mentoring and events. Showcase your work in our student exhibitions that are open to industry and the wider community.

## FOLLOW US

Connect with our art, architecture, planning and design accounts on Instagram to see our latest student artwork, exhibitions and real-world applications.



[unisa.art](#)  
[unisa.architecture](#)  
[unisa.interiorarchitecture](#)  
[unisa.productdesign](#)  
[unisa.communicationdesign](#)  
[unisa.masterofdesign](#)  
[unisa.urbanandregionalplanning](#)

## MATCH STUDIO

This dynamic space brings together teams of students, academics and researchers to engage, think, learn and co-create innovative design solutions to real-world challenges. Generate, experiment and test ideas for products, services, policy and social innovation. Develop concepts and prototypes for industry, government and community clients. Participate in *Match+* network events and activities and graduate career-ready.

[unisa.edu.au/matchstudio](https://unisa.edu.au/matchstudio)

## UNDERGRADUATE

Architectural Studies / 10  
Interior Architecture / 11  
Product Design / 12  
Illustration and Animation / 12  
Communication Design / 13  
Urban and Regional Planning / 14  
Contemporary Art / 14

## POSTGRADUATE

Architecture / 16  
Urban and Regional Planning / 17  
Design / 18

## RESEARCH

Masters by Research / 19  
Doctor of Philosophy (PhD) / 19





# CAMPUS SPACES



**DORRIT BLACK BUILDING** / Home to purpose-built design spaces, this building features a digital technical workshop along with studios for ceramics, glass, sculpture, printmaking, jewellery and metals, photography, painting and drawing.







**JEFFREY SMART BUILDING** / Featuring the very best in modern learning facilities, it boasts over \$8 million in new technologies and has a 5 Green Star Rating.

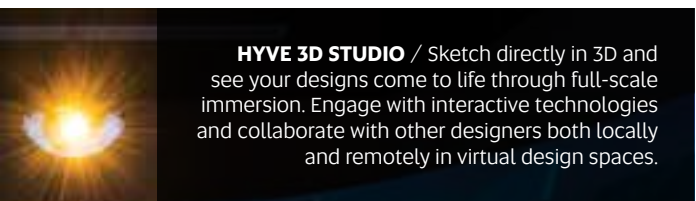

**HYVE 3D STUDIO** / Sketch directly in 3D and see your designs come to life through full-scale immersion. Engage with interactive technologies and collaborate with other designers both locally and remotely in virtual design spaces.



## New SPACES



**PRIDHAM HALL** / A \$50 million space that has transformed our campus blueprint in the city's west end; featuring a sports centre, lap pool, gym, dance/aerobics studio, function rooms, and facilities to seat 1800 students and their families for graduation ceremonies.

Discover the virtual fly-through at [unisa.edu.au/pridhamhall](http://unisa.edu.au/pridhamhall)



Image courtesy of Insight Visuals  
(photographer Chris Oaten)

**UNIVERSITY OF SOUTH AUSTRALIA CANCER RESEARCH INSTITUTE** / Located in SA's health and biomedical precinct in the Adelaide CBD, this \$247 million building is the new leading destination for health research and teaching.

See this world-class project at [unisa.edu.au/facilities/unisaCRI](http://unisa.edu.au/facilities/unisaCRI)



**MOD.** / This futuristic museum of discovery offers immersive experiences to the public through dynamic and changing exhibition programs across seven dedicated gallery spaces.

To find out more visit [unisa.edu.au/MOD](http://unisa.edu.au/MOD)

# Student PROJECTS

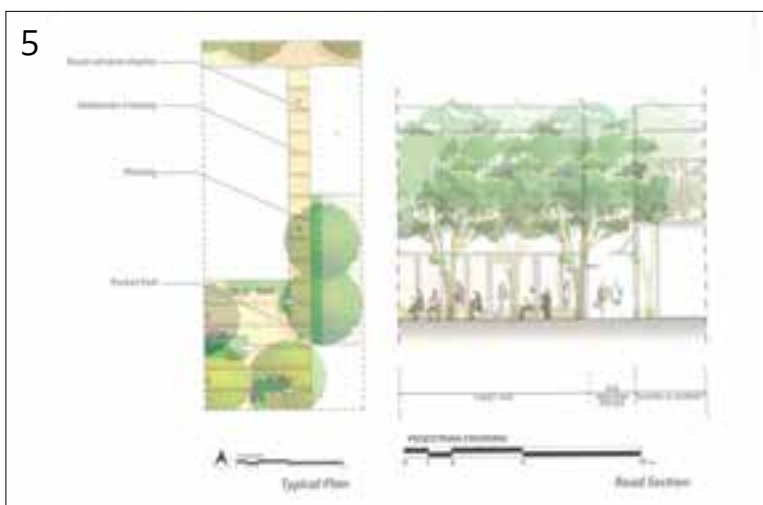
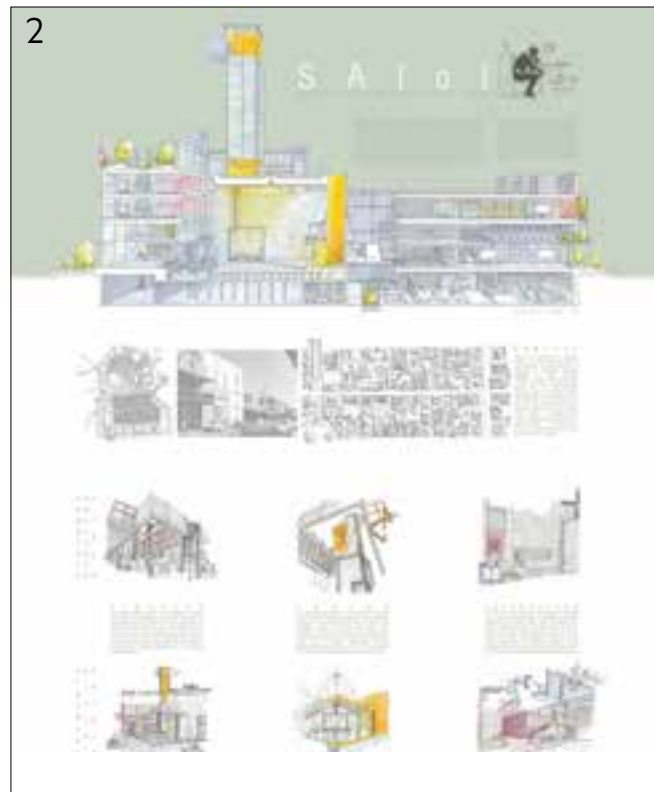



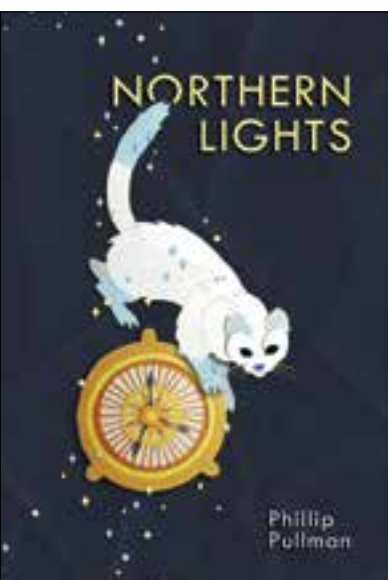
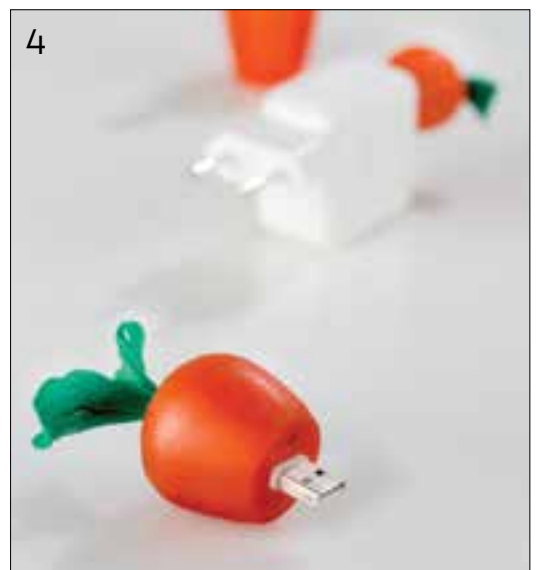

On the cover and left:  
Ainsley Hadden,  
Bachelor of Design  
(Communication Design),  
*Northern Lights*.

- 1 Daniel Synnott, Bachelor of Architectural Studies, *ARC Adelaide Recital Centre*.
- 2 Rupert Piccoli, Master of Architecture, *South Australian Institute of Ideas*.
- 3 Harriet Culbertson, Graduate Diploma in Design, *Context of Use*.
- 4 Kelly Carpenter, Bachelor of Design (Product Design).
- 5 Vicki Denisa, Master of Urban and Regional Planning.
- 6 Julie Tran, Bachelor of Interior Architecture, *Studio 8 (Atmospheres)*.
- 7 Glenda Kent, Bachelor of Visual Arts, *pate de verre – kiln formed glass*.
- 8 Chloe Grimes, Adam Lockier, Leigh Down, Olivia Hill, Bachelor of Design (Communication Design), Matchstudio: *Visualising Mental Health. Amitea*.



# UNDERGRADUATE

Your tertiary learning and career starts with undergraduate study.

## QUALIFICATIONS\*

- Bachelor: 3–4 years
- Bachelor (Honours): 4 years

*\*study times are approximate and based on a full-time study load.*

## FIND OUT MORE

For more information about all of the undergraduate degrees on offer and entry requirements visit:

[unisa.edu.au/study](http://unisa.edu.au/study)

Further details about studying with UniSA are also outlined on page 20 of this guide.

## HOW TO APPLY

Go online for all the information you need on applying to study at UniSA including SATAC requirements, admissions pathways, guaranteed entry scores, study credit and other commonly asked questions.

[unisa.edu.au/apply](http://unisa.edu.au/apply)

*Please note: The Selection Rank (ATAR) scores listed in the Entry information are indicative of the 2018 cut-offs.*

## Bachelor of ARCHITECTURAL STUDIES DBAE

ON-CAMPUS CW 3 PT H [unisa.edu.au/architecture](http://unisa.edu.au/architecture)

### ENTRY

SATAC code.....	424441
Selection Rank (ATAR).....	70.35
Guaranteed Entry:	
Selection Rank (ATAR).....	80
Selection Rank (VET).....	AdvDIP
Prerequisites.....	none
Assumed knowledge.....	none
Start date(s).....	February, July

Discover the fascinating world of design and the built environment.

Learn about traditional and digital technologies for prototyping and construction of complete buildings.

Engage in real industry projects through our award-winning Design Construct initiative – the longest running and largest practice-based program of its type in Australia.

Study in world-class, purpose-built facilities, including dedicated design studios and workshops.

### CAREER OPPORTUNITIES

Architect (with further study) /  
heritage consultant / project  
manager / urban designer

### IMPORTANT INFORMATION

This degree provides graduates with the competencies and knowledge required to apply for entry into the Master of Architecture (DMAE). Students must complete the master qualification plus two years of professional experience to be eligible for registration as an architect.

### PROFESSIONAL ACCREDITATION

This is a pre-professional program accredited by the Architects Board of South Australia. The program provides graduates with the necessary competencies and knowledge required to apply for entry into the Master of Architecture (DMAE). The masters program is accredited by the Architectural Practice Board of South Australia, endorsing the qualifications required for registration as an architect.

### ADMISSIONS PATHWAYS

Alternative entry options are available through the Foundation Studies program or Diploma in Arts offered by UniSA College.

### RELATED DEGREES

- Bachelor of Interior Architecture
- Bachelor of Urban and Regional Planning (Honours)
- Bachelor of Design (Product Design)
- Bachelor of Construction Management and Economics (Honours)

### FURTHER STUDY

- Bachelor of Art and Design (Honours) – one year
- Master of Architecture
- Master of Design (Sustainable Design)
- Master of Design (Design and Construct)

### PROGRAM STRUCTURE

#### FIRST YEAR

Design Studio 1 (Foundation)  
Design Construction Principles  
Design, Culture and Environment

Architectural Design Studio 2 (Dwelling)  
Architectural Documentation  
Architecture and Environment

#### SECOND YEAR

Architectural Design Studio 3 (Context)  
Design Communications (Digital)  
Architecture and Modernity

Architectural Design Studio 4  
(Communications)  
Design Construction Multistorey  
Advanced Design Media

#### THIRD YEAR

Architectural Design Studio 5  
(Construction)  
Architecture and Technology  
AAD Free Elective

Architectural Design Studio 6 (Integrated)  
Architecture and Ecology  
Contemporary Design Theory

## Bachelor of

# INTERIOR ARCHITECTURE DBIR

**ON-CAMPUS** **CW** **4** **PT** **H** [unisa.edu.au/architecture](https://unisa.edu.au/architecture)

### ENTRY

SATAC code.....	424081
Selection Rank (ATAR).....	65.1
Guaranteed Entry:	
Selection Rank (ATAR).....	75
Selection Rank (VET).....	DIP
Prerequisites.....	none
Assumed knowledge.....	none
Start date(s).....	February, July

Learn to create innovative and sustainable interior designs that have a positive and lasting impact.

Gain practical experience in interior design practice along with furniture design and placemaking.

Complete an industry placement and partner with a professional design mentor in your final year.

Participate in national and international study tours, competitions and exhibitions.

Study in world-class design and architecture studios located on campus.

### CAREER OPPORTUNITIES

Interior designer / event designer / furniture designer / project manager / design manager / lighting designer / design consultant

### IMPORTANT INFORMATION

This degree does not lead to registration as an accredited architect, nor to use the title of an 'architect'.

### PROFESSIONAL RECOGNITION

Graduates are eligible for Associate Membership with the Design Institute of Australia (DIA).

### ADMISSIONS PATHWAYS

Alternative entry options are available through the Foundation Studies program or Diploma in Arts offered by UniSA College.

### RELATED DEGREES

- Bachelor of Architectural Studies
- Bachelor of Design (Product Design)
- Bachelor of Design (Communication Design)
- Bachelor of Urban and Regional Planning (Honours)

### FURTHER STUDY

- Master of Design (Interior Architecture)
- Master of Design (Sustainable Design)
- Master of Design (Design and Construct)

### PROGRAM STRUCTURE

#### FIRST YEAR

Design Studio 1 (Foundation)  
Interior Architecture Construction 1  
Design, Culture and Environment

Interior Architecture Studies  
Interior Architecture Construction 2  
Interior Architecture Studio 2 (Materials and Practices)

#### SECOND YEAR

Digital Media  
Theory of the Modern Interior  
Interior Architecture Studio 3 (Multi Media)

Interior Detailing  
Multi Media Representation  
Interior Architecture Workplacement 1  
Interior Architecture Studio 4 (Detail)

#### THIRD YEAR

Interior Architecture Research Studies  
Professional Management  
Interior Architecture Studio 5 (Multidisciplinary)

Interior Technologies  
Art, Architecture and Design Elective 1  
Interior Architecture Workplacement 2  
Interior Architecture Studio 6 (Workplace Environments)

#### FOURTH YEAR

Interior Architecture Research Studies  
Advanced  
Free Elective  
Interior Architecture Studio 7: Atmospheres

Design Studio Research  
Art, Architecture and Design Elective 2  
Interior Architecture Studio 8: Advanced (Social Sustainability)

#### FOURTH YEAR (HONOURS)

AAD Research Methods  
AAD Research Practices  
AAD Honours Research Studies 1

AAD Honours Research Studies 2  
AAD Honours Research Studies 3



“

Chloe wanted to study a degree that allowed her to apply her creative energy in a practical way.

“The idea of being able to design spaces that everyone experiences and can enjoy, is so appealing. From creating an office that employees want to come to every day, to designing a restaurant that people can create memories in, the variety is endless.”

During her studies, Chloe travelled overseas and also gained practical experience through work placement opportunities.

“I studied an art course for three weeks in Rome. It was phenomenal and really impacted my view of design and my knowledge of the world. I also participated in three work placements, with the most recent one resulting in a job.”

”

Chloe Lorimer / BACHELOR OF INTERIOR ARCHITECTURE

## Bachelor of

# DESIGN (PRODUCT DESIGN) DBPR

**ON-CAMPUS**      [unisa.edu.au/design](http://unisa.edu.au/design)

## ENTRY

SATAC code.....	424551
Selection Rank (ATAR).....	60
Guaranteed Entry:	
Selection Rank (ATAR).....	70
Selection Rank (VET).....	DIP
Prerequisites.....	none
Assumed knowledge.....	none
Start date(s).....	February, June

Take the first step towards becoming an industrial designer, creating products people use every day.

Design electronics, tools, sports equipment, fashion accessories, appliances, new car concepts, toys, furniture and more.

Develop fundamental skills through design studio classes, model making and prototyping.

Learn from practising design professionals in world-class, custom-built workshops on campus.

Work with digital fabrication equipment such as laser cutters, CNC routers, 3D printers, and industry-standard motion-capture and virtual reality systems.

## CAREER OPPORTUNITIES

Industrial designer (with further study) / freelance designer / furniture designer / computer drafter / technical illustrator / product development coordinator

## PROFESSIONAL RECOGNITION

Graduates are eligible for Associate Membership with the Design Institute of Australia (DIA).

## ADMISSIONS PATHWAYS

Alternative entry options are available through the Foundation Studies program or Diploma in Arts offered by UniSA College.

## RELATED DEGREES

- Bachelor of Design (Communication Design)
- Bachelor of Design (Illustration and Animation)
- Bachelor of Interior Architecture

## FURTHER STUDY

- Bachelor of Art and Design (Honours) – one year
- Master of Design (Industrial Design)
- Master of Design (Sustainable Design)

## PROGRAM STRUCTURE

FIRST YEAR
Design Foundation Studio
Physical Prototyping Techniques for Product Design
Drawing for Product Design
Product Design Studio 2 (Principles)
Computer Graphics and Imaging for Design
Introduction to Computer Modelling for Product Design
SECOND YEAR
Product Design Studio 3 (Human Factors)
Low Volume Manufacturing for Product Design
Advanced Computer Modelling for Product Design
Product Design Studio 4 (Materials, Processes and Sustainability)
Human-Centred Design: Research and Analysis
Electronics (Theory and Techniques)
THIRD YEAR
Product Design Studio 5 (Usability)
High Volume Manufacturing for Product Design
Design, Culture and Society 2
Product Design Studio 6 (Manufacturing)
Art, Architecture and Design Elective
Free Elective

## Bachelor of

# DESIGN (ILLUSTRATION AND ANIMATION) DBIA

**ON-CAMPUS**      [unisa.edu.au/design](http://unisa.edu.au/design)

## ENTRY

SATAC code.....	424791
Selection Rank (ATAR).....	60.05
Guaranteed Entry:	
Selection Rank (ATAR).....	70
Selection Rank (VET).....	DIP
Prerequisites.....	none
Assumed knowledge.....	none
Start date(s).....	February, July

Study Australia's only degree in illustration and animation design.

Gain the technical and theoretical skills to become a visual storyteller.

Learn to produce industry-standard illustrations for industries such as book and graphic novel publishing, gaming, movies and advertising.

Develop your abilities in free-hand drawing and your knowledge of the latest digital software for moving and static pictures.

Access purpose-built workshops fitted out with state-of-the-art equipment.

Complete an internship, mentorship, collaborative project or free elective in your final year.

## CAREER OPPORTUNITIES

Animator / graphic designer / illustrator / technical illustrator

## PROFESSIONAL RECOGNITION

Graduates are eligible for Associate Membership with the Design Institute of Australia (DIA).

## ADMISSIONS PATHWAYS

Alternative entry options are available through the Foundation Studies program or Diploma in Arts offered by UniSA College.

## RELATED DEGREES

- Bachelor of Design (Communication Design)
- Bachelor of Media Arts
- Bachelor of Interior Architecture
- Bachelor of Contemporary Art

## FURTHER STUDY

- Bachelor of Art and Design (Honours) – one year
- Graduate Certificate in Compositing and Tracking
- Graduate Certificate in Dynamic Effects and Lighting
- Graduate Certificate in Film and Television
- Master of Design (Communication Design)

## PROGRAM STRUCTURE

FIRST YEAR
Illustration Animation Studio 1
Introductory Drawing for Design
Creative Thinking Methods
Illustration Animation Studio 2
Computer Graphics and Imaging for Design
Introduction to CGI
SECOND YEAR
Life Drawing
Design Language in Media Arts
Digital Compositing
Elective
Animation Design
Illustration Animation Studio 3
Character Performance
THIRD YEAR
Illustration Animation Studio 4
Dynamic Effects
Advanced Life Drawing
Visual Narrative
Integrated Studio Practice

NEW





“

Liam always had an eye for design and knew that he wanted to explore this further after high school.

During his university studies, Liam had the opportunity to travel overseas and create lasting industry connections in the exciting field of product design.

“I participated in a trip to China to take part in a university workshop and internships at a design consultancy and bicycle company. I also met with different manufacturers.

“My involvement with industry was incredible and gave me opportunities I wouldn’t have had any other way.”

Liam is now developing new software and hardware products that will transform how we teach STEM subjects in schools.

”

Liam Buggy / BACHELOR OF DESIGN  
(PRODUCT DESIGN)

Bachelor of

## DESIGN (COMMUNICATION DESIGN) DBVC

**ON-CAMPUS** **CW** **3** **PT** **H** [unisa.edu.au/design](http://unisa.edu.au/design)

### ENTRY

SATAC code.....424151  
Selection Rank (ATAR).....61.35  
Guaranteed Entry:  
Selection Rank (ATAR).....70  
Selection Rank (VET).....DIP  
Prerequisites.....none  
Assumed knowledge.....none  
Start date(s).....February, June

Learn to design visual communication that is intended to motivate, persuade and inform.

Complete projects for real clients and learn from established designers and academics.

Create new identities, messages and ideas through strategic thinking and design.

Examine, shape and transform meaning using image and typographic communication.

Work in state-of-the-art design studios located on campus.

### CAREER OPPORTUNITIES

Communication designer / graphic designer / brand consultant / exhibition designer / illustrator / typographer / web designer / animation and motion designer / art director

### PROFESSIONAL RECOGNITION

Graduates are eligible for Associate Membership with the Design Institute of Australia (DIA).

### ADMISSIONS PATHWAYS

Alternative entry options are available through the Foundation Studies program or Diploma in Arts offered by UniSA College.

### RELATED DEGREES

- Bachelor of Design (Illustration and Animation)
- Bachelor of Design (Product Design)
- Bachelor of Contemporary Art
- Bachelor of Media Arts
- Bachelor of Interior Architecture

### FURTHER STUDY

- Bachelor of Art and Design (Honours) – one year
- Master of Design (Communication Design)
- Master of Design (Sustainable Design)

### PROGRAM STRUCTURE

#### FIRST YEAR

Design Foundation Studio  
Introductory Drawing for Design  
Visual Argument and Design Culture

Communication Design Studio 1  
Design, Culture and Society 1  
Computer Graphics and Imaging for Design

#### SECOND YEAR

Communication Design Studio 2  
Design for Publication  
Design, Culture and Society 2

Communication Design Studio 3  
Typography: Design for Reading  
Design for Web

#### THIRD YEAR

Communication Design Studio 4  
Critical Design Practice  
Design Elective

Professional Practice Studio  
Advanced Design Elective  
Free Elective

Bachelor of

## CONTEMPORARY ART DBCX

**ON-CAMPUS** **CW** **3** **PT** [unisa.edu.au/contemporary-art](http://unisa.edu.au/contemporary-art)

NEW

### ENTRY

SATAC code.....424801  
Selection Rank (ATAR).....60.6  
Guaranteed Entry:  
Selection Rank (ATAR).....70  
Selection Rank (VET).....DIP  
Prerequisites.....none  
Assumed knowledge.....none  
Start date(s).....February, July

Study at one of Australia's oldest art schools with over 157 years' teaching experience, incorporating the former South Australian School of Art.

Develop your theoretical, technical and conceptual skills, and learn from national and international artists who are leaders in their field.

Explore your creativity, research skills and innovation through intensive studio practice in custom-built workshops located on campus.

Refine your craft by using the latest hybrid digital design practices and principles.

Tailor your studies to your interests through a broad range of elective courses.

### PROGRAM STRUCTURE

#### FIRST YEAR

Critical Literacies for Contemporary Art  
Reading Visual Culture 1  
Foundation: Creativity  
3D Contemporary Art Studio

The Studio Journal  
Reading Visual Culture 2  
Foundation: Principles of Perception  
2D Contemporary Art Studio

#### SECOND YEAR

Contemporary Art Practice  
Art and Australian Culture  
Core Studio Elective  
Contemporary Art Elective 1

Contemporary Art Research  
Art and Critical Thinking  
Core Studio Elective  
Contemporary Art Elective 2

#### THIRD YEAR

Contextualising Studio Practice  
Studio: Project A  
Contemporary Art Elective 3

Contemporary Art Career Development  
Studio: Project B  
University Elective

### CAREER OPPORTUNITIES

Ceramicist / arts administrator / sculptor / art critic / photographer / artist / jewellery and glass designer / printmaker / teacher (with further study)

### ADMISSIONS PATHWAYS

Alternative entry options are available through the Foundation Studies program or Diploma in Arts offered by UniSA College.

### RELATED DEGREES

- Bachelor of Design (Illustration and Animation)
- Bachelor of Design (Communication Design)
- Bachelor of Media Arts

### FURTHER STUDY

- Bachelor of Art and Design (Honours) – one year
- Master of Design (Contemporary Art)
- Master of Management (Arts and Cultural Management)
- Master of Teaching (Secondary)





“

Emma wanted to explore her artistic side through a degree in contemporary art.

“As I progressed further into my degree I gained great enjoyment from the really specialised subjects. Friendships formed with the fascinating people I met, helped to define each course, as well as the kind and inspiring tutors.

“Through my specialisation, I volunteered to assist glass artists at the JamFactory studios. I developed eye-opening skills and was exposed directly to industry.”

Emma is now completing a highly-competitive, two-year trainee program focusing on glass design at the JamFactory Contemporary Craft and Design.

”

Emma Young / BACHELOR OF VISUAL ARTS\*

*\*Now Bachelor of Contemporary Art (DBCX)*



# POSTGRADUATE

Take your career to the next level and develop further knowledge and skills through postgraduate study.

## QUALIFICATIONS\*

- Graduate Diploma: 1 year
- Master: 1–2 years

*\*study times are approximate and based on a full-time study load.*

## FIND OUT MORE

For more information about all of the postgraduate qualifications on offer and entry requirements visit:

[unisa.edu.au/study](http://unisa.edu.au/study)

Further details about studying with UniSA are also outlined on page 20 of this guide.

## HOW TO APPLY

Go online for all the information you need on applying to study at UniSA.

[unisa.edu.au/apply](http://unisa.edu.au/apply)

## Master of ARCHITECTURE DMAE

ON-CAMPUS CW 2 PT [unisa.edu.au/architecture](http://unisa.edu.au/architecture)

### ENTRY

SATAC code.....4CM012  
Fees.....CSP  
Start date(s).....February, July

Apply advanced knowledge in architecture and design to practice and research.

Learn from internationally-renowned and experienced teachers who are also practising architects.

Engage in real industry projects through our award-winning Design Construct initiative – the longest running and largest practice-based program of its type in Australia.

Study in award-winning, custom-designed facilities including dedicated design studios and workshops on campus.

Pursue specific areas of interest such as urban design, sustainability and digital environments through research and elective courses.

### CAREER OPPORTUNITIES

Architect / urban designer /  
heritage consultant / project  
manager

### PROFESSIONAL ACCREDITATION

This program is accredited by the Architectural Practice Board of South Australia, endorsing the qualification required for registration as an architect. Graduates are also eligible for membership with the Australian Institute of Architects.

### ENTRY REQUIREMENTS

Bachelor of Architectural Studies (DBAE) from the University of South Australia or a bachelor degree in a three-year pre-professional architecture program from a recognised Australian higher education institution or equivalent qualification.

Applicants with a bachelor degree in a three-year pre-professional architecture program from a non-Australian higher education institution must also submit a portfolio as part of their application.

*Note: Entry into this program is competitive, based on academic merit and subject to quota. Furthermore, the University may admit other applicants who provide satisfactory evidence of academic achievement, which we recognise as an equivalent qualification to a completed Bachelor of Architectural Studies (DBAE).*

### RELATED DEGREES

- Graduate Diploma in Design
- Master of Design (Interior Architecture)
- Master of Design (Design and Construct)
- Master of Design (Sustainable Design)

### PROGRAM STRUCTURE

#### FIRST YEAR

Architectural Design Studio 7  
(Environment)  
AAD Research Methods  
Theories and History of Architecture  
Architectural Design Studio 8  
(Construction)  
AAD Research Practices  
Elective

#### SECOND YEAR

Architectural Design Studio 9  
Architectural Practice Professional  
Elective  
Architectural Design Studio 10  
Architectural Practice Management  
Elective

Master of

## URBAN AND REGIONAL PLANNING DMUR

### NESTED WITH

- Graduate Diploma in Urban and Regional Planning (DGUR)

**ON-CAMPUS** **CW** **2** **PT** [unisa.edu.au/urbanplanning](https://unisa.edu.au/urbanplanning)

### ENTRY

SATAC code .....(Master) 4CMOO4  
 .....(GradDip) 4GDOO2  
 Fees ..... CSP  
 Start date(s) ..... February, July

Study the promotion and development of sustainable cities.

Learn about urban design, social policy and planning, and urban transportation planning.

Gain practical experience through work placements and international field trips.

Develop advanced knowledge in research methodologies and their applications in the fields of architecture, art and design.

Benefit from over 60 years' experience in providing world-class planning education.

### CAREER OPPORTUNITIES

Urban and regional planner / environmental planner / urban designer / town planner / urban data analyst / city planner / urban sustainability planner / natural resource manager / traffic and transport planner

### PROFESSIONAL ACCREDITATION

This program is accredited by the Planning Institute of Australia (PIA). Graduates are eligible to apply for Corporate Membership with PIA and undertake training to gain status as a Professional Certified Planner. Graduates will be required to undertake continuing professional development, which is also offered by PIA.

### ENTRY REQUIREMENTS

- Bachelor degree in any discipline from a recognised higher education institution; or
- Graduate Diploma in Urban and Regional Planning (DGUR) from the University of South Australia.

### PROGRAM STRUCTURE

#### FIRST YEAR

Introduction to Regional and Urban Planning  
 AAD Research Methods  
 Elective 1  
 Elective 2

Social Planning and Community Issues  
 Transport and Planning  
 Sustainable Urban Design 1  
 Elective 3

#### SECOND YEAR

Contemporary Planning Theory  
 Transport Policy  
 Planning Research Project 1N  
 Sustainable Urban Design 2

Planning Research Project 2N  
 Environmental Impact Assessment N  
 Elective 4  
 Elective 5



“

Putu's fascination with the future of urban settlements led him to postgraduate studies in urban and regional planning.

“There are more and more people living in urban areas and I am interested in how these cities are coping with the influxes while still maintaining an acceptable level of environmental quality.

“I participated in UniSA's Vietnam Planning Study Tour, which gave me valuable experience working and collaborating with cross-disciplinary students and an insight into planning in a developing country. We worked on real-life issues relating to the management of the Imperial City – Hue Citadel.”

Putu's global experience has given him a competitive edge as he embarks on a career making positive changes to international cities and regions.

”

Putu Kusuma / MASTER OF URBAN AND REGIONAL PLANNING



## Master of DESIGN DMSP

### NESTED WITH

- Graduate Diploma in Design (DGSP)

### SPECIALISATIONS

- Communication Design
- Contemporary Art
- Design and Construct
- Industrial Design
- Interior Architecture
- Sustainable Design

**ON-CAMPUS**  **2**  [unisa.edu.au/design](http://unisa.edu.au/design)

### ENTRY

SATAC code .....(Master) 4CM131  
.....(GradDip) 4GD102  
Fees .....CSP  
Start date(s) .....February, July

Advance your skills to become a creative and professional designer and entrepreneur.

Develop practical experience by working on real-life transdisciplinary projects and completing an industry placement during your studies.

Benefit from industry masterclasses and learn from national and international design practitioners.

Learn in state-of-the-art workshops and studios on campus.

Tailor your studies with a specialisation that suits your interests and career goals.

### SPECIALISATIONS

#### COMMUNICATION DESIGN

Learn to identify and propose solutions for complex communication design challenges. Develop an advanced body of knowledge in the principles and practices of communication design that extend beyond the visual for a variety of changing socio-cultural, economic and environmental contexts.

#### CONTEMPORARY ART

Develop skills in your chosen craft through advanced studio practice coupled with studies in marketing and business. Specialised fields include: photo, digital and graphic media; curatorship and arts writing; painting and drawing; and spatial studies involving public art, sculpture, textiles, glass, ceramics, jewellery and metal.

### DESIGN AND CONSTRUCT

Apply key design principles and concepts to various stages of a building project, from its conceptualisation and documentation through to construction. Develop the skills to critically review and analyse design and construction processes, consolidate information, and provide solutions for multifaceted real-world projects.

### INDUSTRIAL DESIGN

Take a leading role in the innovative humanisation of technology including the development of physical products, systems, interfaces and environments. Gain a deeper knowledge of materials and processing technologies used in manufacturing, along with technical skills in digital prototyping for the simulation, development and communication of three-dimensional design.

### INTERIOR ARCHITECTURE

Develop advanced knowledge in order to design socially and environmentally responsive interior spaces. Critically identify, review, analyse and propose solutions to address challenges through various stages of a project, from conceptual design to production. Apply both interior design practice and broader design principles to innovative spacial designs.

### SUSTAINABLE DESIGN

Focus on the principles and practices required for a sustainable approach to design that can be applied to a range of complex information systems, challenges, concepts and theories. Learn technical and communication skills to design, evaluate, implement and analyse developments that contribute to sustainable design in a global context.

### CAREER OPPORTUNITIES

Depending on your specialisation, your career options can include:

Graphic designer / design consultant / interior designer / digital media designer / design studio manager / advertising executive / sustainable design consultant / industrial designer / arts administrator / art historian / art and design critic / artist / project manager

### PROFESSIONAL RECOGNITION

Graduates are eligible for Associate Membership with the Design Institute of Australia (DIA), and Professional Membership after five years of relevant professional experience.

### ENTRY REQUIREMENTS

Bachelor degree from a recognised higher education institution or equivalent qualification in a related discipline along with a portfolio of work, curriculum vitae and written statement of intent.

Applicants who have completed a Graduate Diploma in Design (DGSP) from the University of South Australia are eligible to enter and are not required to submit a portfolio of work and statement of intent.

Some applicants may be eligible for Advanced Standing and can complete the program in one year full-time study or equivalent part-time study.

### PROGRAM STRUCTURE

#### INDICATIVE OF COMMUNICATION DESIGN

##### FIRST YEAR

Research Studio 1  
AAD Research Methods  
Elective

Research Studio 2  
Elective  
Elective

##### SECOND YEAR

Research Studio 3  
Masters Research Project 1  
Masters Elective

Research Studio 4  
Masters Research Project 2  
Masters Elective

# RESEARCH

Make a lasting contribution to your field through a research degree.

## QUALIFICATIONS\*

- Masters by Research: 2 years^
- Doctor of Philosophy (PhD): 4 years^

*\*study times are approximate and based on a full-time study load.*

*^in total including examination time. Candidates must be prepared to submit 6-12 months prior to official completion of their program.*

## FIND OUT MORE

[unisa.edu.au/resdegrees](http://unisa.edu.au/resdegrees)

## ENTRY REQUIREMENTS

[unisa.edu.au/resdegrees-eligibility](http://unisa.edu.au/resdegrees-eligibility)

## HOW TO APPLY

[unisa.edu.au/apply](http://unisa.edu.au/apply)

Masters by

**RESEARCH** MMRD

Doctor of

**PHILOSOPHY (PhD)** MPHd

**DIVISION OF EDUCATION, ARTS AND SOCIAL SCIENCES**

**SCHOOL OF ART, ARCHITECTURE  
AND DESIGN**

Thrive in a vibrant postgraduate culture at the forefront of creativity and innovation.

Develop new knowledge to meet current art and design challenges and to spark new ways of thinking and producing.

Be inspired by visiting scholars and artists who are leaders in their field.

Engage in thought-provoking symposiums, work-in-progress seminars and studio critiques.

Work under the guidance of experienced and highly qualified research supervisors.

Benefit from national and international research links that will help inform your studies.

### ALTERNATIVE ENTRY

Other postgraduate and undergraduate degrees may be considered for admission into the Masters by Research or Doctor of Philosophy (PhD) with demonstration of research capabilities via assessment of relevant quality publications and professional experience.

*Note: Eligibility for entry into a research program is also subject to an assessment of the proposed research, supervisor availability, and any school or research-specific eligibility requirements.*

### DISCIPLINE AREAS

- Architecture
- Contemporary Art
- Design
- Planning

### ENTRY REQUIREMENTS

#### MASTERS BY RESEARCH:

- Bachelor degree of at least three years with a minimum credit average in a relevant discipline; or
- No tertiary qualifications (some discipline areas only) with demonstration of research capabilities via assessment of relevant quality publications and professional experience.

#### DOCTOR OF PHILOSOPHY (PhD):

- Honours 1, Honours 2A or an appropriate master degree or equivalent.



# STUDY AT UniSA – THE BASICS

## Minimum entry requirements for undergraduate bachelor and associate degrees

### APPLYING WITH YEAR 12

Applicants are required to have successfully completed the South Australian Certificate of Education (SACE) with:

- a competitive Selection Rank (ATAR); AND
- the fulfilment of the program's prerequisite requirements (where applicable).

Applicants may also be eligible to compete for entry if they have completed the program's prerequisite requirements and have completed one of the following:

- an interstate or overseas qualification considered by the University as equivalent to SACE; or
- the International Baccalaureate Diploma with a minimum score of 24 points.

### ADJUSTMENT FACTORS

Universities in South Australia include ATAR-related adjustment factors (previously known as bonus points) to Australian high school students applying for entry into university via the following schemes:

- **The Universities Equity Scheme** – provides additional points for students coming from specified schools, as well as individuals experiencing disadvantage.
- **The Universities Language, Literacy and Mathematics Adjustment Scheme** – provides additional points for students who successfully complete a language other than English, or specified English and Mathematics subjects.

Need some help? Visit [unisa.edu.au/adjustmentfactors](http://unisa.edu.au/adjustmentfactors) or contact Future Student Enquiries on (08) 8302 2376 or submit an enquiry via [unisa.edu.au/enquire](http://unisa.edu.au/enquire)

### GUARANTEED ENTRY

UniSA offers guaranteed entry into many programs for domestic Year 12 and VET students. If your Selection Rank (ATAR) or VET award meets the UniSA Guaranteed Entry score for that program, you have met the prerequisites and any other program specific entry requirements, and you have listed the program as your first preference, you are in. It's guaranteed.

[unisa.edu.au/guaranteed](http://unisa.edu.au/guaranteed)

### ADMISSIONS PATHWAYS

Entering your chosen program straight from high school is not the only pathway into UniSA. Applicants may also meet the minimum requirements to apply for entry (via competitive selection) through one of the following pathways.

**Higher Education Study** – completion of at least half a year of full-time equivalent study, at UniSA or a recognised higher education institution. You can apply using your Grade Point Average (GPA).

**Higher Education Diploma** – completion of a higher education diploma, from the UniSA College (applicable programs listed on each bachelor program in this guide), the South Australian Institute of Business and Technology (SAIBT), or another recognised higher education institution.

**Special Entry** – a competitive Special Tertiary Admissions Test (STAT) score. A personal competencies statement or employment experience may also be considered for some programs.

**Vocational Education Training (VET)** – applicants may be eligible for entry with the completion of an award from TAFE or another Registered Training Organisation at AQF Certificate IV or above.

**UniSA College** – there are a variety of pathway options offered through UniSA College including diplomas and the Foundation Studies program.

**Alternative Pathways** – there are a range of alternative pathways including bridging qualifications offered through SAIBT and Eynesbury.

**Open Universities Australia** – completion of at least four Open Universities Australia (OUA) courses at an undergraduate level or higher.

[unisa.edu.au/pathways](http://unisa.edu.au/pathways)

### BEFORE APPLYING

All applicants should check and ensure that they meet all entry and prerequisite requirements before applying. For more information on entry requirements, visit:

[unisa.edu.au/study](http://unisa.edu.au/study)

### SUPPORT SERVICES

UniSA offers services to assist rural and/or socio-economically disadvantaged students, Aboriginal and Torres Strait Islander people, and people with a disability. For more information, contact (08) 8302 2376 or visit:

[unisa.edu.au/studentsservices](http://unisa.edu.au/studentsservices)

### SCHOLARSHIPS

UniSA offers a range of scholarships and grants to support students from all walks of life. Each year, 2500 students benefit from scholarships at UniSA, providing financial assistance as well as valuable work experience, mentoring opportunities and even overseas travel. For more information and to check the eligibility criteria, visit:

[unisa.edu.au/scholarships](http://unisa.edu.au/scholarships)

### HOW TO APPLY TO THE UNIVERSITY OF SOUTH AUSTRALIA

Applications to most programs at UniSA are administered through the South Australian Tertiary Admission Centre (SATAC). For more information visit:

[unisa.edu.au/apply](http://unisa.edu.au/apply)

### FEES

All domestic undergraduate students at the University of South Australia are in Commonwealth-supported places. Students in these places pay a contribution of their fees depending on the program chosen and the contribution band in which those courses are classified (see table below). The amount of your student contribution also depends on the unit value of your courses of study.

As per the Australian Government guidelines, the student contribution amounts for 2018 are:

BAND	AREA OF STUDY	STUDENT CONTRIBUTION <i>For one year of full-time load (1 EFTSL)</i>
1	Humanities, behavioural science, social studies, foreign languages, visual and performing arts, clinical psychology, nursing and education	\$6,444
2	Computing, built environment, health, engineering, surveying, agriculture, Mathematics, statistics, science	\$9,185
3	Law, dentistry, medicine, veterinary science, accounting, administration, economics, commerce	\$10,754

Some postgraduate programs are also Commonwealth-supported (or CSP), while others are full fee-paying (the fees for these are listed on each applicable program in this guide and are based on an equivalent full-time student load). For more information on fees including eligibility for Commonwealth-supported places, deferring your student contribution through HECS-HELP, FEE-HELP loans, or fee information relating to international students please visit:

[unisa.edu.au/fees](http://unisa.edu.au/fees)



## INDUSTRY *insight*

“UniSA graduates have practical all-round professional skills, display good work ethic, and show initiative and a willingness to learn. My advice is to get as much work experience in your studies as possible, develop a relationship with a professional mentor and travel widely to broaden the mind.”

Tony Materne / PARTNER /  
MPH ARCHITECTS

## Stay in touch

*Sign up to receive updates directly to your inbox and keep up to date with the latest information including:*

Invitations to career events and information sessions / competition alerts / insights into life on campus from students and teachers / updates on new degrees / scholarship opportunities / breaking industry and career news

[unisa.edu.au/stayintouch](http://unisa.edu.au/stayintouch)



### **Acknowledgement of Country**

UniSA respects the Kaurna, Boandik and Barngarla peoples' spiritual relationship with their country. We also acknowledge the diversity of Aboriginal peoples, past and present.

Find out more about the University's commitment to reconciliation at [unisa.edu.au/RAP](http://unisa.edu.au/RAP)

# 2018 EVENTS

Our events give you the opportunity to ask questions about different degrees and careers, take a tour around campus, attend presentations, and talk to current staff and students.

## **UniSA OPEN DAY**

Sunday 12 August / 9:00am–4:30pm / City West Campus and City East Campus

## **CAMPUS DAYS**

### **Magill@Twilight**

Wednesday 29 August / 4:00pm–8:00pm / Magill Campus

### **Mawson Lakes Campus Day**

Tuesday 28 August / 4:00pm–7:30pm / Mawson Lakes Campus

### **Mount Gambier Open Day**

Sunday 5 August / 11:00am–4:00pm / Mount Gambier Campus

### **Whyalla Open Day**

Sunday 26 August / 11:00am–3:00pm / Whyalla Campus

[unisa.edu.au/openday](http://unisa.edu.au/openday)





**University of  
South Australia**

***unisa.edu.au***

Telephone: (08) 8302 2376

Make an enquiry: *unisa.edu.au/enquire*



***youtube.com/unisouthaustralia***



***facebook.com/UniSA***



***twitter.com/UniversitySA***



***instagram.com/universitysa***

The information provided in this publication is for general information only, and the University of South Australia makes no representation about the content, suitability, accuracy or completeness of this information for any purpose. It is provided "as is" without express or implied warranty.

Information correct at time of printing (March 2018)

CRICOS provider number OO121B

For information specific to international students, please visit *unisa.edu.au/international*

***Australia's University of Enterprise***