



University of
South Australia

INVESTING IN EXCELLENCE

CITY EAST AND WEST CAMPUS MASTERPLANS
AND MAWSON LAKES DEVELOPMENTS



Front cover at left: The proposed new look for City East's Bonython Jubilee forecourt and (right) City West's new \$95 million Learning Centre which will combine informal learning spaces, active teaching spaces, meeting rooms and experiential teaching areas.

OUR HORIZON 2020 AMBITION

In *Horizon 2020*, our ambitious strategic plan for the next decade, the University of South Australia has committed itself to being defined by its:

- outstanding learning outcomes and the quality and richness of the student experience
- graduates' readiness for work, their adaptability and their contribution as global citizens
- commitment to equity and excellence, reinforcing each other in an environment characterised by uncompromising high standards
- strong nexus between teaching and research
- world-class research clusters and exciting, research-intensive culture
- innovative solutions to social, economic, political and technological challenges
- considerable and creative contribution to the prosperity and wellbeing of the nation
- agility and adaptability in building and maintaining productive partnerships with industry, business and the community
- high-performing staff and prestigious national and international partners
- enduring and mutually beneficial relationships with its global alumni
- strong sense of collective purpose.

To achieve this vision, we recognise that we must create the very best teaching, learning, research and social spaces and facilities across our campuses.

We are also committed to ensuring our campuses contribute to the quality of the urban landscape of metropolitan Adelaide and South Australia.

This brochure describes the proposed Masterplans for our City West and City East campuses and current developments at our Mawson Lakes campus.



PAGES 2-7

City West will change the west end of the city completely. The heart of the University's City West campus will emphasise its links to a revitalised Hindley Street as well as to North Terrace.



PAGES 8-11

City East will be reoriented around green public spaces focused on a new Frome Road plaza.



PAGE 12-13

Mawson Lakes is a vision for the future with buildings that break new ground in student experiences, state-of-the-art research facilities, and environmental sustainability.

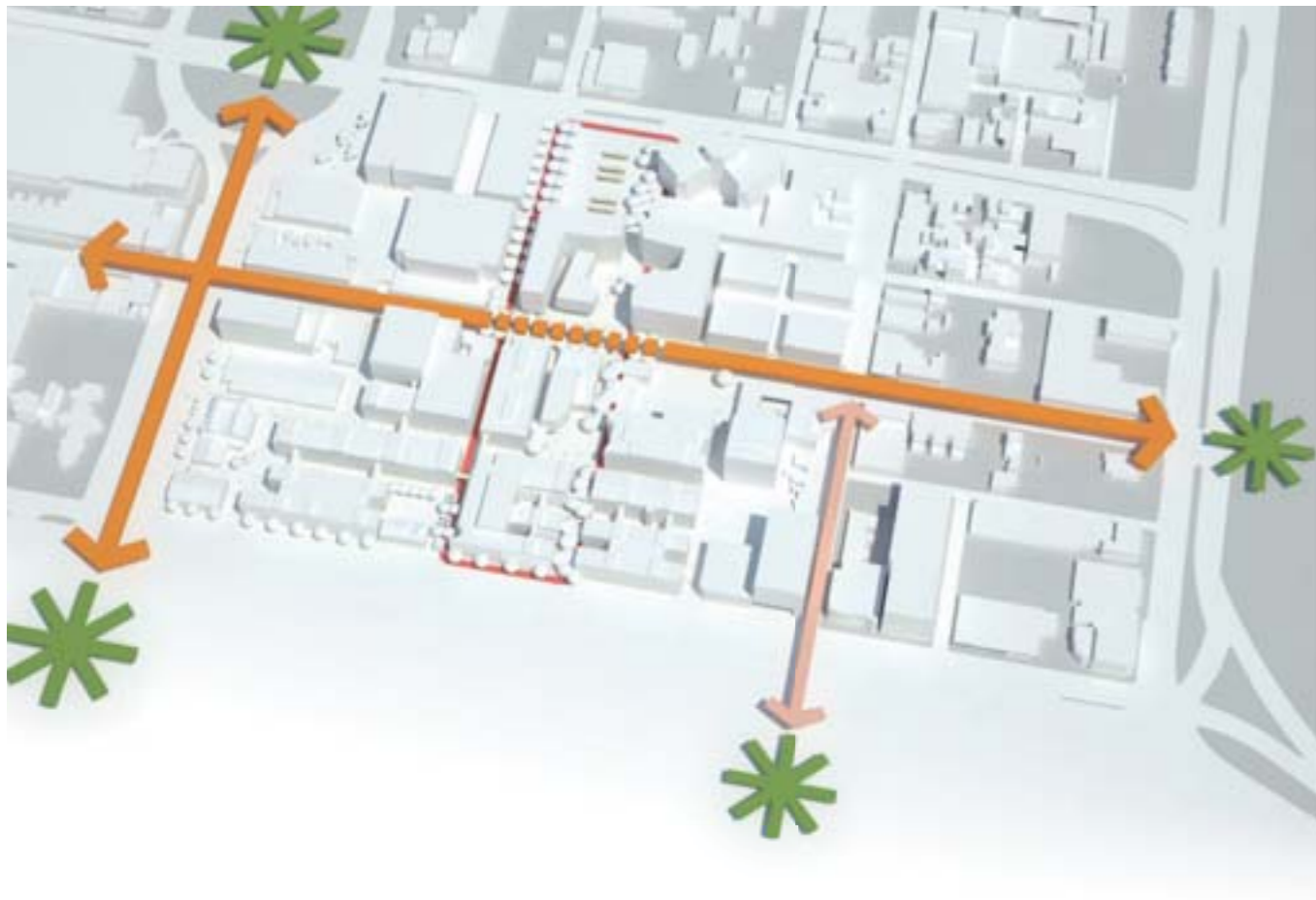

THE NEW CITY WEST

The City West campus Masterplan 2020 presents a proposed vision for the future where the campus nurtures and expresses a cohesive and creative knowledge community, reaching out to the public through its network of open spaces and laneways, to engage with and address the challenges of the future.

The proposed Masterplan aims to develop the campus as a feature within the West End precinct, linking North Terrace, Hindley Street and Currie Street, as well as Morphett Street and West Terrace.

A brand new, world-class, \$95 million Learning Centre that engages students with active learning spaces, world-leading knowledge and professional practice will be the heart of the City West campus. The Learning Centre, and the creation of a strong identity of form, function, art and creativity in the surrounding areas, will ensure the City West campus of the University of South Australia also becomes the permanent creative and cultural heart of the City of Adelaide's west.



The Learning Centre will also house the University library, information technology services, the Learning and Teaching Unit, Campus Central and Security.



The new Learning Centre at City West will provide a new level of student experience at UniSA. It will feature a mix of student spaces such as active and reflective learning areas, dedicated places for research and Honours students as well as social spaces.



An artist's impression looking west across Hindley Street towards the Kaurua and Law buildings.



The northern edge of City West campus with new North Terrace frontage.



A strong green statement will turn George Street into a popular pedestrian link between North Terrace and Hindley Street.



Laneways and discrete spaces will become important elements such as this artist's impression looking west between the Catherine Helen Spence and the Barbara Hanrahan buildings.





THE NEW CITY EAST

UniSA offers a unique urban experience for students and the proposed plans for a reinvigorated City East campus will go the next step towards integrating the University with the wider community. The North Terrace/Frome Road address will be revitalised with new buildings, terraces and open spaces along Frome Road which will become the new focus of UniSA's health precinct.

The plans propose that the City East campus will reinforce UniSA's green credentials and will feature new plantings, lighting and outdoor seating. Frome Road will become a more pedestrian-friendly boulevard and, with the upgrade of the Reid Common into a spectacular green space, the Reid Building, home to the University's Sansom Institute, will finally be integrated with the main campus.



The Frome Road plaza will become a popular student gathering space at the City East campus.



Centenary Plaza at City East will become a link intersecting the pedestrian corridor that crosses the campus at Level 3.



The Reid Common will become an important element in the functioning and image of the City East campus.

MAWSON LAKES

World-leading science and engineering research and knowledge transfer is at the heart of the design of the new M2 (Minerals and Materials) building at UniSA's Mawson Lakes campus. The building is intended to be a catalyst for innovative learning and teaching and high quality research in the materials and minerals science and engineering hub at the campus, north of the city.

The building features a large theatre setting for optimum engagement of large groups of researchers and a range of spaces where industry representatives and researchers can come together in small collaborative settings. The building is on target to achieve a 5-Star Design Rating under the Greenstar Education Tool with its layout, orientation, façade treatment, material selection and building services design all contributing to a dramatically reduced carbon emission.

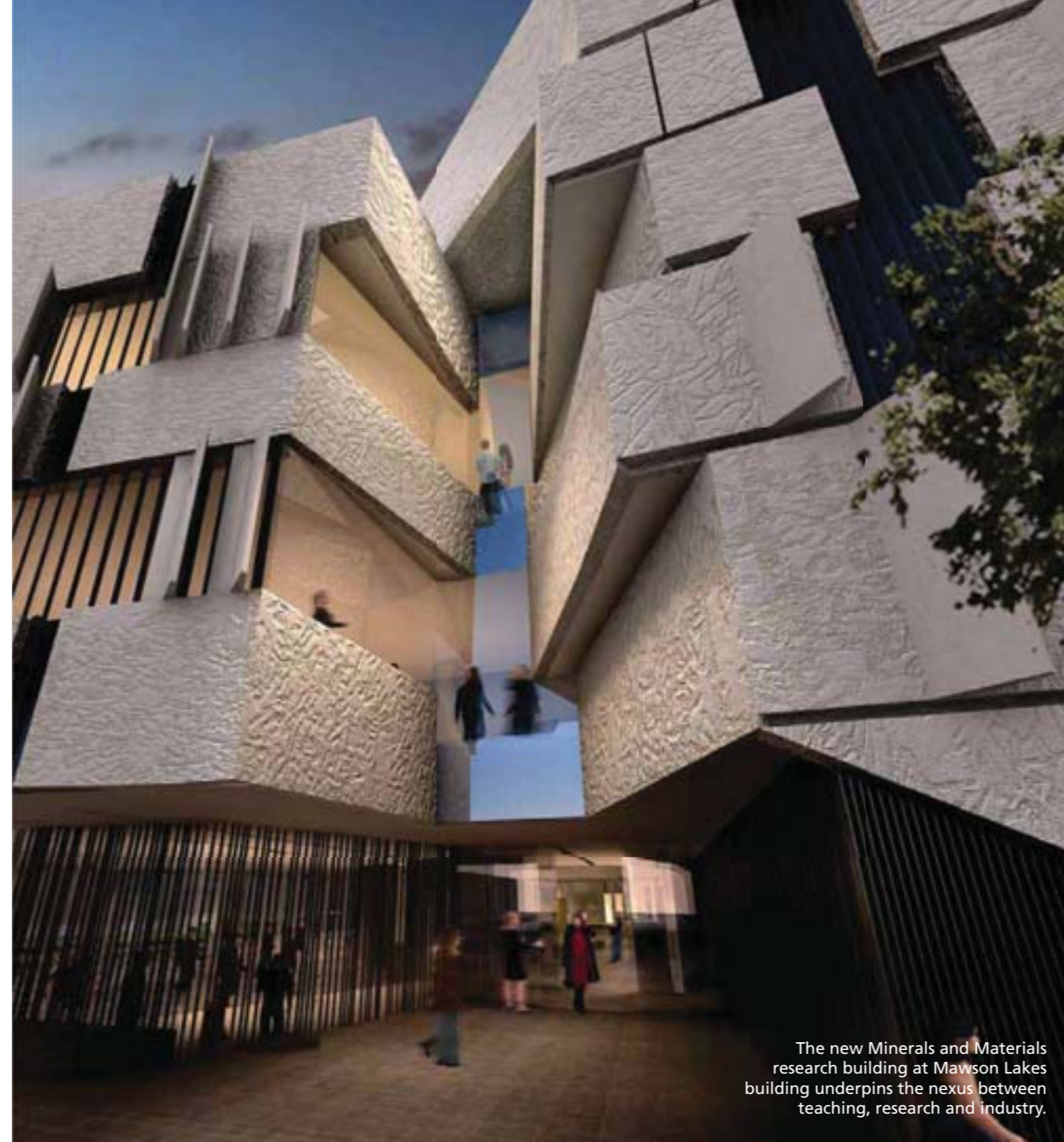

The new Minerals and Materials research building at Mawson Lakes building underpins the nexus between teaching, research and industry.



The Minerals and Materials science research and learning hub will accommodate academic staff and the research students representing both the Mawson Institute and The Ian Wark Research Institute. It will also include an experiential learning studio for use by Honours level students.

The City West campus is home to

The Division of Business

The Division of Education, Arts and Social Sciences

Research Institutes at City West:

The Ehrenberg-Bass Institute for Marketing Science

The Hawke Research Institute.

The City East campus is home to

The Division of Health Sciences

Research Institute at City East:

The Sansom Institute.

The Mawson Lakes campus is home to

The Division of Information Technology, Engineering and the Environment

The Division of Education, Arts and Social Sciences

Research Institutes at Mawson Lakes:

The Ian Wark Institute

The Institute for Telecommunications Research

The Mawson Institute

The Defence and Systems Institute

Barbara Hardy Institute for Sustainable Urban Environments.

The Magill campus is home to

The Division of Education, Arts and Social Sciences

University of South Australia

GPO Box 2471

Adelaide

South Australia 5001

Australia

Email: enquiries@unisa.edu.au

Telephone: +61 8 8302 6611

Facsimile: +61 8 8302 2466

unisa.edu.au/horizon2020

CRICOS Provider Number: 00121B

September 2011

Acknowledgements:

The University of South Australia would like to acknowledge HASSELL for the provision of images for the City East and West Masterplans; John Wardle Architects and Swanbury Penglase Architects for images of Mawson Lakes Developments; and John Wardle Architects in association with Phillips Pilkington Architects for images of the City West Learning Centre.



**University of
South Australia**