



University of
South Australia

POST GRADUATE

2019 PROGRAMS | INTERNATIONAL STUDENTS





BE

DO

DO

FIVE STARS IN

Research / Employability /
Teaching / Facilities /
Internationalisation /
Social Responsibility /
Innovation

2018 QS Stars Ratings



OVERALL FIVE-STAR RATING

2018 QS Stars Ratings

To be the best in
your field, you need a
university that offers
a choice of over 200
world-class degrees,
and is globally
recognised for its
teaching, research
and facilities.

4 ACADEMIC DIVISIONS

UniSA BUSINESS SCHOOL
EDUCATION, ARTS AND
SOCIAL SCIENCES
HEALTH SCIENCES
INFORMATION TECHNOLOGY,
ENGINEERING AND
THE ENVIRONMENT

4 LEADING RESEARCH FLAGSHIPS

EHRENBERG-BASS INSTITUTE
FOR MARKETING SCIENCE
FUTURE INDUSTRIES
INSTITUTE
SANSOM INSTITUTE
FOR HEALTH RESEARCH
CENTRE FOR CANCER BIOLOGY

4 METROPOLITAN CAMPUSES

CITY EAST
CITY WEST
MAGILL
MAWSON LAKES

2 REGIONAL CAMPUSES

MOUNT GAMBIER
WHYALLA

78

STUDENT
EXCHANGE
PARTNER
INSTITUTIONS

5721

TOTAL NUMBER OF
INTERNATIONAL
STUDENTS

2016 figures

2492*

STAFF
POPULATION

*Full-time equivalent

31,930

TOTAL NUMBER OF
STUDENTS

202,934

ALUMNI

TOP 10

IN AUSTRALIA

Ranked 9th – 2017 *THE* World University Rankings

97% OF OUR ASSESSED RESEARCH

RATED AT OR ABOVE WORLD STANDARD

2015 Excellence in Research
for Australia (ERA)

RANKED IN THE TOP 50 UNDER 50

FOR BOTH *QS* AND *THE* WORLD RANKINGS

Ranked 26 in *QS* Top 50
Universities Aged Under 50 2017
Ranked 32 in *THE* World Top
200 Young Universities 2017

RANKED 2ND IN AUSTRALIA

FOR STUDENT SERVICES

International Student Barometer
2017 – Campus Central Services

RANKED IN THE TOP 5 INSTITUTIONS IN AUSTRALIA

FOR TEACHING INTERNATIONAL OUTLOOK RESEARCH INDUSTRY INCOME

2017 *THE* Top 200 Under 50

I am delighted that you are thinking of studying at the University of South Australia. We are, after all, considered one of the world's best young universities by ratings agencies such as Times Higher Education and Quacarelli Symonds.



Professor David G. Lloyd

VICE CHANCELLOR AND PRESIDENT

We are also one of the world's most international universities, as recognised by Quacarelli Symonds (QS). We have Australia's most internationally-diverse academic staff population and have always given a warm welcome to international students, graduating people from more than 140 countries throughout our history.

If you decide to study with us you'll find that the University of South Australia is innovative and creative, and focused on educating the next wave of global professionals. Our degrees are designed with strong professional emphasis and in partnership with industry. Our research is focused on finding answers to the world's most pressing problems.

We are also a globally engaged institution with a network of international partners which include XAUAT, Shandong, Tianjin and Beijing Normal Universities in China, Keio University in Japan, Trinity College in Ireland, University College London, and numerous collaborations with universities elsewhere in Europe and North America.

If you decide that the University of South Australia is the right place for you, we will help you prepare for the career path of your choice.

I hope that you do consider coming to Adelaide to study with us and I look forward to seeing you on campus soon.

Welcome to the University of South Australia.



| |
|-----------------------------|
| About us/6 |
| An enterprising spirit/8 |
| Your journey begins here/10 |
| Discover Adelaide/12 |
| Our campuses/18 |
| New spaces/22 |
| Getting to campus/24 |
| Your study experience/26 |
| Research degrees/28 |
| Supporting you/30 |
| Accommodation options/32 |

| |
|---------------------------------------|
| Get started: postgraduate programs/36 |
|---------------------------------------|

Business and Law

| |
|-----------------------------|
| UniSA Business School/36–42 |
|-----------------------------|

Education, Arts and Social Sciences

| |
|--|
| Art, Architecture and Design/43–45 |
| Media Arts/46–47 |
| Education/48–51 |
| Psychology, Social Work and Human Services/52 |

Health and Medical Sciences

| |
|-----------------------------------|
| Health and Medical Sciences/53–55 |
|-----------------------------------|

IT, Engineering, and the Environment

| |
|--|
| Data and Information Management/56–59 |
| Engineering/59–61 |
| Science and Built Environments/62–63 |

| |
|-------------------------------------|
| How to apply/64 |
| Offshore programs/70 |
| How to become a research student/71 |

*Images on pages 12–17 courtesy of the
South Australian Tourism Commission
and the City of Holdfast Bay.*

About US



The University of South Australia was formed in 1991 through a collection of colleges, institutes and schools coming together to become a single university.

Today, we have graduated more than 160,000 students and are ranked in the top 10 universities in Australia.*

Our teaching is industry-informed and highly practical. You will learn from top ranking teachers and work on real-world issues to ensure you are career ready. We partner with more than 2,500 companies worldwide to bring our students valuable placement, project, research and work opportunities.



Pridham Hall is part of a major expansion of UniSA in Adelaide's West End.

▶ Check out the virtual fly through at unisa.edu.au/PridhamHall

The University has developed an enviable research profile, engaging with more than 500 international collaborations across 45 countries. We are focused on making a difference in areas as diverse as cancer treatments, renewable energy, cybersecurity and social innovation.

We have invested heavily in new buildings and facilities totalling over \$400 million to expand our campus blueprint.

Our students have access to world-class learning spaces and the latest technologies, along with enhanced research facilities and facilities that further collaborate and connect with the community and industry.

We also actively contribute to the intellectual, cultural and sporting life in South Australia through facilities such as the Anne & Gordon Samstag Museum of

Art and the Hawke Centre, and through our sponsorship of events such as the world-class Santos Tour Down Under – the first event on the UCI WorldTour road cycling calendar.

We are a young and confident university, boldly taking on the needs of a changing world.

We are focused on the next generation of great minds and invite you to come and study with the best.

**Ranked 9th in the 2017 THE World University Rankings*

An ENTERPRISING SPIRIT

Building
an industry
connected,
globally
enterprising
university.



FIVE STARS IN

Student Demand
Learning Resources
Skills Development
Social Equity

2018 Good Universities Guide

AUSTRALIA'S MOST INTERNATIONALLY DIVERSE

academic teaching staff

*2017 QS World University
Rankings*

COLLABORATING WITH OVER 2,500 COMPANIES WORLDWIDE

INVESTED OVER \$400 MILLION IN NEW CAMPUS SPACES

Study.

We are South Australia's largest university and offer a wide and varied range of degrees, including programs that are unique just to the University of South Australia.

Solutions.

We are taking on the challenges of tomorrow, by finding solutions through world-class research.

Connections.

We are teaming up with local icons and international heavyweights to drive powerful partnerships focused on building more vibrant, advanced and connected communities.

*We are Australia's
University of Enterprise.*

Your JOURNEY BEGINS HERE



*Be bold and take
on the needs of a
changing world.*

GET THE CAREER YOU WANT

Industry projects / internships and
placements / travel opportunities /
employment and career expos /
networking events / and more.

At the University of South Australia we are focused on life beyond the classroom and helping you get career ready – that's why we are number one in South Australia for graduate careers.* We have strong links with industry and take a practical approach to teaching and learning, so that you can make a real impact in your chosen profession.

Career development planning is one of the most important aspects of university life, so we have a dedicated Career Services team to support you with achieving your career goals. They offer an extensive range of services, resources and tools to help you plan your career, get yourself ready for the workplace, connect to industry and most importantly find a job in your chosen field.

unisa.edu.au/careers

*QILT: Graduate Destinations Survey 2014-2015 and Graduate Outcomes Survey 2016 – Full-time Employment Indicator.



STUDY IN WORLD-CLASS FACILITIES

Our campuses are equipped with state-of-the-art facilities including modern lecture theatres, libraries, workshops, laboratories and areas that simulate real work environments. These are all supported by the latest technologies and a fully interactive online learning platform.

For more information see our campuses on pages 18–23.

LEARN FROM TOP RANKING TEACHERS

Learn from highly experienced academics and industry professionals who are leaders in their field. We are Australia's number one young university for teaching quality in the 2017 Times Higher Education Top 200 Under 50 Teaching Indicator and are in the top 10 nationally for the number of staff who hold a PhD.

SEE THE WORLD

Each year our students have the chance to take part in study tours, work placements, volunteer trips, international conferences and student exchange programs. We work with more than 70 partner institutions offering a variety of full-semester and full-year international exchanges and short-term opportunities during summer or winter school. In addition, most overseas experiences are available for credit, and the University has several funding and scholarship opportunities.

unisa.edu.au/globalopportunities

JOIN OUR GLOBAL ALUMNI

When you graduate, we'll welcome you to our global alumni network. We have over 200,000 alumni around the world, supported by five formal international networks in Hong Kong, China, Singapore, Malaysia and the United Kingdom. Membership is free, lifelong and worldwide. All you need to do is update your details when you graduate to start accessing benefits including the Alumni Business Directory, professional services, and online networking community – Global Connect.

unisa.edu.au/alumni

Discover ADELAIDE

The University of South Australia is located in Adelaide, Australia's education city.

THE DESTINATION

Adelaide is a beautiful and well-ordered city, surrounded by parklands, pristine beaches, and the lush green hills and valleys of Australia's premier wine districts. You'll find it makes an ideal home away from home with a strong sense of community usually reserved for small towns, combined with the vibrant activity of a capital city.

Adelaide is also globally connected, sharing partnership agreements with cities around the world, including:

Austin, USA / Christchurch, New Zealand / George Town, Malaysia / Himeji, Japan / Qingdao, China / Dalian, China / Chengdu, China

FAST FACTS

Capital city / *Adelaide*

State population / *1.7 million*

Adelaide population / *1.3 million*

Language / *English*

Currency / *A\$*

Area / *984,377 square kilometres*

Coastline / *3,700 kilometres*

Major exports / *Metals, wine, education*

INTERNATIONAL DISTANCES TO ADELAIDE

Dubai – 13 hours 25 minutes

Hong Kong – 8 hours 20 minutes

Kuala Lumpur – 7 hours

Singapore – 6 hours 30 minutes

Approximate times displayed for direct flights.

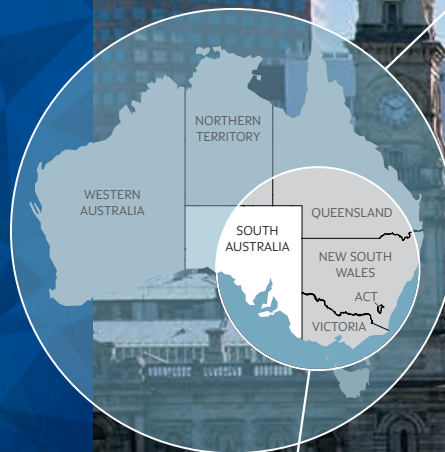



WHY STUDYING HERE IS SO REWARDING

Accessible

Adelaide offers all of the advantages of big city life yet is small enough to get around easily. It takes just 20 minutes to get from the airport to your city campus, or from your city campus to the beach.

Accepting

Almost one in four people in South Australia were born overseas with ancestry tracing back to more than 120 countries. Australia also has a democratic system of government and is tolerant of different religious beliefs and practices.

Affordable

Adelaide has one of the highest standards of living of any city in the world, yet is one of the least expensive.



**19% less to live in
Adelaide compared to
Sydney & Melbourne***



**7% less to live in
Adelaide compared to
Brisbane & Perth***

**Based on information
from Study Adelaide
studyadelaide.com/live*

COMFORTABLE CLIMATE

Adelaide has a Mediterranean climate with hot, dry summers and mild winters.

*Daytime
temperatures*

Summer 25°C–35°C

December–February
Mainly hot & dry

Autumn 20°C–25°C

March–May
Mainly dry

Winter 10°C–15°C

June–August
Cool & wet

Spring 20°C–25°C

September–November
Little rain

AUSTRALIA'S GREEN CITY

Did you know?

- Adelaide is one of Australia's most environmentally friendly cities.
- The famous parklands are made up of 29 parks, which surround the city centre.
- Adelaide City Bikes has more than 500 bikes available for free hire. We also have hire sites located at both the City East and City West campuses.

EXPLORE OUR CAMPUSES

Adelaidepage 18

Suburbanpage 20

Campus location map.....page 25



WORLD'S 5TH MOST LIVEABLE CITY

Adelaide is ranked as the world's fifth most liveable city in the latest Economist Intelligence Unit's Liveability Index and has been recognised for its stability, healthcare, culture, environment, education and infrastructure.

SPORTING STAGE

Adelaide is home to a vibrant sporting culture and events such as the adrenalin-charged Adelaide 500 motor race and World Solar Challenge.

The multi-million dollar refurbishment of Adelaide Oval has also brought a new edge to the city's sporting scene with 'Aussie Rules' football games, international cricket matches, soccer, and more.

The Santos Tour Down Under, the first ProTour cycling race to be held outside of Europe, brings the world's cycling elite to Adelaide. The University sponsors the Australian national team and is a huge participant in the eight-day event.

southaustralia.com





Image courtesy of Adelaide Oval SMA Ltd
(Photographer: John Montesi).

Adelaide Oval / Based in the heart of the city, this iconic venue plays host to national and international entertainment and sporting events, seating over 50,000 people.

Glenelg Beach / Located just 12 kilometres from the city, Glenelg offers classic seaside charm with a white sandy beach known for wild dolphins, diving and snorkelling.





FESTIVAL FEVER

Adelaide is the festival city and every year it comes alive with an explosion of colour, lights, music and culture.

The world-famous Adelaide Festival is Australia's largest multi-arts festival. Held every year around March, it attracts hundreds of thousands of people from across the country and around the world.

Other big festivals include the Adelaide Fringe Festival, OzAsia Festival, Adelaide Film Festival, WOMAdelaide, Tasting Australia and the Adelaide Cabaret Festival. The University supports Adelaide's festival scene through sponsorships and links to many of these events, and discounted tickets are often available to our students.

South Australia
is host to
**MORE THAN
400 FOOD, ARTS
AND CULTURAL
EVENTS**
each year



Barossa Valley / This world-famous region offers breathtaking views, gourmet food and wine festivals, and magical experiences such as hot air balloon rides.





OzAsia Festival / This is Australia's premier international arts festival focusing on Asia. The city of Adelaide is transformed through a mix of contemporary art, the annual Moon Lantern Festival, and international music at the Good Fortune Market.



Fringe Festival/ This is the largest open access arts festival in the Southern Hemisphere, providing 31 magical days of events where Adelaide comes alive with exciting pop-up venues.



Santos Tour Down Under / The University is a proud Premier Partner of this global event held in Adelaide each year.

Our CAMPUSES

Our two city campuses are conveniently located in the heart of the Adelaide CBD.

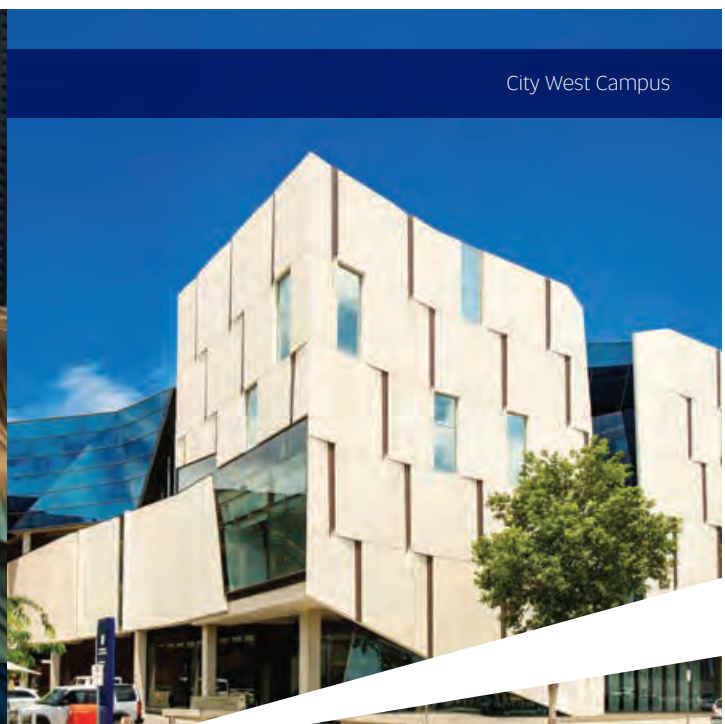
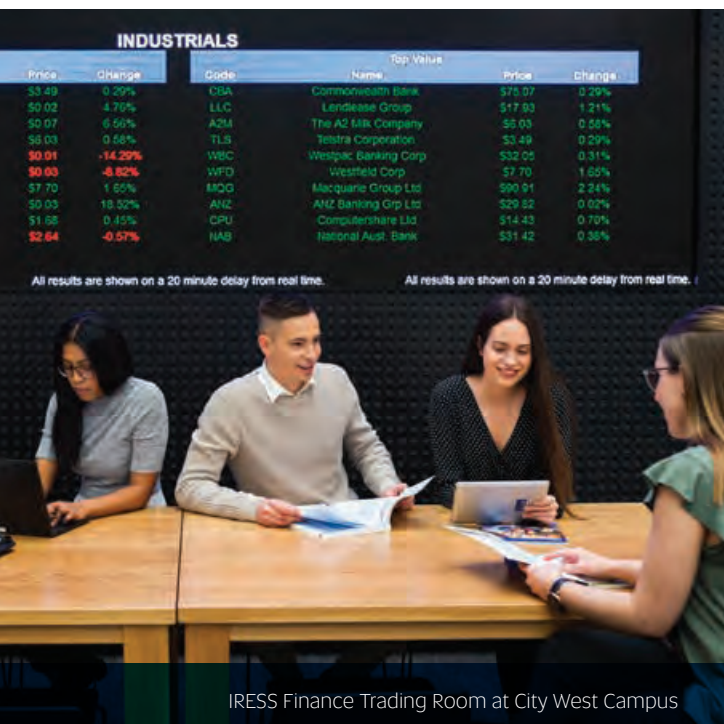

CITY WEST

City West campus is located on the western edge of the CBD. The West End is fast becoming an arts, food and cultural hub, paired with exciting new developments in business and the health industry. City West features a variety of modern facilities including the multi-award winning Jeffrey Smart Building (JSB) and the newly-built Pridham Hall – home to a flexible event and graduation space, public sports complex and swimming pool.

What you'll study

Art, Architecture and Design

Business

Finance

Law

Marketing

On campus

IRESS Finance Trading Room / [Law Clinic](#) / Mock court / [Marketing Clinic](#) / Architecture studios and workshop / [Visual art and design studios](#) / Photography darkroom / [Post office](#) / Cafés with outdoor dining / [Jeffrey Smart Building](#) / Student Lounge / [SASA Gallery](#) / Architecture Museum / [Samstag Museum](#) / Pridham Hall / [Health Innovation Building](#) / UniSA Health and Medical Clinic / [MOD. \(a futuristic museum of discovery\)](#)

Nearby

Live music venues / [Fashion, music and books stores](#) / Cafés and restaurants / [Lion Arts Centre and Mercury Cinema](#) / The Jam Factory / [Adelaide Oval](#) / Royal Adelaide Hospital / [Central Markets and Chinatown](#)

Lonely Planet has ranked Adelaide's West End as one of the top three "coolest neighbourhoods" in Australia. It has been recognised for its pedestrian friendly laneways, world-class food and hospitality scene, architectural gems and buzzing atmosphere.

CITY EAST

City East boasts impressive educational facilities and is located in close proximity to some of Adelaide's best eateries, bars and shopping, providing a vibrant city setting. The campus is home to our health science programs and community health clinics. City East also features a range of state-of-the-art laboratories and a fully-equipped gym.

What you'll study

Construction Management

Human Movement

Medical and Medical Radiation Sciences

Nursing and Midwifery

Nutrition and Food Sciences

Pharmacy

Physiotherapy

Podiatry

On campus

Replica hospital and community health settings / [Anatomy Lab](#) / [Pharmacy Lab](#) / [Histopathology and Haematology Lab](#) / [Microbiology Lab](#) / [Biomechanics Lab](#) / [Sensory Lab](#) / [Exercise Physiology Lab](#) / X-ray suites / [Virtual Environment Radiation Training Suite \(VERT\)](#) / Built Environment Experiential Learning Suite / [Commercial kitchen](#) / Environmental Chamber / [Gym](#) / Cafés and outdoor plaza / [Student lounges](#)

There are also multiple community health clinics located on campus including the Physiotherapy Clinic, Podiatry Clinic, High Performance and Exercise Physiology Clinic, and the UniSA Health Medical Clinic.

Nearby

Rundle Street cafés, shops and cinemas / [Adelaide Zoo](#) / Botanic Gardens / [Museum, State Library and the Art Gallery](#) / River Torrens / [National Wine Centre](#) / Adelaide event zones

unisa.edu.au/campus-facilities

MAGILL

Nestled near the foothills in the leafy eastern suburbs, Magill campus combines lush gardens and open spaces with world-class study facilities. These include industry-standard television and radio studios, a purpose-built social work studio, community Psychology Clinic and a theatre for performing arts.

What you'll study

Arts

Communication and Journalism

Education (Early Childhood)

Education (Primary)

Psychology

Social Work

On campus

TV Studio / [Sound Studio](#) / Radio Studio / [Journalism newsroom](#) / Theatre / [Language Lab](#) / Social Work Studio / [Cognitive Neuroscience Laboratory](#) / Sleep Centre / [Psychology Clinic](#) / Allied Health Clinic / [Gym](#) / Outdoor sports field / [Swimming pool](#) / Cafés / [Parklands and lawn areas](#)

Nearby

Cafés and restaurants / [Norwood Parade shopping precinct](#) / Movie cinemas / [Historic winery](#) / National parks / [Cleland Wildlife Park](#) / Magill Road shopping precinct / [Walking and hiking trails](#)

MAWSON LAKES

Located near more than 85 high-technology companies that make up Technology Park, Mawson Lakes campus forms part of an innovation hub in Adelaide's northern suburbs. This campus is home to South Australia's largest IT School and features state-of-the-art learning spaces for engineering, science, technology and design.

What you'll study

Aviation

Education (Primary)

Education (Secondary)

Engineering

Information Technology

Science and Mathematics

On campus

Industry-standard engineering facilities / [Specialist IT facilities](#) / Mac and CISCO networking labs / [Materials and Minerals Science Learning and Research Hub](#) / Future Industries Institute / [Planetarium](#) / UniSA Aviation Hangar (located near campus) / [Ecological precinct](#) / Drama centre / [Cafés, lawn and outdoor dining areas](#) / Sports centre and gym

Nearby

Cafés and restaurants / [Walking and bike trails](#) / Drive-in movie cinema / [Mawson Central Shopping Mall](#) / Sporting grounds and golf course / [Mawson Centre – a shared space for the University and community](#) / Technology Park

Our suburban campuses
offer picturesque settings
in Adelaide's northern
and eastern suburbs.

Mechatronics Lab at Mawson Lakes Campus



Mawson Lakes Campus

Magill Campus



TV Studio at Magill Campus

NEW SPACES

Pridham Hall

This is the new heart of the University where we host graduations, functions and sporting events. Take a virtual tour by downloading the Pridham Hall app in Google Play or the App Store.

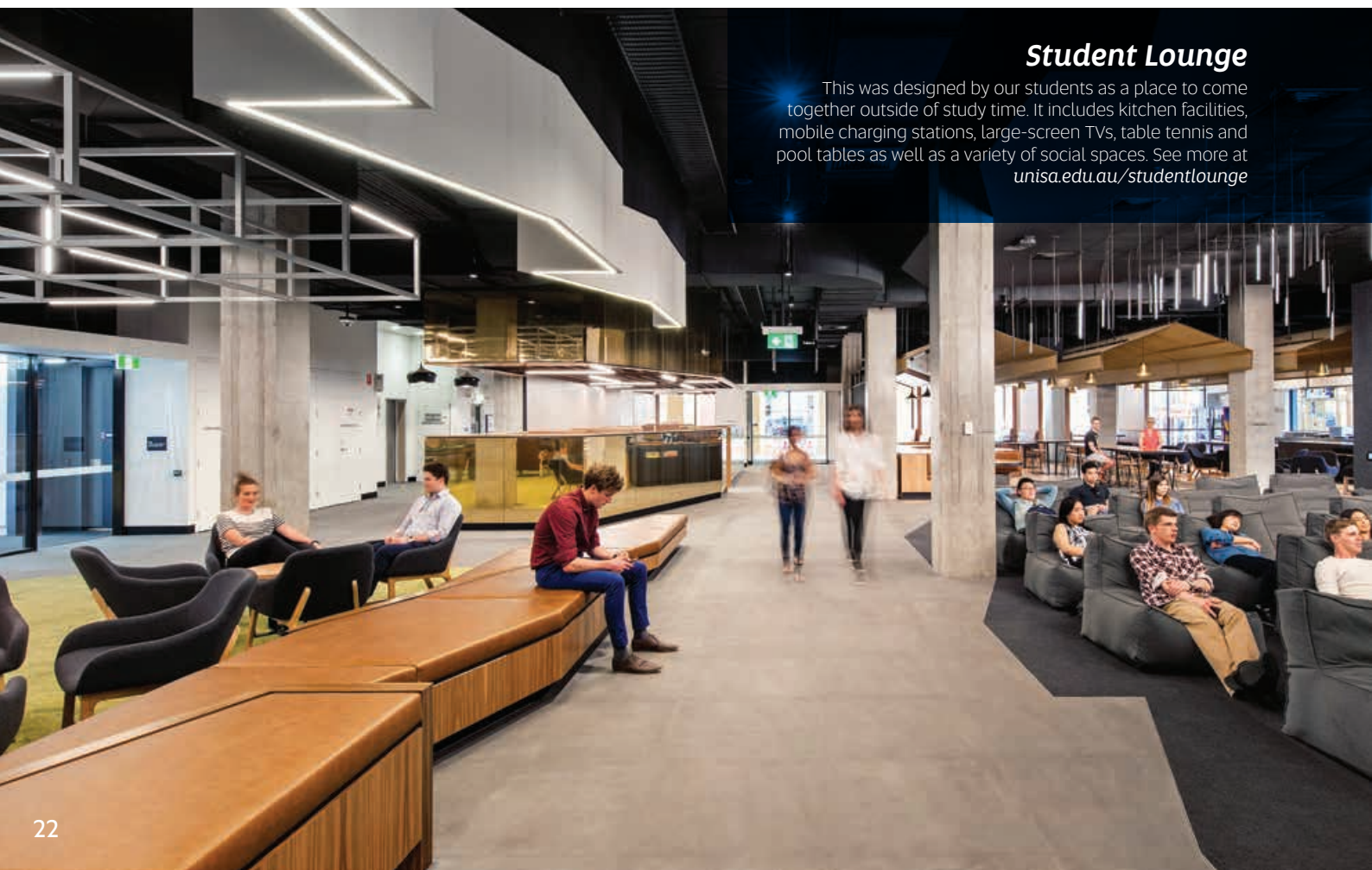

Student Lounge

This was designed by our students as a place to come together outside of study time. It includes kitchen facilities, mobile charging stations, large-screen TVs, table tennis and pool tables as well as a variety of social spaces. See more at unisa.edu.au/studentlounge



Jeffrey Smart Building

The award-winning Jeffrey Smart Building features the very best in modern learning facilities. It boasts over \$8 million in new technologies with 600+ student computers, high tech and silent study zones, cafés and social spaces. Discover more at unisa.edu.au/JSB

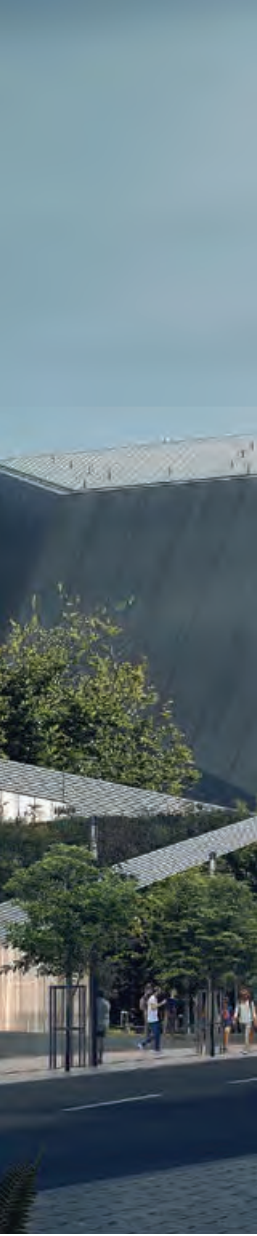

Health Innovation Building

The \$247 million Health Innovation Building is located in SA's health and biomedical precinct in the Adelaide CBD, and is focused on creating new opportunities for research, teaching and community engagement. Check out this world-class project at unisa.edu.au/HIB





Getting TO CAMPUS

PUBLIC TRANSPORT

You'll find bus stops near each campus and train stations close to the city and Mawson Lakes campuses. Check your bus, train or tram options on the Adelaide Metro website. You'll also be entitled to the same public transport discounts as local students saving you hundreds of dollars every year.

adelaidemetro.com.au

CAMPUS CONNECTOR

We run a free bus service between the Magill and Mawson Lakes campuses to make life easier for staff and students who make the journey. For full timetable and route details visit:

unisa.edu.au/campusconnector

CAR PARKING

The Magill and Mawson Lakes campuses provide on-site car parking. Tickets are purchased through the UniSA Parki app available through the App Store and Google Play, or from easily located 'Pay and Display' metered parking machines. Car parking will cost you from \$0.20 an hour to \$1.50 for a full day (8:00am–6:00pm). For city campuses, there is metered on-road and commercial parking nearby, with costs starting at \$4.00 an hour to \$15.00 a day for early bird rates.

ACCESS PARKING

Access parking for people with a disability is available with a parking permit on every campus. Council disabled parking bays are also available.

MOTORCYCLE PARKING

You can park your motorcycle on University grounds at City East, Magill and Mawson Lakes campuses with a UniSA parking permit. At City West, motorcycles can be parked in the designated council parking bays.

RIDE YOUR BIKE

Cycling is a great way to get to your campus. It's fun, cheap, good for the environment, and an excellent form of exercise. Each campus has shower facilities and secured bicycle storage areas. You can also hire an Adelaide Free Bike from Security at City East or City West to get around during daylight hours.

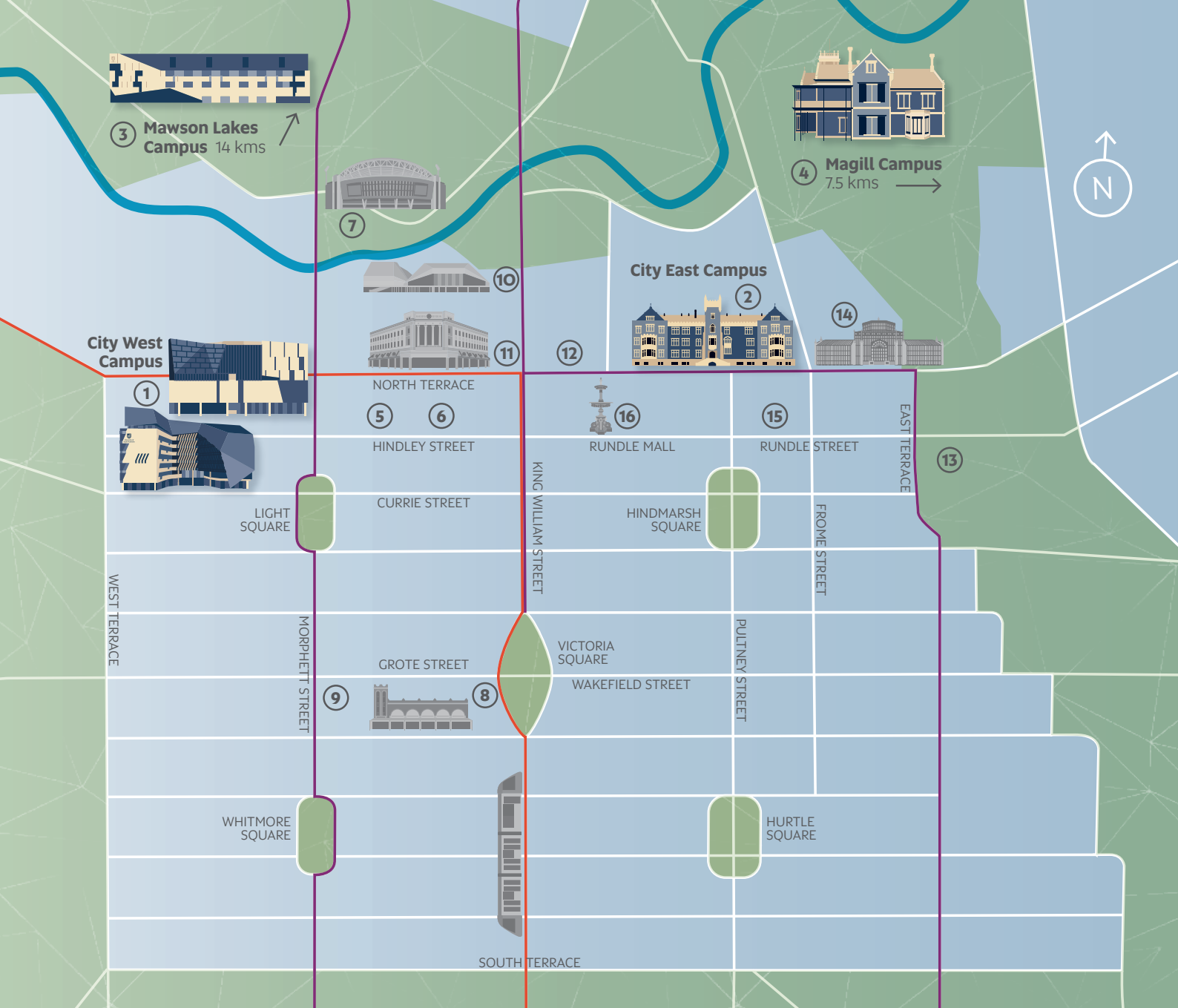

① City West Campus
61-73 North Terrace, Adelaide

② City East Campus
Corner Frome Road and North Terrace, Adelaide

③ Mawson Lakes Campus
Mawson Lakes Boulevard, Mawson Lakes

④ Magill Campus
Lorne Avenue, Magill

FREE tram route
FREE bus route

⑤ UniLodge Student Accommodation 30 Victoria Street, Adelaide

⑥ UniSA Student Accommodation by urbanest 12 Bank St, Adelaide

⑦ Adelaide Oval International and national entertainment and sporting events

⑧ Adelaide Central Markets Fresh produce, groceries

⑨ Chinatown Adelaide's home of Asian food and culture

⑩ Adelaide Festival Centre Adelaide Festival, theatre, cabaret, concerts

⑪ Adelaide Railway Station Central terminus of the metropolitan railway system

⑫ Adelaide Cultural Hub North Terrace Museum, State Library and SA Art Gallery

⑬ Adelaide Event Zones Adelaide Festival, Fringe, Clipsal 500, WOMAdelaide

⑭ Adelaide's Botanic Gardens and Zoo Palm House, Bicentennial Conservatory

⑮ Rundle Street Cinemas, eateries, coffee shops

⑯ Rundle Mall Central shopping precinct

*We can
meet you
at the
airport*

One big advantage of Adelaide is its accessibility, with direct flights from major Asian airports, Dubai, Doha (Qatar) and all Australian capital cities. We offer a free on-arrival reception service and if you complete the online booking form before you leave home we will meet you at the airport.

unisa.edu.au/on-arrival-reception



Your STUDY EXPERIENCE

LIBRARY RESOURCES

Your campus library provides easy access to a large range of resources including books, electronic journals, databases and more. Make the library catalogue and databases your first stop for researching your assignments, and attend one of our workshops designed to improve your research skills. We also have private group learning spaces available on every campus and you can connect to our free Wi-Fi.

24/7 ONLINE LEARNING

Our multi-million dollar fully interactive online learning environment provides for online submission and return of assignments, support for learning, virtual classrooms, lecture recordings and more. It's part of our comprehensive Digital Learning Strategy, and it's available to you 24 hours a day, seven days a week.

GETTING HELP

Library staff can be contacted virtually using video conferencing or you can arrange to meet in person. The Ask the Library/IT service is also available via phone, email, video and chat. See back cover for more information on connecting with the University.

STUDENT APPS

Download the UniSA app for Apple and Android to access a range of services and resources to help you with your studies including timetable management, assessment reminders, notifications, email, calendar and more.

unisa.edu.au/studentapp

We have also developed the SafeZone app that will connect you directly to our security teams should you need assistance or emergency support while you are on campus.

unisa.edu.au/safezone

STUDENT ASSOCIATION

USASA provides a voice for students and offers key services including student representation and advocacy, coordinating student clubs and selling second-hand text books. They also organise social events, competitions and the student-led magazine – *The Verse*.

unisa.edu.au/usasa



Scholarships

Each year more than 2,500 students at the University of South Australia benefit from scholarships and grants totalling millions of dollars. We have a range of categories including support for high achievers and students in need, along with scholarships specifically for international students.

Generous support is also available for research students. See page 73 for more information.

unisa.edu.au/scholarships

Australia Awards

The Australia Awards are prestigious international scholarships and fellowships funded by the Australian Government, offering the next generation of global leaders an opportunity to undertake study, research and professional development in Australia. We host a number of awardees and our dedicated team provides a support service from application to graduation.

australiaawards.gov.au

Research DEGREES

Research at the University of South Australia is inspired by challenges and opportunities, partnered with end-users and communities, and underpinned by excellence.

SOLUTIONS FOR A CHANGING WORLD

The rapid pace of global change is driving many new social, economic and environmental challenges. Research at the University has been positioned around six key themes to ensure we can deliver innovative and sustainable solutions that respond to the most pressing needs of our world today.

An age friendly world

Unlocking human potential across the community through intergenerational approaches.

Transforming industries

Building industries and economies for the future.

Cancer

Taking on one of the world's greatest health challenges with the aim of improving prevention, diagnosis, treatment and patient care.

Transforming societies

Examining and evaluating changes in the world and the impact on our lives.

Healthy futures

Understanding, treatment and prevention of chronic diseases.

Scarce resources

Developing safe and sustainable practices for managing the world's finite resources.

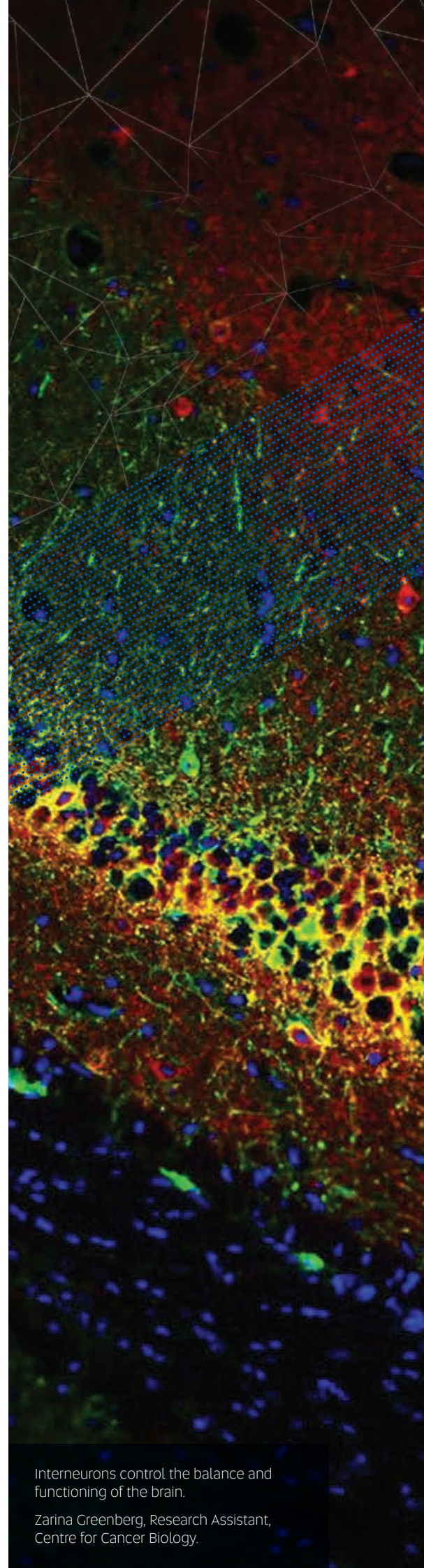

Interneurons control the balance and functioning of the brain.

Zarina Greenberg, Research Assistant,
Centre for Cancer Biology.



**RATED 8TH
OVERALL
IN AUSTRALIA**
for research excellence*

**proportion of total ERA ratings at
the 2-digit and 4-digit level in 2015.*

The Australian, 11 December 2015.

HIGHER DEGREES BY RESEARCH

The University offers a wide range of research degrees including a PhD, professional doctorate or masters by research. Our research environment is supported by highly experienced and engaged supervisors, with strong connections to industry, government and communities.

Our research degrees are focused on producing new knowledge, providing solutions to global challenges and preparing candidates for competitive careers.

Find out how to become a research student at the University on page 71.

TYPES OF RESEARCH DEGREES

Masters by research (2-years)

Students learn, under supervision, how to analyse a thesis topic at an advanced level and apply research methodology and techniques to the contribution of new knowledge.

Doctor of Philosophy (PhD) (4-years)

PhD students prepare a thesis which represents a significant contribution to their chosen field. Graduates will be capable of independently planning and executing original research that generates new knowledge.

Professional doctorate (4-years)

This is a rigorous program of advanced study and research which meets the needs of industry, and consists of coursework and research.

RESEARCH CONCENTRATIONS

Ehrenberg-Bass Institute for Marketing Science / [Future Industries Institute \(FII\)](#) / Sansom Institute for Health Research / [Centre for Cancer Biology \(CCB\)](#) / Institute for Telecommunications Research (ITR) / [Australian Centre for Child Protection](#) / Institute for Choice / [Centre for Islamic Thought and Education](#) / Centre for Workplace Excellence

Supporting YOU

Connect with our expert support services to make your life at university easier.

We want you to be successful, and if you need help you'll have it. We provide a full range of integrated support services including academic counselling, personal counselling, social support services, common rooms, prayer rooms, security officers, and a range of other services offered through our students association, USASA.

Your Campus Central office will help you with your enrolment, ID cards, fees, timetables and any other questions you might have.

YOUR SUPPORT AT A GLANCE

Community health clinics / [disability services](#) / [counselling](#) / [mentoring](#) / Legal Advice Clinic / [health and fitness centres](#) / wellbeing resources and advice / [international student services](#) / accommodation

STUDENT SERVICES

We provide a range of free online services and resources specifically for international students. We also offer face-to-face support including counselling and disability services, careers advice, study help, and assistance with student health cover.

FAMILY SUPPORT

The University also offers advice and assistance on settling into life in Adelaide and Australia for partners or other family members who accompany international students.

GETTING STARTED

We have specialised services and staff that can help you transition into the University, and provide information and advice about:

- On arrival transport to your accommodation
- Life in Adelaide
- Your orientation to university
- Work rights in Australia
- Community and government services
- Academic policies and procedures

unisa.edu.au/internationalstudentsupport

Apply now with our online application system

Save and submit your application at any time, track its progress, and accept your offer, all in one place. For more information visit:

unisa.edu.au/international/apply

Help for sponsored students

A sponsored student is someone who has all or part of their education costs paid by a third party, such as a foreign government, the Australian Government, a partner university or an employer. We currently host more than 300 sponsored students and understand their needs. Our international office has a team of staff dedicated to working with students and sponsor bodies to achieve the best outcome for all.

As the central contact point for sponsors, the international office liaises with a wide range of services across the University, to ensure applications are prioritised, and student orientation and support services are readily available after arrival.

unisa.edu.au/sponsored-students

| | | |
|---|---|---|
|  Bangladesh |  Iraq |  Paraguay |
|  Bahrain |  Jordan |  Peru |
|  Bhutan |  Kuwait |  Philippines |
|  Brazil |  Laos |  Qatar |
|  Cambodia |  Libya |  Saudi Arabia |
|  Colombia |  Malaysia |  Singapore |
|  Costa Rica |  Mongolia |  Sri Lanka |
|  Czech Republic |  Myanmar |  Tanzania |
|  Egypt |  Nepal |  Thailand |
|  Fiji |  Nigeria |  Timor Leste |
|  India |  Oman |  Tuvalu |
|  Indonesia |  Pakistan |  United Arab Emirates |
|  Iran |  Papua New Guinea |  Vietnam |





Shared outdoor balcony space located on North Terrace.

Accommodation OPTIONS

Dedicated student accommodation

Student hostels

A\$140–A\$200 per week

Student hostels provide fully-furnished single rooms with a shared kitchen, bathroom and recreational facilities. Bills (such as electricity) are included in the rent. These are great places to meet fellow students and build networks.

Student apartments

A\$150–A\$390 per week

A variety of student apartment options are available in the city and near our suburban campuses. These include fully-furnished one to six bedroom apartments, with shared

kitchen, living and bathroom facilities. Chores and household expenses are usually negotiated with fellow tenants.

Please see the map on page 25 for site locations.

Residential colleges

A\$325–A\$490 per week

Located in North Adelaide, a 10 minute walk from the city, are a number of residential colleges which offer fully-furnished single rooms with a bed, desk, chair, telephone and wardrobe. Most include meals and provide access to computers, the internet, a library, music rooms, sporting facilities and a laundry.

Non-profit housing

Several not-for-profit and subsidised housing options are open to students. Eligibility criteria and waiting lists apply.

For more information about your accommodation options visit:

unisa.edu.au/accommodation

For personalised advice contact:

Phone: +61 8 8302 0877

Email: accommodation@unisa.edu.au



UniSA STUDENT ACCOMMODATION BY urbanest

The new urbanest Bank Street offers intelligently designed, modern apartments and studios. Located in the heart of Adelaide's CBD, it's directly across from the central railway and tram stations, and bus links to a number of suburbs. It's a five minute walk to Rundle Mall – Adelaide's premier shopping district – and in between our City East and City West campuses. There is also easy access to public transport for both our Magill and Mawson Lakes campuses. You can choose to live in a fully-furnished shared apartment or your own studio, both including the following services:

Swipe card access and CCTV / gym facilities / iMAC stations / secure bike store / wireless internet / 24/7 onsite team / big screen TV and games room / outdoor balcony with BBQs / laundry

There is also additional value included in your rent such as electricity, water, contents insurance (up to A\$3,000) and 100GB internet allowance per month. You'll have support upon arrival with a property induction and welcome events, along with access to uLife – a community support and engagement program that's free for all residents.

Your rent also gives you access to gym and pool facilities on all campuses, cooking classes, a peer assisted learning support program and free transport services from the airport when you arrive in Adelaide for the first time.

For more information and a 360° virtual tour visit unisa.edu.au/accommodation



Private rental accommodation

Private rental

A\$120–A\$350 per week

Renting privately can be a very affordable housing option if you are prepared to shop around. You can rent an entire property, share with other students, or live in a home with a family, couple or single person.

Homestay

Approximately A\$300 per week

Students can live in a home with a family, couple or single person. Costs include your own furnished room, meals and utilities. Stays can be as short as four weeks.

STUDENT RENTAL DATABASE

This is a great way to find the ideal place to stay. Login for exclusive search access, get contact information for listings, save listings to your shortlist and more.

You can also look for vacancies through real estate agencies and newspaper classifieds.

unisa.edu.au/accommodation/rental

Note: the University does not inspect private rental properties (including those in the rental database). It is very important that you inspect the accommodation carefully and meet future housemates before paying money or agreeing to lease.

TEMPORARY ACCOMMODATION

If you have not finalised your long-term accommodation, please ensure that you arrange temporary accommodation before arriving in Adelaide. Plan to arrive two weeks before the start of your program to allow enough time to select accommodation and get settled.

unisa.edu.au/temporary-accommodation

HOUSING FAQs

If you decide to rent, it is important to know your rights and obligations. To help avoid common rental traps, go online and check out our helpful Housing FAQs.

unisa.edu.au/housingfaqs

Note: all costs are per person in Australian dollars and are only an approximate.



GET START



BUSINESS *and* **LAW**

UniSA Business School/36–42

EDUCATION, ARTS *and* **SOCIAL SCIENCES**

Art, Architecture and Design/43–45

Media Arts/46–47

Education/48–51

Psychology, Social Work and Human Services/52

HEALTH *and* **MEDICAL SCIENCES**

Health and Medical Sciences/53–55

IT, ENGINEERING, *and* **THE ENVIRONMENT**

Data and Information Management/56–59

Engineering/59–61

Science and Built Environments/62–63

UniSA BUSINESS SCHOOL

The UniSA Business School is ranked in the top one per cent worldwide* and is one of only nine business schools in Australia to be accredited by EQUIS – the EFMD Quality Improvement System. Our postgraduate business degrees will provide you with an advanced understanding of contemporary theories and practical applications, enabling you to achieve key business objectives in a broad range of organisational contexts and manage emerging issues within today's global business environment. Our strong partnerships also give you the opportunity to work on industry projects, receive business mentoring and undertake internships as part of your studies.

FEATURED PROGRAMS

- Master of Management
- Master of Business Administration
- International Master of Business Administration
- Master of Finance
- Master of Professional Accounting

WE ALSO OFFER

- Graduate Certificate in Business
- Graduate Certificate in Business Administration
- Graduate Certificate in Human Resource Management
- Graduate Diploma in Business Administration
- Graduate Diploma in Human Resource Management
- Graduate Diploma in Management (Arts and Cultural Management)
- Master of Management (Arts and Cultural Management)

For more information visit:
unisa.edu.au/study

**RANKED 27TH
WORLDWIDE**

FOR HOSPITALITY AND
LEISURE MANAGEMENT

2017 QS Subject Rankings

5-STAR MBA

OUR MBA PROGRAM
HAS BEEN AWARDED
5-STARS BY
THE GRADUATE
MANAGEMENT
ASSOCIATION
OF AUSTRALIA
(GMAA) FOR TEN
CONSECUTIVE YEARS

UniSA BUSINESS SCHOOL IS RANKED IN THE TOP 1% WORLDWIDE* AND RATED FIVE STARS^.

*UniSA Business School is one of just nine institutions in the country and 169 globally to be accredited by EQUIS. There are a total pool of 16,585 business schools worldwide, AACSB, May 2017. ^2018 QS Stars Ratings.



GUARANTEED AUSTRALIAN INDUSTRY EXPERIENCE

Every UniSA Business School student completing a masters qualification can complete an industry project or internship, organised by the University.

By selecting the *Industry Elective Package*, you will undertake a career coaching course in the first semester, leading to an Industry Project or Industry Internship in the second semester.

2019 BUSINESS SCHOOL TIMETABLE

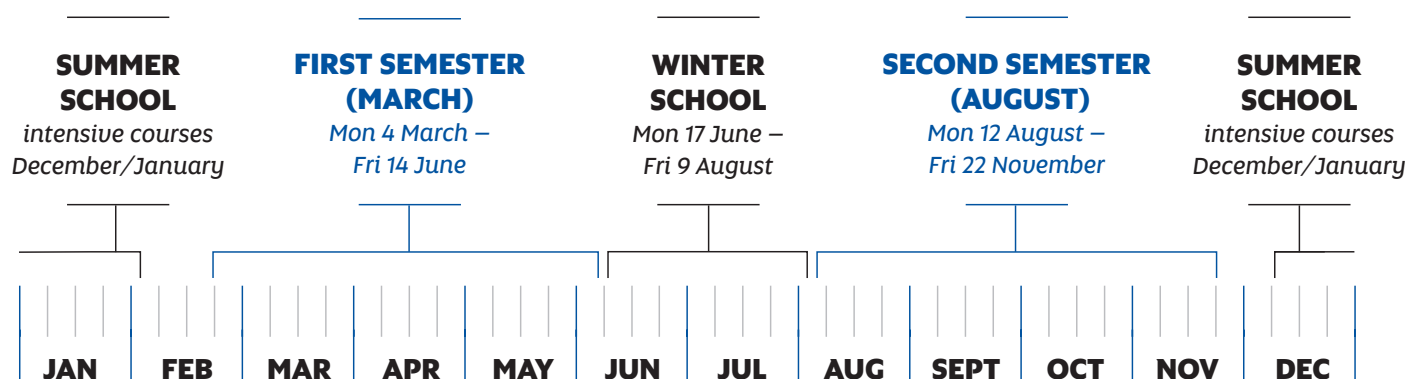

Please note: Summer School and Winter School are not compulsory.

Featuring shorter semesters starting in March and August, the UniSA Business School timetable gives you opportunities such as...



**TAKING UP COURSES
DURING SUMMER AND
WINTER SCHOOLS**



**INTERNSHIPS
AND INDUSTRY
PLACEMENTS**



**GOING ON OVERSEAS
EXCHANGE OR A
STUDY TOUR**



**FAST-TRACKING YOUR
DEGREE OR SPACING OUT
YOUR COURSES**



**MORE TIME FOR
SEEKING PAID
EMPLOYMENT**



**VISITING FAMILY BACK
HOME DURING THE
8-WEEK BREAK**

SOCIAL

- Business Buddies
- Your Culture, My Culture
- Spiced Cooking Demonstrations
- Community Gardens

ACADEMIC

- Peer Assisted Study Sessions (PASS)
- Guest lectures
- Business Student Hub

PROFESSIONAL

- Business soft skill courses
- Networking sessions, site visits and role plays
- Career mentoring
- Placements in local and international companies

MANAGEMENT DMMX

SPECIALISATIONS

- Human Resource Management
- Marketing
- Supply Chain Management
- Tourism and Event Management

CW 1.5 unisa.edu.au/business

ENTRY

CRICOS code*.....varies
 Fees*(indicative 2019).....A\$34,400 pa
 IELTS Total.....6.5
 IELTS Reading.....6.0
 IELTS Writing.....6.0
 Start date.....February, July

*See pages 67–69 for details

Develop advanced skills in leadership, strategy and decision-making.

Build the confidence to manage organisations and achieve key business objectives.

Focus on business ethics, leadership and performance, managing the global workforce, entrepreneurship and innovation, and managing change.

Gain a generalist masters qualification or choose an industry specialisation to tailor your studies.

Be mentored by a senior business leader through the Executive Partners Program.

Benefit from teaching informed by industry professionals and world-class research in management, marketing and business.

Complete industry placements, overseas study tours and elective courses to suit your professional development needs.

SPECIALISATIONS

HUMAN RESOURCE MANAGEMENT

Develop contemporary management skills in the areas of strategic management and human resources. Gain the confidence to manage organisational structures, resourcing and culture.

MARKETING

Study advanced skills in leadership focusing on marketing strategy, planning and decision-making. Connect with world-class researchers from the Ehrenberg-Bass Institute for Marketing Science and the Institute for Choice.

SUPPLY CHAIN MANAGEMENT

Explore networks and processes through logistics and global supply chain management. Build your project management skills and understanding of managing sustainable value chains. Focus on key areas such as business analytics and integrated logistics.

TOURISM AND EVENT MANAGEMENT

Learn the principles and practices of tourism coupled with project and event management. Graduate with the capabilities to be a successful leader and decision maker in a fast-paced environment and pursue a global career in the tourism, event and hospitality sectors.

CAREER OPPORTUNITIES

Depending on your specialisation, your career options could include:

- Business manager
- General manager
- Business executive
- Brand manager
- Marketing manager
- Corporate affairs manager
- Event manager
- Operations manager
- Human resources manager
- Chief human resources officer

ENTRY REQUIREMENTS

Bachelor degree or higher in any discipline from a recognised higher education institution.

RELATED DEGREES

- Graduate Certificate in Human Resource Management
- Graduate Diploma in Human Resource Management
- Graduate Diploma in Management (Arts and Cultural Management)
- Master of Management (Arts and Cultural Management)
- International Master of Business Administration

PROGRAM STRUCTURE

CORE COURSES

Business Analytics and the Data-driven Organisation
 Business Ethics
 People, Leadership and Performance
 Strategic Concepts

HUMAN RESOURCE MANAGEMENT CRICOS CODE: O91992A

SPECIALISATION COURSES

Recruitment and Selection
 Managing Employee Performance and Rewards
 Employment Law F
 Strategic Management of Human Resources
 Managing the Global Workforce
 Managing Change
 2 x Electives

MARKETING

CRICOS CODE: O91993M

SPECIALISATION COURSES

Buyer Behaviour Insights
 Marketing Strategy and Planning
 Advanced Marketing Analytics
 Marketing Management
 2 x Specialisation Electives
 2 x Electives

SUPPLY CHAIN MANAGEMENT CRICOS CODE: O91991B

SPECIALISATION COURSES

Global Supply Chain Management
 Integrated Logistics Management
 Strategic Procurement
 Managing Sustainable Value Chains
 Managing Change
 2 x Specialisation Electives
 Elective

TOURISM AND EVENT MANAGEMENT CRICOS CODE: O91990C

SPECIALISATION COURSES

The Principles and Practice of Tourism
 Sport, Tourism and Events
 Festivals and Events
 Tourism: Impacts and Sustainability
 Managing Change
 2 x Specialisation Electives
 Elective

MANAGEMENT

CRICOS CODE: O91989G

Managing the Global Workforce
 Entrepreneurship and Innovation
 Project Management for Business
 Managing Change
 2x Specialisation Electives
 2x Electives

Master of

BUSINESS ADMINISTRATION DMMA**SPECIALISATIONS**

- Finance
- Human Resource Management
- Marketing

CW 1.5 unisa.edu.au/mba**ENTRY**

CRICOS code*.....varies
 Fees*(indicative 2019).....A\$38,400 pa
 IELTS Total.....6.5
 IELTS Reading.....6.0
 IELTS Writing.....6.0
 Start date.....April, January, June, September

*See pages 67–69 for details

Gain advanced knowledge in decision-making for senior managers and the latest in management research.

Extend your expertise in areas such as strategy, marketing, finance, leadership, ethics and sustainability, law, and international business.

Engage with a cohort of experienced peers from diverse industry backgrounds, in a highly interactive learning environment.

Complete a unique course offering through our partnership with the Australian Institute of Company Directors (AICD).

Participate in a global study experience with a two-week Business in China Intensive School (BICIS) or the European Summer School of Advanced Management (ESSAM).

SPECIALISATIONS**FINANCE**

Learn to lead exceptional teams focused on creating new solutions and exceptional results. Study advanced leadership and management coupled with courses in corporate finance, investment management, financial markets, risk or banking.

HUMAN RESOURCE MANAGEMENT

Access the latest human resource management research and learn from curriculum that is informed by the Centre for Workplace Excellence. Develop strategic management skills and focus on courses in industrial relations, employment law, employee performance, recruitment and selection, workplace learning and development, or health and safety management.

MARKETING

Be immersed in the science behind effective marketing and learn from the latest research and industry findings. Benefit from teaching informed by the Ehrenberg-Bass Institute for Marketing Science – the world's largest centre for research into marketing. Blend strategic management skills with specialised courses in advertising, brand management, e-marketing, consumer behaviour or marketing planning.

CAREER OPPORTUNITIES

This program is designed for experienced managers and executives and can lead to opportunities in:

- Career progression
- Project management
- Senior management
- Executive leadership

PROFESSIONAL RECOGNITION

This program has been awarded five stars by the Graduate Management Association of Australia (GMAA) for ten consecutive years and five stars for Program Strength by Quacquarelli Symonds (QS).

ENTRY REQUIREMENTS

- Minimum three years full-time management experience and a recognised university undergraduate degree or equivalent professional qualifications; or
- Graduate Certificate in Business Administration (DCMA) or Graduate Diploma in Business Administration (DGMA) from the University of South Australia with an average of at least Pass Level 1 across four (or more) courses, or an equivalent qualification from the University of South Australia or another recognised university; or
- The Program Director may, under exceptional circumstances, accept candidates with substantial and proven managerial and/or entrepreneurial experience who have demonstrated the potential to meet the learning requirements of the MBA.

Applicants are also required to submit a detailed curriculum vitae or equivalent with at least one referee who can validate work experience.

RELATED DEGREES

- Graduate Certificate in Business Administration
- Graduate Diploma in Business Administration
- International Master of Business Administration

PROGRAM STRUCTURE**CORE COURSES**

Strategic Thinking: Concepts and Tools
 Accounting for Decision Making
 Managerial Finance
 Managing People and Organisations
 The Law for Managers
 International Business
 Strategic Marketing
 Ethics, Governance and Sustainability
 Leadership for Growth
 Strategic Research Project

ELECTIVE COURSES**GENERALIST MBA**

CRICOS CODE: O48635B

Choose 2 of the following electives:

- Entrepreneurship and Innovation
- Negotiation
- Responsible Leadership
- International Study Tour
- Company Directors Course
- Business in China Study Tour
- Business in China Tour Project
- International Trade Law
- International Study Tour Project
- Corporate Finance Law
- Forecasting for Decision Making
- Intellectual Property and Commercialisation
- Transnational Business and Human Rights
- Business Growth

FINANCE

CRICOS CODE: O83050C

Choose 2 of the following electives:

- Advanced Corporate Finance
- Investment Management
- Financial Theory and Financial Markets
- Managing Financial Risk
- Behavioural Finance
- Risk Management in Financial Institutions
- Responsible Leadership
- Advanced Investment Management
- The Econometrics of Financial Markets
- Money, Banking and Financial Markets
- Chinese Banking & Wealth Management
- International Finance

HUMAN RESOURCE MANAGEMENT

CRICOS CODE: O83052A

Choose 2 of the following electives:

- Workplace Learning and Development
- Managing the Global Workforce
- Introduction to Human Resource Management
- Australian Industrial Relations
- Strategic Management of Human Resources
- Negotiation
- Employment Law F
- Responsible Leadership
- Workplace Health and Safety Management
- Recruitment and Selection

MARKETING

CRICOS CODE: O83054K

Choose 2 of the following electives:

- Advertising: Theory and Practice
- Brand Management
- Buyer Behaviour Insights
- Responsible Leadership
- Advanced Marketing Analytics
- Advertising: Planning and Buying Media
- e-Marketing
- Marketing Strategy and Planning

International Master of

BUSINESS ADMINISTRATION DMIN

SPECIALISATIONS

- Finance
- Human Resource Management
- Marketing
- Supply Chain Management
- Tourism and Event Management

CW **2** unisa.edu.au/business

ENTRY

CRICOS code*.....varies
 Fees*(indicative 2019).....A\$34,100 pa
 IELTS Total.....6.5
 IELTS Reading.....6.0
 IELTS Writing.....6.0
 Start date.....February, July

*See pages 67–69 for details

Note: This is a two-year MBA with a global focus that does not require previous work experience.

Study an early career MBA with a broad global perspective or specialise your studies to suit your interests.

Gain advanced management knowledge and skills to excel in international business.

Learn about international business strategy, international trade, global marketing and managing cultures.

Focus on real-life case studies and apply your expertise to address current global business challenges.

Benefit from experience-based learning opportunities, including overseas study and mentoring by a senior business leader through our Executive Partners Program.

SPECIALISATIONS

FINANCE

Graduate with advanced knowledge and management skills for international business with a focus on finance. Learn the latest finance theory and practice through courses in international finance, financial markets, principles of international business finance and corporate finance.

HUMAN RESOURCE MANAGEMENT

Travel the world with a global career in human resources. Study the latest in human resource management theory and practice with an international perspective. Develop advanced skills in recruitment and selection, managing employee performance, employment law, strategic practice and managing change.

MARKETING

Learn about the complexities behind global buyer behaviour, marketing strategy and planning, advanced marketing analytics and brand management. Benefit from teaching informed by the Ehrenberg-Bass Institute for Marketing Science – the world's largest centre for research into marketing – and connect with marketing scientists who advise brands like Uber, Kellogg's and Unilever.

SUPPLY CHAIN MANAGEMENT

Strengthen your knowledge in global supply chains and networks. Focus on logistics and operations management in a global context. Develop advanced skills and expertise in people leadership and performance, economic principles for business and issues in international trade.

TOURISM AND EVENT MANAGEMENT

Become a global citizen and pursue an international career in tourism and event management. Learn the fundamental principles and practices of tourism coupled with advanced project and event management skills. Graduate with the capabilities to be a successful leader and decision maker in a fast-paced environment.

CAREER OPPORTUNITIES

Depending on your chosen specialisation, your career options could include:

- Foreign affairs officer
- International trade officer
- Consultant
- Project manager
- Global business manager
- Event manager

ENTRY REQUIREMENTS

Bachelor degree, graduate diploma or graduate certificate from a recognised higher education institution with a minimum Grade Point Average (GPA) of 4.

Some applicants may be eligible for Advanced Standing and can complete the program in 1.5 years full-time study or equivalent part-time study.

RELATED DEGREES

- Graduate Certificate in Business Administration
- Graduate Certificate in Human Resource Management
- Graduate Diploma in Human Resource Management
- Master of Management

PROGRAM STRUCTURE

CORE COURSES

International Business: Strategy and Ethics
 Marketing Management
 Accounting for Management M
 Economic Principles for Business
 Global Business Environment
 Issues in International Trade
 Managing the Global Workforce
 People, Leadership and Performance

FINANCE

CRICOS CODE: O92314J

Corporate Finance
 Financial Theory and Financial Markets
 International Finance
 Principles of International Business Finance
 2 x Specialisation Electives
 2 x Business Electives

HUMAN RESOURCE MANAGEMENT

CRICOS CODE: O91996G

Recruitment and Selection
 Managing Employee Performance and Rewards
 Employment Law F
 Strategic Management of Human Resources
 Managing Change
 Specialisation Elective
 2 x Business Electives

MARKETING

CRICOS CODE: O91997G

Buyer Behaviour Insights
 Marketing Strategy and Planning
 Advanced Marketing Analytics
 Brand Management
 2 x Specialisation Electives
 2 x Business Electives

SUPPLY CHAIN MANAGEMENT

CRICOS CODE: O91995J

Global Supply Chain Management
 Integrated Logistics Management
 Strategic Procurement
 Managing Sustainable Value Chains
 2 x Specialisation Electives
 2 x Electives

TOURISM AND EVENT MANAGEMENT

CRICOS CODE: O91994K

The Principles and Practice of Tourism
 Sport, Tourism and Events
 Festivals and Events
 Tourism: Impacts and Sustainability
 2 x Specialisation Electives
 2 x Business Electives

GENERALIST IMBA

CRICOS CODE: O81137A

Global Supply Chain Management
 Managing Across Cultures
 Global Marketing
 Principles of International Business Finance
 2 x Specialisation Electives
 2 x Electives

“The University of South Australia Business School’s reputation for strong performance in international rankings and great academics cemented Sincy’s decision to study the new International Master of Business Administration.

She says the excellent support by teaching staff has helped her easily adapt to studies in Australia.

“I really like the interactive teaching and learning approach the University uses. It is very practical and encourages students to speak up and express their own ideas.

“I am really enjoying the new subjects and the opportunity to learn different things.”

Sincy Joseph / INTERNATIONAL MASTER
OF BUSINESS ADMINISTRATION

Master of

FINANCE DMFC

SPECIALISATIONS

- Banking

CW **2** unisa.edu.au/accounting-and-finance

ENTRY

CRICOS code*varies
Fees*(indicative 2019)A\$34,400 pa
IELTS Total6.5
IELTS Reading6.0
IELTS Writing6.0
Start dateFebruary, July

*See pages 67–69 for details

Further your career in financial markets, corporate financial analysis and investment management.

Engage with market simulation programs in our new state-of-the-art IRESS Finance Trading Room, and the global derivatives trading industry.

Address global business challenges and undertake courses in applied research and analysis.

Take the option to complete 150 placement hours with a local or international organisation.

Tailor your studies through a specialisation in Banking, focusing on financial institutions management, global markets, regulations and risk management.

Be mentored by a senior business leader through the Executive Partners Program.

SPECIALISATIONS

BANKING

Focus on banking and its impact on the global financial system. Study the operation and management of financial intermediaries, risk management within banking, the role that the central bank/financial system regulator plays in the broader economy and contemporary issues facing the world's international financial institutions.

CAREER OPPORTUNITIES

- Commercial and investment banker
- Corporate treasury adviser
- Financial adviser or broker
- Foreign exchange funds manager
- Tax accountant
- Auditor
- Financial planner

PROFESSIONAL RECOGNITION

This program is recognised as a Financial Risk Manager (FRM) Academic Partner by the Global Association of Risk Professionals (GARP) and is also recognised through the Chartered Financial Analyst (CFA) Institute University Affiliation Program. Graduates can also apply for membership with the Financial Services Institute of Australia (FINSIA).

ENTRY REQUIREMENTS

Bachelor degree, graduate diploma or graduate certificate from a recognised higher education institution with a minimum Grade Point Average (GPA) of 4.

Some applicants may be eligible for Advanced Standing and can complete the program in 1.5 years full-time study or equivalent part-time study.

RELATED DEGREES

- Master of Professional Accounting

PROGRAM STRUCTURE

INDICATIVE OF BANKING SPECIALISATION

FIRST YEAR

Statistics for Data Science
Accounting for Management M
Economic Principles for Business
Commercial Law M

Financial Theory and Financial Markets
Corporate Finance
International Finance
Investment Management

SECOND YEAR

Managing Financial Risk
Chinese Banking and Wealth Management
Behavioural Finance
Advanced Corporate Finance

Risk Management in Financial Institutions

Money, Banking and Financial Markets
The Econometrics of Financial Markets
Elective

Master of

PROFESSIONAL ACCOUNTING DMPC

CW **2** unisa.edu.au/accounting-and-finance

ENTRY

CRICOS code*O82982M
Fees*(indicative 2019)A\$34,100 pa
IELTS Total6.5
IELTS Reading6.0
IELTS Writing6.0
Start dateFebruary, July

*See pages 67–69 for details

Build a comprehensive understanding of accounting practice.

Develop crucial analytical, business management, problem-solving and communication skills.

Study with one of only five universities in Australia to offer professional CPA papers within an accounting degree.

Focus on key areas such as commerce, tax, financial management and public practice.

Complete 150 placement hours as an elective course.

Be mentored by a senior business leader through the Executive Partners Program.

CAREER OPPORTUNITIES

- Accountant
- Auditor
- Business adviser
- Financial planner
- Tax accountant
- Management accountant

PROFESSIONAL ACCREDITATION

This program is accredited by CPA Australia and satisfies the educational requirements for entry into the CPA Program. This program is also accredited by the Chartered Accountants Australia and New Zealand (CAANZ) and satisfies the educational requirements for entry into the Chartered Accountants Program.

ENTRY REQUIREMENTS

Bachelor degree, graduate diploma or graduate certificate from a recognised higher education institution with a minimum Grade Point Average (GPA) of 4.

Some applicants may be eligible for Advanced Standing and can complete the program in 1.5 years full-time study or equivalent part-time study.

RELATED DEGREES

- Master of Finance

PROGRAM STRUCTURE

FIRST YEAR

People, Leadership and Performance
Marketing Management
Economic Principles for Business
Commercial Law M

Corporate Finance
Accounting for Management M
Financial Accounting
Elective

SECOND YEAR

Advanced Accounting
Information Systems for Business
Management Accounting M
Elective

Auditing Principles
Research for Business Decision Making
Contemporary Issues in Accounting M
Taxation

ART, ARCHITECTURE AND DESIGN

Develop your creativity at one of the oldest art schools in Australia. We offer degrees that excel and excite, and encourage innovation through intensive studio practice. Be mentored by professional artists, designers and theorists, and access custom-built design workshops in your chosen specialisation.

FEATURED PROGRAMS

- Master of Architecture
- Master of Design (various specialisations)
- Master of Urban and Regional Planning

WE ALSO OFFER

- Graduate Diploma in Design (various specialisations)
- Graduate Diploma in Urban and Regional Planning

For more information visit:
unisa.edu.au/study

**WORLD TOP
100**

**ARCHITECTURE
AND BUILT
ENVIRONMENT**

ART AND DESIGN

2017 QS Subject Rankings

**DISCOVER
AUSTRALIA'S
ONLY
ARCHITECTURE
MUSEUM**

LOCATED ON CAMPUS AND
FEATURING OVER 200,000 ITEMS

Campus: CE: City East, CW: City West, M: Magill, or ML: Mawson Lakes 
Full-time program duration in years 
Quota applies 

Master of ARCHITECTURE DMAE

  unisa.edu.au/architecture

ENTRY

| | |
|------------------------|----------------|
| CRICOS code* | 060208J |
| Fees*(indicative 2019) | A\$34,400 pa |
| IELTS Total | 6.5 |
| IELTS Reading | 6.0 |
| IELTS Writing | 6.0 |
| Start date | February, July |

*See pages 67–69 for details

Develop advanced knowledge in architectural theory and practice.

Pursue specific areas of interest such as urban design, sustainability and digital environments through research and elective courses.

Study in award-winning, custom-designed facilities including dedicated design studios and workshops on campus.

Learn from internationally-renowned and experienced teachers who are also practising architects.

Engage in real industry projects through our award-winning Design Construct initiative – the longest running and largest practice-based program of its type in Australia.

CAREER OPPORTUNITIES

- Architect
- Urban designer
- Heritage consultant
- Project manager

PROFESSIONAL ACCREDITATION

This program is accredited by the Architectural Practice Board of South Australia, endorsing the qualification required for registration as an architect. Graduates are also eligible for membership with the Australian Institute of Architects.

ENTRY REQUIREMENTS

Bachelor of Architectural Studies (DBAE) from the University of South Australia or a bachelor degree in a three-year pre-professional architecture program from a recognised Australian higher education institution or equivalent qualification.

Applicants with a bachelor degree in a three-year pre-professional architecture program from a non-Australian higher education institution must also submit a portfolio as part of their application.

Note: Entry into this program is competitive, based on academic merit and subject to quota. Furthermore, the University may admit other applicants who provide satisfactory evidence of academic achievement, which the University recognises as equivalent to a completed Bachelor of Architectural Studies (DBAE).

RELATED DEGREES

- Graduate Diploma in Design
- Master of Design (Interior Architecture)
- Master of Design (Design and Construct)
- Master of Design (Sustainable Design)

PROGRAM STRUCTURE

FIRST YEAR

Architectural Design Studio 7 (Environment)
AAD Research Methods
Theories and History of Architecture
Architectural Design Studio 8 (Construction)

AAD Research Practices
Elective

SECOND YEAR

Architectural Design Studio 9
Architectural Practice Professional
Elective

Architectural Design Studio 10
Architectural Practice Management
Elective

DESIGN DMSP**NESTED WITH**

- Graduate Diploma in Design (DGSP)

SPECIALISATIONS

- Communication Design
- Contemporary Art
- Design and Construct
- Industrial Design
- Interior Architecture
- Sustainable Design

CW 2 unisa.edu.au/design

ENTRY

CRICOS code*varies
 Fees* (indicative 2019)A\$31,000 pa
 IELTS Total6.5
 IELTS Reading6.0
 IELTS Writing6.0
 Start dateFebruary, July

*See pages 67–69 for details

Develop the skills to become a creative, technical and professional designer.

Tailor your studies with a specialisation that suits your interests and career goals.

Learn in state-of-the-art workshops and studios on campus.

Benefit from industry masterclasses and learn from national and international design practitioners.

Gain practical experience by working on real-life projects and completing an industry placement during your studies.

COMMUNICATION DESIGN

Learn to identify and propose solutions for complex communication design challenges. Develop an advanced body of knowledge in the principles and practices of communication design that extend beyond the visual for a variety of changing socio-cultural, economic and environmental contexts.

CONTEMPORARY ART

Develop your chosen specialisation through advanced studio practice coupled with studies in marketing, business and finance. Specialised fields include: photo, digital and graphic media; curatorship and arts writing; painting and drawing; and spatial studies involving public art, sculpture, textiles, glass, ceramics, jewellery and metal.

DESIGN AND CONSTRUCT

Discover the principles and concepts required for various stages of a building project, from its design and documentation through to construction. Develop the skills to critically review and analyse design and construction processes, consolidate information, and provide solutions for multifaceted projects.

INDUSTRIAL DESIGN

Take a leading role in the innovative humanisation of technology including the development of physical products, systems, interfaces and environments. Gain a deeper knowledge of materials and processing technologies used in manufacturing, along with technical skills in digital prototyping for the simulation, development and communication of three-dimensional design.

INTERIOR ARCHITECTURE

Develop advanced knowledge in order to design socially and environmentally responsive interior environments that sustain human existence. Critically identify, review, analyse and propose solutions to address challenges through various stages of a project, from conceptual design to production. Apply both interior design practice and broader design principles.

SUSTAINABLE DESIGN

Focus on the principles and practices required for a sustainable approach to design that can be applied to a range of complex information systems, challenges, concepts and theories. Learn technical and communication skills to design, evaluate, implement and analyse developments that contribute to sustainable design in a global context.

CAREER OPPORTUNITIES

Depending on your specialisation, your career options could include:

- Graphic designer
- Design consultant
- Interior designer
- Digital media designer
- Design studio manager
- Advertising executive
- Sustainable design consultant
- Industrial designer
- Arts administrator
- Art historian
- Art critic

PROFESSIONAL RECOGNITION

Graduates are eligible for Associate Membership with the Design Institute of Australia (DIA), and Membership after three years of professional practice.

ENTRY REQUIREMENTS

Bachelor degree from a recognised higher education institution or equivalent qualification in a related discipline along with a portfolio of work, curriculum vitae and written statement of intent.

Applicants who have completed a Graduate Diploma in Design (DGSP) from the University of South Australia are eligible to enter and are not required to submit a portfolio of work and statement of intent.

Some applicants may be eligible for Advanced Standing and can complete the program in one year full-time study or equivalent part-time study.

PROGRAM STRUCTURE**FIRST YEAR**

Research Studio 1
 AAD Research Methods
 Elective

Research Studio 2
 Business Practice for Artists and Designers
 Elective

SECOND YEAR

Research Studio 3
 Masters Research Project 1
 Masters Elective

Research Studio 4
 Masters Research Project 2
 Masters Elective

Master of

URBAN AND REGIONAL PLANNING DMUR

NESTED WITH

- Graduate Diploma in Urban and Regional Planning (DGUR)

CW 2 unisa.edu.au/urbanplanning

ENTRY

CRICOS code*.....071951J
 Fees*(indicative 2019).....A\$33,100 pa
 IELTS Total.....6.5
 IELTS Reading.....6.0
 IELTS Writing.....6.0
 Start date.....February, July

*See pages 67–69 for details

Study the promotion and development of sustainable cities.

Benefit from over 60 years' experience in providing world-class planning education.

Learn about urban design, social policy and planning, and urban transportation planning.

Develop advanced knowledge in research methodologies and their applications in the fields of architecture, art and design.

Gain practical experience through work placements and international field trips.

CAREER OPPORTUNITIES

- Urban and regional planner
- Environmental planner
- Urban designer
- Town planner
- Urban data analyst
- City planner
- Urban sustainability planner
- Natural resource manager
- Traffic and transport planner

PROFESSIONAL ACCREDITATION

This program is accredited by the Planning Institute of Australia (PIA). Graduates are eligible to apply for Corporate Membership with PIA and undertake training to gain status as a Professional Certified Planner. Graduates will be required to undertake continuing professional development, which is also offered by PIA.

ENTRY REQUIREMENTS

- Bachelor degree in any discipline from a recognised higher education institution; or
- Graduate Diploma in Urban and Regional Planning (DGUR) from the University of South Australia.

PROGRAM STRUCTURE

FIRST YEAR

Introduction to Regional and Urban Planning
 AAD Research Methods
 Elective 1
 Elective 2

Social Planning and Community Issues
 Transport and Planning
 Sustainable Urban Design 1
 Elective 3

SECOND YEAR

Contemporary Planning Theory
 Transport Policy
 Planning Research Project 1N
 Sustainable Urban Design 2

Planning Research Project 2N
 Environmental Impact Assessment N
 Elective 4
 Elective 5



Interior architecture student Valérie has made a significant impact in the student community while studying at the University.

"I founded the African Society, and have also been an international student representative in the student association."

Valérie was named 2017 Postgraduate International Student of the Year by the Council of International Students Australia for her efforts.

She hopes to undertake a PhD in Australia and become a lecturer in Interior Architecture, a dream she has held since she was six-years old.

Valérie Baya / MASTER OF DESIGN
(INTERIOR ARCHITECTURE)

MEDIA ARTS

Enter the exciting world of film, television, animation, digital design, interactivity, and web and mobile design. Our programs are developed through extensive consultation and partnerships with industry such as the world-renowned visual effects company Rising Sun Pictures and the South Australian Film Corporation. Work in professional studios based in Adelaide and graduate with a finished showreel of your work.

FEATURED PROGRAMS

- Graduate Certificate in Dynamic Effects and Lighting
- Graduate Certificate in Compositing and Tracking
- Graduate Certificate in Film and Television

For more information visit:
unisa.edu.au/study

STUDY VISUAL EFFECTS

WITH WORLD-CLASS
ARTISTS FROM

RISING SUN PICTURES

GRADUATE WITH A

**PROFESSIONAL
SHOWREEL**

Graduate Certificate in

DYNAMIC EFFECTS AND LIGHTING IC DL

CE 0.5 unisa.edu.au/VFX

ENTRY

CRICOS code* 092822M
Fees*(indicative 2019) A\$24,400 pa
IELTS Total 6.5
IELTS Reading 6.0
IELTS Writing 6.0
Start date February, September

*See pages 67–69 for details

Develop the skills to produce industry-standard visual effects for feature film and television.

Learn from one of the world's best visual effects companies, Rising Sun Pictures, who have created visual effects for hundreds of motion pictures including *X-Men* and the *Harry Potter* series.

Create 3D visual effects such as explosions, water effects and clouds along with generated environments such as cities.

Deliver work using industry tools such as Shotgun and computer generated lighting applications.

Graduate with a professional resume and finished showreel.

ENTRY REQUIREMENTS

- Bachelor degree from a recognised higher education institution in media arts, visual effects or a related discipline; or
- Advanced Diploma in Screen and Media or equivalent qualification from an accredited Registered Training Organisation; or
- A Graduate Certificate in Compositing and Tracking (ICVE) from the University of South Australia.

Applicants are also required to submit a showreel of their own work and a curriculum vitae outlining their relevant experience.

For more information please visit:
unisa.edu.au/rsp-admissions-requirements

RELATED DEGREES

This program complements the Graduate Certificate in Compositing and Tracking (ICVE). Classes for both programs are delivered at the Rising Sun Pictures studios in Adelaide.

PROGRAM STRUCTURE

Visual Effects Professional Practice
Digital Asset Development
Digital Effects Development
Look Development and Lighting

CAREER OPPORTUNITIES

- Compositor
- Concept artist
- Digital preparation artist
- Matchmove artist
- Lighting technical director
- Matter painter
- VFX producer
- Roto artist
- VFX supervisor

Graduate Certificate in COMPOSITING AND TRACKING ICVE

CE 0.5 unisa.edu.au/VFX

ENTRY

CRICOS code* O88908F
 Fees*(indicative 2019) A\$24,400 pa
 IELTS Total 6.5
 IELTS Reading 6.0
 IELTS Writing 6.0
 Start date February, September

*See pages 67–69 for details

Develop industry-standard skills in compositing, rotoscoping and tracking.

Master the theory, skills and techniques needed to produce visual effects for film sequences.

Deliver work using professional tools such as Nuke, 3DEqualizer, Maya and Shotgun.

Learn from one of the world's best visual effects companies, Rising Sun Pictures, who have created motion pictures including *X-Men* and the *Harry Potter* series.

Graduate with a professional resume and finished showreel.

CAREER OPPORTUNITIES

- Compositor
- Concept artist
- Digital preparation artist
- Layout artist
- Matchmove artist
- Lighting technical director
- Matter painter
- VFX producer
- Roto artist
- VFX supervisor

ENTRY REQUIREMENTS

- Bachelor degree from a recognised higher education institution in media arts, visual effects or a related discipline; or
- Advanced Diploma in Screen and Media or equivalent qualification from an accredited Registered Training Organisation; or
- A Graduate Certificate in Dynamic Effects and Lighting (ICDL) from the University of South Australia.

Applicants are also required to submit a showreel of their own work and a curriculum vitae outlining their relevant experience.

For more information please visit: unisa.edu.au/rsp-admissions-requirements

RELATED DEGREES

This program complements the Graduate Certificate in Dynamic Effects and Lighting (ICDL). Classes for both programs are delivered at the Rising Sun Pictures studios in Adelaide.

PROGRAM STRUCTURE

Visual Effects Professional Practice
 Plate Preparation Techniques
 Introduction to 3D Tracking
 Compositing Production Project

Graduate Certificate in FILM AND TELEVISION MCFT

M 0.5 unisa.edu.au/film-tv

ENTRY

CRICOS code* O95897A
 Fees*(indicative 2019) A\$33,100 pa
 IELTS Total 6.5
 IELTS Reading 6.5
 IELTS Writing 6.5
 Start date February, July

*See pages 67–69 for details

Study a one-of-a-kind qualification unique to Australia, and kick-start your career in film and television.

Connect with industry partners and develop your technical skills working alongside award-winning professionals.

Explore key areas such as idea generation, the production cycle, budgeting, marketing, finance and more.

Learn in state-of-the-art studios featuring the latest industry equipment and technologies.

Graduate with a professional portfolio of work.

CAREER OPPORTUNITIES

- Film/video editor
- Location manager
- TV producer
- Screenwriter
- Cinematographer
- Production designer

ENTRY REQUIREMENTS

- Bachelor degree from a recognised higher education institution in film, television or a related discipline; or
- Advanced Diploma in Screen and Media or equivalent qualification from an accredited Registered Training Organisation.

Applicants are also required to submit a showreel of their own work and a curriculum vitae outlining their relevant experience.

Alternatively, applications will be considered from graduates holding a completed bachelor degree from a recognised higher education institution in an unrelated field who are able to demonstrate substantial experience in film and/or television, in their showreel and curriculum vitae submissions.

PROGRAM STRUCTURE

The Screen Industry: Business, Creativity and Content
 Screen Content Project 1
 Screen Content Project 2
 Professional Film and Television Practice

EDUCATION

The School of Education has a long and respected history of producing world-class teachers and leaders within the education sector. Our programs offer you the opportunity to follow a highly rewarding career path, working with young people who will shape the future.

FEATURED PROGRAMS

- Master of Teaching (Early Childhood)
- Master of Teaching (Primary)
- Master of Teaching (Secondary)
- Master of Education (TESOL)

WE ALSO OFFER

- Graduate Diploma in Education (Islamic Education)
- Graduate Diploma in Education Studies (Digital Learning)

For more information visit:
unisa.edu.au/study

SOUTH AUSTRALIA'S

**LARGEST
TERTIARY
SCHOOL FOR
EDUCATION**

**WORLD-CLASS
RESEARCH IN**

EDUCATION SYSTEMS

SPECIALIST STUDIES
IN EDUCATION

CURRICULUM

PEDAGOGY

2015 Excellence
in Research for
Australia (ERA)

IMPORTANT NOTICE

ENTRY REQUIREMENTS

In accordance with national teacher education program standards, applicants must also fulfil non-academic entry requirements.

Applicants for the Master of Teaching (all specialisations) are required to submit a 400-word (maximum) Education Statement, which speaks to your motivation to be a teacher.

PLACEMENT REQUIREMENTS

In the lead-up to each professional experience placement you need to ensure that a number of important prerequisites and requirements are completed or satisfied, including:

- a Department of Communities and Social Inclusion (DCSI) Clearance;
- completing Mandatory Child-Safe Environments Training; and
- meeting required standards in the national Literacy and Numeracy Test for Initial Teacher Education (LANTITE) – to be completed during your studies.

For more information about entry and placement requirements visit:

unisa.edu.au/eds-requirements

Master of

TEACHING (EARLY CHILDHOOD) ^{MMET}

 unisa.edu.au/education

ENTRY

| | |
|------------------------|--------------|
| CRICOS code* | 077214E |
| Fees*(indicative 2019) | A\$28,900 pa |
| IELTS Total | 7.0 |
| IELTS Reading | 7.0 |
| IELTS Writing | 7.0 |
| IELTS Listening | 7.0 |
| IELTS Speaking | 7.0 |
| Start date | February |

*See pages 67–69 for details

Build a rewarding career in teaching focusing on the education of children from birth to eight years of age.

Learn about the emotional, social, cognitive and physical development of early childhood learning.

Take the opportunity to complete extra English language tuition prior to your placements.

Gain practical experience with supervised field placements starting in your first year of study.

Discover our on campus Samsung SMARTSchool as it transforms teacher education.

Benefit from flexible learning options including a trimester program structure, part-time study and some online courses.

CAREER OPPORTUNITIES

- Childcare teacher
- Kindergarten teacher
- Preschool teacher
- Junior primary teacher

PROFESSIONAL ACCREDITATION

Graduates can apply for teacher registration in South Australia, interstate and some overseas countries. Applicants should note that there are other criteria determining eligibility for registration by the Teachers Registration Board of South Australia and other registration and regulatory authorities.

This program has also been approved by the Australian Children's Education and Care Quality Authority (ACECQA).

ENTRY REQUIREMENTS

- Bachelor degree or equivalent qualification from a recognised higher education institution with a minimum Grade Point Average (GPA) of 4; and
- One-year full-time equivalent study, as part of the bachelor degree or equivalent qualification, relevant to one or more Learning Areas of the primary school curriculum (Arts, English, Health and Physical Education, Humanities and Social Sciences, Languages, Mathematics, Science, Technologies), which includes a minimum half a year of equivalent study relevant to one of the Learning Areas of the primary school curriculum.

Note: Entry into this program is competitive and based on academic merit. Please see page 48 for additional requirements.

RELATED DEGREES

- Master of Teaching (Primary)
- Master of Teaching (Secondary)
- Master of Education (TESOL)

FURTHER STUDY

- Masters by Research
- Doctor of Education
- Doctor of Philosophy

PROGRAM STRUCTURE

| FIRST YEAR |
|---|
| English Education (Junior Primary) |
| Mathematics and Science Education (Years R–2) |
| Curriculum and Pedagogy 1 (HASS and Technologies) |
| Curriculum and Pedagogy 2 (Arts and Health and PE) |
| Early Childhood Professional Experience and Reflection 1 (Junior Primary A) |
| Play, Learning and Development |
| Mathematical Thinking and Numeracy |
| Critical Perspectives of Education |
| Foundations of Learning and Development: A Child Centred Approach |
| Early Childhood Professional Experience and Reflection 2 (Infant and Toddler) |
| SECOND YEAR |
| Mathematics and Science Education (Early Childhood Education) |
| English Education (Early Childhood Education) |
| Early Childhood Professional Experience and Reflection 3 (Junior Primary B) |
| Curriculum Specialisation |
| Early Childhood Professional Experience and Reflection 4 (Preschool) |

Master of

TEACHING (PRIMARY) ^{MMET}

 unisa.edu.au/education

ENTRY

| | |
|------------------------|--------------|
| CRICOS code* | 077215D |
| Fees*(indicative 2019) | A\$28,900 pa |
| IELTS Total | 7.0 |
| IELTS Reading | 7.0 |
| IELTS Writing | 7.0 |
| IELTS Listening | 7.0 |
| IELTS Speaking | 7.0 |
| Start date | February |

*See pages 67–69 for details

Focus solely on the education of children from Reception to Year 7.

Learn specifically about primary learning, curriculum studies and pedagogy.

Examine the developmental, emotional, social and psychological needs of primary learners.

Gain practical experience with supervised field placements starting in your first year of study.

Take the opportunity to complete extra English language tuition prior to your placements.

Discover our on campus Samsung SMARTSchool as it transforms teacher education.

Benefit from flexible learning options including a trimester program structure, part-time study and some online courses.

CAREER OPPORTUNITIES

- Primary teacher
- Junior primary teacher

PROFESSIONAL ACCREDITATION

Graduates can apply for teacher registration in South Australia, interstate and some overseas countries. Applicants should note that there are other criteria determining eligibility for registration by the Teachers Registration Board of South Australia and other registration and regulatory authorities.

ENTRY REQUIREMENTS

- Bachelor degree or equivalent qualification from a recognised higher education institution with a minimum Grade Point Average (GPA) of 4; and
- One-year full-time equivalent study, as part of the bachelor degree or equivalent qualification, relevant to one or more Learning Areas of the primary school curriculum (Arts, English, Health and Physical Education, Humanities and Social Sciences, Languages, Mathematics, Science, Technologies), which includes a minimum half a year of equivalent study relevant to one of the Learning Areas of the primary school curriculum.

Note: Entry into this program is competitive and based on academic merit. Please see page 48 for additional requirements.

RELATED DEGREES

- Master of Teaching (Early Childhood)
- Master of Teaching (Secondary)
- Master of Education (TESOL)

FURTHER STUDY

- Masters by Research
- Doctor of Education
- Doctor of Philosophy

PROGRAM STRUCTURE

| FIRST YEAR |
|---|
| English Education (Junior Primary) |
| Mathematics and Science Education (Years R–2) |
| Curriculum and Pedagogy 1 (HASS and Technologies) |
| Curriculum and Pedagogy 2 (Arts and Health and PE) |
| Reflexive Practice and Professional Experience 1 |
| Mathematical Thinking and Numeracy |
| Curriculum and Pedagogy 3 (Arts and Technologies) |
| Critical Perspectives of Education |
| Foundations of Learning and Development: A Child Centred Approach |
| SECOND YEAR |
| Mathematics and Science Education (Years 3–7) |
| English Education (Primary) |
| Curriculum and Pedagogy 4 (HASS and Health and PE) |
| Curriculum Specialisation |
| Reflexive Practice and Professional Experience 2 |

Master of

TEACHING (SECONDARY) MMET

 unisa.edu.au/education

ENTRY

| | |
|------------------------|----------------|
| CRICOS code* | O77217B |
| Fees*(indicative 2019) | A\$28,900 pa |
| IELTS Total | 7.0 |
| IELTS Reading | 7.0 |
| IELTS Writing | 7.0 |
| IELTS Listening | 7.0 |
| IELTS Speaking | 7.0 |
| Start date | February, July |

**See pages 67–69 for details*

Focus on the learning and planning needs of adolescent students from Year 8 to Year 12.

Tailor your studies by specialising in two Learning Areas aligned with the Australian Curriculum.

Gain practical experience with supervised field placements starting in your first year of study.

Take the opportunity to complete extra English language tuition prior to your placements.

Benefit from flexible learning options including a trimester program structure, part-time study and some online courses.

LEARNING AREAS

- Arts
- English
- Design and Technology
- Mathematics
- Health and Physical Education
- Humanities and Social Sciences
- Languages
- Science

Students can also undertake courses in *Catholic Studies* or *TESOL* and a *minor in Islamic Pedagogy*.

CAREER OPPORTUNITIES

- Secondary school teacher
- Curriculum developer

PROFESSIONAL ACCREDITATION

Graduates can apply for teacher registration in South Australia, interstate and some overseas countries. Applicants should note that there are other criteria determining eligibility for registration by the Teachers Registration Board of South Australia and other registration and regulatory authorities.

ENTRY REQUIREMENTS

- Bachelor degree or equivalent qualification from a recognised higher education institution with a minimum Grade Point Average (GPA) of 4; and
- A major and preferably a minor in the intended specialisation Learning Area, aligning with the Australian Curriculum. Majors consist of a minimum of six courses (27 units) or equivalent with a minimum of two courses at Australian second year undergraduate level or equivalent. Minors consists of a minimum four courses (18 units) or equivalent with a minimum of two courses at Australian second year undergraduate level or equivalent.

Note: Entry into this program is competitive and based on academic merit. Please see page 48 for additional requirements.

RELATED DEGREES

- Master of Teaching (Early Childhood)
- Master of Teaching (Primary)

FURTHER STUDY

- Masters by Research
- Doctor of Education
- Doctor of Philosophy

PROGRAM STRUCTURE

FIRST YEAR

Learning Area 1.1
Learning Area 2.1
Middle Years of Schooling
Critical Perspectives on Curriculum, Pedagogy and Assessment

Reflexive Practice and Professional Experience 1
Learning Area 1.2
Critical Perspectives of Education
Middle Schooling Pedagogies
Foundations of Learning and Development: A Child Centred Approach

SECOND YEAR

Learning Area 1.3
Learning Area 2.2
Elective
Curriculum Specialisation
Reflexive Practice and Professional Experience 2

Master of

EDUCATION (TESOL) MMTL

 unisa.edu.au/education

ENTRY

| | |
|------------------------|----------------|
| CRICOS code* | O82450F |
| Fees*(indicative 2019) | A\$28,900 pa |
| IELTS Total | 6.5 |
| IELTS Reading | 6.0 |
| IELTS Writing | 6.0 |
| Start date | February, July |

**See pages 67–69 for details*

Broaden your career prospects with a specialisation in teaching English to speakers of other languages.

Learn about recent developments in theories, research, debates and practices regarding the teaching of English as an additional language.

Build a career teaching the English language in a variety of settings from preschool to adult and tertiary learning.

Tailor your program by choosing either a research stream or a professional practice stream in your second year.

CAREER OPPORTUNITIES

- English language educator
- Curriculum developer
- Educational leader

ENTRY REQUIREMENTS

Bachelor degree in any discipline or equivalent qualification from a recognised higher education institution.

Some applicants may be eligible for Advanced Standing and can complete the program in 1.0 or 1.5 years full-time study or equivalent part-time study.

Note: This program does not meet the criteria to apply for teacher registration.

RELATED DEGREES

- Graduate Diploma in Education (Islamic Education)
- Graduate Diploma in Education Studies (Digital Learning)
- Master of Teaching (Early Childhood)
- Master of Teaching (Primary)
- Master of Teaching (Secondary)

FURTHER STUDY

- Masters by Research
- Doctor of Education
- Doctor of Philosophy

PROGRAM STRUCTURE

FIRST YEAR

Theorists and Theories of Learning and Development
Learning Communities and Cultures
Learning an Additional Language
Language and Culture in TESOL

TESOL Approaches and Strategies
Teaching and Language Assessment in TESOL

International Comparative Studies in Education
Evidence-Informed Practice in Education

SECOND YEAR

Curriculum Development in TESOL
Language Learning in TESOL: Learner Identity and Difference
Research Methods and Issues in Education

Curriculum and Evaluation in TESOL
Critical Reflection on TESOL Practice
Project in Education

“

A partnership between the Australian Technology Network of Universities (of which the University is a member) and the Ministry of Religious Affairs in Indonesia gave Fuad the opportunity to undertake his PhD at the University of South Australia.

Fuad started his university studies with a focus on teaching English as a second or foreign language and is now exploring the field of education even further. He says anyone who decides to study at the University will not be disappointed.

“There is an abundance of resources, considerate supervisors and lots of on campus events. The support services specifically for international students are also very good.

“Career development opportunities are also available through workshops and networking events.”

”

Fuad Fudiyartanto / PhD CANDIDATE



PSYCHOLOGY, SOCIAL WORK AND HUMAN SERVICES

A unique meeting place of the social sciences, the School of Psychology, Social Work and Social Policy offers cross-disciplinary studies and accredited professional degrees. Gain real experience and learn in state-of-the-art facilities, including practical social work studios, our Cognitive Neuroscience Laboratory, Cognitive Ageing Impairment Neurosciences Laboratory, and on campus Psychology Clinic.

FEATURED PROGRAMS

- Master of Social Work

WE ALSO OFFER

- Masters by Research
- Doctor of Philosophy

For more information visit:
unisa.edu.au/study

LEARN IN PURPOSE-BUILT

**SOCIAL WORK
STUDIOS**

ON CAMPUS

**ABOVE
WORLD
STANDARD
RESEARCH**

**IN PSYCHOLOGY
AND SOCIAL WORK**

2015 Excellence
in Research for
Australia (ERA)

Master of SOCIAL WORK MMSK

M 2 unisa.edu.au/socialwork

ENTRY

| | |
|------------------------|--------------|
| CRICOS code* | O64242G |
| Fees*(indicative 2019) | A\$28,900 pa |
| IELTS Total | 7.0 |
| IELTS Reading | 7.0 |
| IELTS Writing | 7.0 |
| IELTS Listening | 7.0 |
| IELTS Speaking | 7.0 |
| Start date | February |

*See pages 67–69 for details

Graduate with advanced knowledge and understanding of current social issues and social work practice.

Focus on key learning areas such as social work values, ethics and identity, human rights, mental health, child protection and cross-cultural practice.

Develop critical research skills and the ability to review and analyse information.

Learn in our purpose-built social work studios located on campus.

Gain practical experience and build your networks through supervised local, rural and international work placements.

CAREER OPPORTUNITIES

- Aged care worker
- Child and youth welfare officer
- Community development officer
- Disability worker
- Rehabilitation officer
- Healthcare worker
- Court services officer
- Cultural diversity officer
- Social planner
- Social worker

IMPORTANT INFORMATION

Students will be required to obtain a National Police Clearance and a current National Criminal History Check (Child-Related Clearance) from the Department for Communities and Social Inclusion (DCSI). You must also hold a current Child Safe Environments Certificate. Some placements may also require a current driver's licence and a recognised First Aid Certificate.

PROFESSIONAL RECOGNITION

Graduates are eligible for membership with the Australian Association of Social Workers (AASW).

ENTRY REQUIREMENTS

Bachelor degree or master level qualification in a related discipline (including, but not limited to, human services, community services, social science, psychology, Australian Indigenous or Aboriginal studies, public or community health) from a recognised higher education institution, or equivalent qualification.

Note: Applicants holding a completed Australian bachelor or master level qualification in social work are not eligible for entry into this program.

PROGRAM STRUCTURE

FIRST YEAR

Effective Human Service Delivery
Contemporary Practice Theories for
Social Work
Social Work Practice Skills
AND
Elective
OR
Social Work in the Australian Context

Social Work Practicum 1
Ethical Decision Making

SECOND YEAR

Innovation and Research
Innovative Social Work Practice with
Children and Families
Mental Health and Social Work Practice
Human Rights Based Practice and
Community Development

Leadership in Social Work
Social Work Practicum 2

HEALTH AND MEDICAL SCIENCES

Healthcare workers are in peak demand around the world. Contribute to science-based prevention, diagnosis and treatment of health-related issues through our diverse range of postgraduate qualifications. Gain access to interactive, state-of-the-art learning environments, the latest research and practice, respected clinical teaching staff and industry placements.

FEATURED PROGRAMS

- Master of Health Services Management
- Graduate Certificate in Nursing (Bridging and Re-entry)
- Master of Nursing
- Master of Advanced Clinical Physiotherapy (Musculoskeletal)
- Master of Advanced Clinical Physiotherapy (Sports)

WE ALSO OFFER

- Graduate Certificate in Population Health Practice
- Graduate Certificate in Breast Imaging
- Graduate Diploma in Medical Sonography
- Master of Occupational Therapy (Graduate Entry)
- Master of Physiotherapy (Graduate Entry)
- Master of Medical Sonography
- Master of Clinical Pharmacy
- Master of Research (Population Health Practice)

For more information visit:
unisa.edu.au/study

**WORLD
TOP 50**

IN NURSING

2017 QS Subject
Rankings

LEARN IN

**PURPOSE-BUILT
LABORATORIES
ON CAMPUS**

Campus: CE: City East, CW: City West, M: Magill, or ML: Mawson Lakes 
Full-time program duration in years 
Quota applies 

Master of HEALTH SERVICES MANAGEMENT IMHM

  unisa.edu.au/health-services-management

ENTRY

CRICOS code* O96783C
Fees*(indicative 2018) ... A\$26,500 pa^
IELTS Total 6.5
IELTS Writing 6.5
IELTS Speaking 6.5
Start date February

*See pages 67–69 for details

^2019 fee subject to change

Advance into leadership and management positions across the diverse health and ageing sectors.

Learn a unique blend of health and business courses for a contemporary health management focus.

Partner with industry and complete a major project targeting real-world health management issues.

Benefit from flexible study options through online and on campus learning so you can advance your career while you study.

CAREER OPPORTUNITIES

This qualification will endorse health professionals for leadership and management positions, including roles such as:

- Clinical director
- Practice manager
- Aged care facility manager
- Health and welfare services manager
- Medical/hospital administrator

ENTRY REQUIREMENTS

Bachelor degree from a recognised higher education institution. Some applicants may be eligible for Advanced Standing and can complete the program in 1.5 years full-time study or equivalent part-time study.

RELATED DEGREES

- Master of Nursing
- Master of Management
- Master of Business Administration

FURTHER STUDY

- Masters by Research
- Doctor of Philosophy

PROGRAM STRUCTURE

FIRST YEAR

Business Analytics and the Data-driven Organisation
Accounting for Health Management
Foundations of Public Health
Epidemiology
Workplace Health and Safety Management

Workplace Learning and Development
Managing Change
People, Leadership and Performance
Evaluation in Public and Community Health

SECOND YEAR

Service Management
Project Management for Business
Business Ethics
Responsible Leadership in Health

Performance Review and Health Economics
Health Ethics
Capstone in Health Services Management

NURSING (BRIDGING AND RE-ENTRY) ICNB

CE 0.5 unisa.edu.au/nursing-midwifery

ENTRY

| | |
|------------------------|---------------------|
| CRICOS code* | 084729G |
| Fees*(indicative 2019) | A\$37,500 pa |
| IELTS Total | 7.0 |
| IELTS Reading | 7.0 |
| IELTS Writing | 7.0 |
| IELTS Listening | 7.0 |
| IELTS Speaking | 7.0 |
| Start date | February, September |

*See pages 67–69 for details

Note: This program is for registered nurses who hold an overseas degree and wish to enter the Australian workforce.

Develop the practical skills and knowledge needed to work as a Registered Nurse in Australia.

Learn about the Australian healthcare and legal systems, along with nursing ethics, mental healthcare, Aboriginal health, aged care and nursing research.

Focus on nursing practice through courses in primary healthcare, physical examination, standard precautions and professional communication.

Build your knowledge in pharmacological principles, and respiratory, cardiac, neurological, endocrine, urinary/renal, gastrointestinal and musculoskeletal systems.

Complete a supervised eight-week clinical placement and learn in our unique, clinician-led simulated hospital setting on campus.

IMPORTANT INFORMATION

On entry to the program, applicants must meet 'Fitness to Practice in Clinical Placements' requirements.

CAREER OPPORTUNITIES

Registered Nurses can work in a variety of healthcare settings, including:

- Hospitals
- Primary health and community support services
- Aged/rehabilitative care
- Schools
- Home care
- Drug/alcohol services
- Community health organisations
- Palliative care services
- Child and adolescent health services

PROFESSIONAL ACCREDITATION

Graduates will be eligible to apply for registration as a Registered Nurse with the Nursing and Midwifery Board of Australia (NMBA).

ENTRY REQUIREMENTS

- Registration with the relevant Nurse Registration Authority in your country or place of residence; and
- Bachelor degree in nursing commensurate with the standard of Registered Nurse preparation in Australia (minimum equivalence of Australian Qualifications Framework (AQF) Level 7); and
- Minimum two years' work experience with 12 months recent practice (within the last two years) as a Registered Nurse in country of practice, evidenced by a certified employment statement dated in the last six months; and
- Letter of approval from the Australian Health Professional Regulation Agency (AHPRA) on behalf of the Nursing and Midwifery Board of Australia (NMBA) to undertake a NMBA approved bridging program.

FURTHER STUDY

- Master of Nursing
- Master of Health Services Management
- Masters by Research
- Doctor of Philosophy

PROGRAM STRUCTURE

| |
|---|
| Professional Issues and Nursing Practice in Australia |
| Transition to Registered Nurse Practice in Australia |

NURSING IMNI

CE 1.5 unisa.edu.au/nursing-midwifery

ENTRY

| | |
|------------------------|--------------|
| CRICOS code* | 046395G |
| Fees*(indicative 2019) | A\$31,000 pa |
| IELTS Total | 6.5 |
| IELTS Reading | 6.5 |
| IELTS Writing | 6.5 |
| IELTS Listening | 6.5 |
| IELTS Speaking | 6.5 |
| Start date | February |

*See pages 67–69 for details

Broaden your career prospects by extending your knowledge, practical skills and understanding of evidence-based practice.

Prepare yourself for senior leadership roles in clinical practice, policy, research, education or management.

Identify and investigate questions, issues and challenges that will improve and inform healthcare practice, knowledge and research.

Develop your ability to independently undertake research and learn about global issues, trends and practices that impact the delivery of nursing and health services.

CAREER OPPORTUNITIES

This program is designed for registered nurses seeking to further their qualifications and can lead to senior roles in:

- Leadership and governance
- Healthcare policy
- Research
- Education
- Management

ENTRY REQUIREMENTS

- Bachelor degree or higher in nursing from a recognised higher education institution; and
- Minimum Grade Point Average (GPA) of 5 or international equivalent.

Applicants must also be eligible to be licensed to practice as a Registered Nurse in their own country or place of residence and have completed a minimum of two years' clinical experience as a Registered Nurse.

FURTHER STUDY

- Masters by Research
- Doctor of Philosophy

PROGRAM STRUCTURE

FIRST YEAR

| |
|--|
| Critical Perspectives on Nursing and Health Services |
| Research for Advancing Nursing, Midwifery and Health Care |
| Nursing or Midwifery Minor Thesis 1 |
| Qualitative Design for Nursing, Midwifery and Health Research |
| Quantitative Design for Nursing, Midwifery and Health Research |

SECOND YEAR

| |
|--|
| Nursing or Midwifery Minor Thesis 2 |
| Leadership and Management in Nursing and Health Contexts |

Master of

ADVANCED CLINICAL PHYSIOTHERAPY IMAP

DEGREES

- Master of Advanced Clinical Physiotherapy (Musculoskeletal)
- Master of Advanced Clinical Physiotherapy (Sports)

CE **1** unisa.edu.au/physiotherapy

ENTRY

CRICOS code*.....varies
 Fees*(indicative 2019).....A\$37,500 pa
 IELTS Total.....7.0
 IELTS Reading.....7.0
 IELTS Writing.....7.0
 IELTS Listening.....7.0
 IELTS Speaking.....7.0
 Start date.....January

*See pages 67–69 for details

Benefit from over 40 years' experience in delivering physiotherapy education.

Gain advanced skills in musculoskeletal or sports physiotherapy depending on your chosen program.

Study core areas such as pain science; change in cognitions, behaviours and lifestyles; and advanced examination across all programs.

Complete industry placements and work alongside fellow registered physiotherapists in our on campus Physiotherapy Clinic.

CAREER OPPORTUNITIES

These programs are designed for qualified physiotherapists seeking to further their qualifications, and can lead to careers in settings such as:

- Amateur and elite, national or international sports
- Hospitals
- Private practice
- Research

IMPORTANT INFORMATION

This program does not qualify students for general registration as a physiotherapist in Australia. Before commencing any clinical courses, students are required to be registered to practice physiotherapy in Australia. International students are required to obtain a 'Limited Registration' under supervision from the Australia Health Practitioner Regulation Agency (AHPRA).

PROFESSIONAL ACCREDITATION

These programs are accredited by the Australian Physiotherapy Association.

ENTRY REQUIREMENTS

- Bachelor degree in physiotherapy, or equivalent entry level qualification, from a recognised higher education institution; and
- Minimum 10 months full-time, or equivalent, physiotherapy practice in a relevant field following completion of the professional entry level qualification; and
- Met the requirements for eligibility for registration as a physiotherapist, or limited registration under supervision, with AHPRA (see Important Information).

FURTHER STUDY

- Masters by Research
- Doctor of Philosophy

PROGRAM STRUCTURE

INDICATIVE OF MUSCULOSKELETAL

FIRST SEMESTER

Allied Health Research Evidence Translation
 Musculoskeletal Physiotherapy Theory and Practice 1
 Musculoskeletal Physiotherapy Theory and Practice 2
 Pain Mechanisms

SECOND SEMESTER

Pain Assessment, Rehabilitation and Management
 Facilitating Change
 Advanced Physiotherapy Practice 1
 Advanced Physiotherapy Practice 2



Anuja took a break from a successful physiotherapy career in India to pursue postgraduate studies in Australia, a learning experience she says she will always cherish.

“The syllabus is well planned and well taught with a great balance of teaching experience, clinical work and research. There is no better combination for aspiring physiotherapists.

“I did two hospital placements and a football placement – the experience of supervised practice is what has made me a better practitioner.”

Anuja is now a consultant developing programs to help the next generation of physiotherapists in India and also runs her own physiotherapy business.

Anuja Dalvi / MASTER OF ADVANCED
CLINICAL PHYSIOTHERAPY

DATA AND INFORMATION MANAGEMENT

Our industry and research experts are at the forefront of the digital frontier. Our graduates connect with digital resources from around the world to explore and better inform big data decisions. Our postgraduate programs meet the demand for data-driven skills and technical capabilities to address global challenges in information sharing, storage and security.

FEATURED PROGRAMS

- Master of Information Technology (Enterprise Management)
- Master of Cybersecurity
- Master of Data Science

WE ALSO OFFER

- Graduate Certificate in Information Technology
- Graduate Certificate in Data Science
- Graduate Certificate in Information Management
- Graduate Diploma in Information Technology (Enterprise Management)
- Graduate Diploma in Information Technology
- Graduate Diploma in Data Science
- Graduate Diploma in Information Management (Archives and Records Management)
- Graduate Diploma in Information Management (Library and Information Management)
- Master of Information Management (Archives and Records Management)
- Master of Information Management (Library and Information Management)

For more information visit:
unisa.edu.au/study

LEAD INSTITUTION IN

**\$88 MILLION DATA
TO DECISIONS**

COOPERATIVE RESEARCH CENTRE (CRC)

WORLD-CLASS RESEARCH IN

ARTIFICIAL INTELLIGENCE

COMPUTING AND
INFORMATION SYSTEMS

2015 Excellence in Research for Australia (ERA)

Master of

INFORMATION TECHNOLOGY (ENTERPRISE MANAGEMENT) LMIG

NESTED WITH

- Graduate Certificate in Information Management (LCIG)
- Graduate Diploma in Information Technology (Enterprise Management) (LGIG)

ML 2 unisa.edu.au/IT

ENTRY

| | |
|------------------------------|----------------|
| CRICOS code* | O81872C |
| Fees*(indicative 2019) | A\$31,000 pa |
| IELTS Total | 6.5 |
| IELTS Reading | 6.0 |
| IELTS Writing | 6.0 |
| IELTS Listening | 6.0 |
| IELTS Speaking | 6.0 |
| Start date | February, July |

*See pages 67–69 for details

Get up to speed with the latest trends and developments in enterprise-wide IT.

Learn the critical systems analysis and design skills required of a business analyst.

Focus on business intelligence along with the daily operation and management of complex information systems.

Develop project management expertise and the skills to liaise with key stakeholders in an IT context.

Choose to tailor your studies through a wide-range of elective courses in information systems, information technology, business and management.

Complete a major project in your final year working with a structured project team.

CAREER OPPORTUNITIES

- Software programmer
- Applications programmer
- Business and systems analyst
- ICT manager
- ICT network and support manager
- Solutions architect

PROFESSIONAL ACCREDITATION

This program is professionally accredited by the Australian Computer Society.

ENTRY REQUIREMENTS

- Bachelor degree in any discipline from a recognised higher education institution or equivalent qualification; or
- Graduate Certificate in Information Technology, or equivalent qualification, from a recognised higher education institution; or
- Graduate Diploma in Information Technology, or equivalent qualification, from a recognised higher education institution.

RELATED DEGREES

- Master of Data Science
- Master of Cybersecurity

PROGRAM STRUCTURE

FIRST YEAR

IT Concepts
Business Practices for IT Professionals
Project Management for IT Professionals
Business Systems Analysis

Business Intelligence and Analytics
Security Principles
Professional Communication
Elective 1

SECOND YEAR

Research Methods
Business Process Modelling
IT Stakeholder Engagement
Elective 2

Enterprise Architecture
Information Governance
Capstone Professional Project

Master of CYBERSECURITY LMCY

ML 2 unisa.edu.au/IT

ENTRY

CRICOS code* O92659F
Fees*(indicative 2019) A\$32,000 pa
IELTS Total 6.5
IELTS Reading 6.0
IELTS Writing 6.0
Start date February, July

*See pages 67–69 for details

Join a growing industry tasked with protecting critical IT infrastructure and information.

Study technical topics such as web and network security, digital forensics, identity management and access control.

Apply technical skills to organisational contexts with a focus on risk management and incident response.

Devise and implement a defence strategy for a complex enterprise environment in a final-year cybersecurity exercise.

Connect with the University's Innovation and Collaboration Centre and access industry expertise in technology, design, business growth, management, marketing and commercialisation.

CAREER OPPORTUNITIES

- Cybersecurity consultant
- Information security analyst
- System security engineer
- System security architect

ENTRY REQUIREMENTS

Bachelor degree or equivalent qualification in information technology or a related discipline.

Note: Applicants who have completed a bachelor degree or higher in any discipline may also be considered for entry based upon their IT expertise gained through formal tertiary studies and/or relevant work experience. These applicants are required to submit a detailed curriculum vitae and may be required to attend an interview, either in-person or online.

RELATED DEGREES

- Master of Data Science
- Master of Information Technology (Enterprise Management)

PROGRAM STRUCTURE

FIRST YEAR

IT Concepts
Network Infrastructure
Security Principles
Security Operations
Research Methods
Network Security
Operating Systems and Application Security
Web and Cloud Security

SECOND YEAR

Digital Forensics Essentials
Industrial Internet Security
Enterprise Security
Cybersecurity Planning and Compliance
Security Consultancy
Security Architecture
Capstone Professional Project

Master of DATA SCIENCE LMDS

NESTED WITH

- Graduate Certificate in Data Science (LCDS)
- Graduate Diploma in Data Science (LGDS)

ML 2 unisa.edu.au/IT

ENTRY

CRICOS code* O79912G
Fees*(indicative 2019) A\$33,100 pa
IELTS Total 6.5
IELTS Reading 6.0
IELTS Writing 6.0
Start date February, July

*See pages 67–69 for details

Enter the revolutionary field of big data where there is a growing demand for qualified data scientists.

Build strong foundation skills in data and statistics such as big data basics, statistical programming, and relational database systems and warehouses.

Learn to analyse and visualise rich data sources, how to spot data trends, and to generate data management strategies.

Complete coursework designed with industry including the Institute of Analytics Professionals of Australia and the leader in business analytics and software – SAS.

Undertake a professional project in your final year, gaining practical experience in modern data techniques and practices.

CAREER OPPORTUNITIES

- Big data visualiser
- Data scientist
- Business data analyst
- Information security analyst

ENTRY REQUIREMENTS

- Bachelor degree in information technology or mathematics from a recognised higher education institution; or
- Graduate diploma or graduate certificate in data science from a recognised higher education institution.

RELATED DEGREES

- Master of Cybersecurity
- Master of Information Technology (Enterprise Management)

PROGRAM STRUCTURE

FIRST YEAR

Big Data Basics
Statistical Programming for Data Science
Two of the following four courses:
• Statistics for Data Science
• Probabilities and Data
• Relational Databases and Warehouses
• Business Intelligence and Analytics

Predictive Analytics
Unsupervised Methods in Analytics
Research Methods
Data Visualisation

SECOND YEAR

Social Media Data Analytics
Customer Analytics in Large Organisations
Data Science Professional Development 2
Advanced Analytic Techniques 1
Advanced Analytic Techniques 2
Capstone Professional Project

“

Ujala hopes to share the knowledge he has gained in Adelaide about sustainable energy to help his home country, India, address the challenges of global warming.

“Being in Adelaide and studying engineering management has taught me a lot about using energy in a sustainable way.

“The courses here are very practical and innovative so it’s easy to see how to apply the theory to real life.”

Ujala has already had the chance to work in his field, after being employed by the University to undertake a research project.

”

Ujala Sinha / MASTER OF ENGINEERING
(ENGINEERING MANAGEMENT)



ENGINEERING

Turn ideas into action and inspire the next wave of engineering and new technologies. Get the advantage of theoretical and experience-based learning, including placements, studying in cutting-edge facilities and partnering with industry to meet the challenges of modern enterprise.

FEATURED PROGRAMS

- Master of Engineering (Engineering Management)
- Master of Engineering (Electrical Power)
- Master of Engineering (Telecommunications)
- Master of Engineering (Civil and Infrastructure)
- Master of Engineering (Water Resource Management)

WE ALSO OFFER

- Graduate Certificate in Organisational Safety and Human Factors
- Graduate Diploma in Engineering (Engineering Management)
- Graduate Diploma in Human Factors and Safety Management Systems
- Graduate Diploma in Organisational Safety Management
- Master of Applied Project Management

For more information visit:
unisa.edu.au/study

**WELL-ABOVE
WORLD STANDARD
RESEARCH**

IN ENGINEERING

2015
Excellence
in Research
for Australia
(ERA)

**HOME TO THE
MULTI-MILLION DOLLAR**

**FUTURE
INDUSTRIES
INSITU**

Campus: CE: City East, CW: City West, M: Magill, or ML: Mawson Lakes 
Full-time program duration in years
Quota applies

Master of

ENGINEERING (ENGINEERING MANAGEMENT) LMEB

NESTED WITH

- Graduate Diploma in Engineering (Engineering Management) (LGEB)

  unisa.edu.au/engineering

ENTRY

CRICOS code* O77355C
Fees* (indicative 2019) A\$35,100 pa
IELTS Total 6.5
IELTS Reading 6.0
IELTS Writing 6.0
Start date February, July

*See pages 67–69 for details

Learn about managing the operations of an engineering organisation.

Tailor your studies through a wide-range of electives in quality management, project planning and control, intelligent production systems and energy management.

Develop your understanding of the strategic management of engineering operations including supply chain, enterprise resource, and economic management.

Complete a practical industry project in your own area of interest or a minor thesis related to one of the University's research concentrations.

RELATED DEGREES

- Master of Engineering (Electrical Power)
- Master of Engineering (Telecommunications)
- Master of Engineering (Civil and Infrastructure)
- Master of Engineering (Water Resource Management)

PROGRAM STRUCTURE

FIRST YEAR

Professional Engineering Practice E
3 x Electives

Engineering Research Practice
3 x Electives

SECOND YEAR

Engineering Economic Analysis
Enterprise Resource Planning
Minor Thesis 1 (Eng)

Supply Chain Management G
Operations Management Systems
Minor Thesis 2 (Eng)

CAREER OPPORTUNITIES

- Energy manager
- Engineering operations manager
- Quality assurance manager
- Business development engineer

ENTRY REQUIREMENTS

- Bachelor degree in engineering, science or technology from a recognised higher education institution; or
- Graduate certificate or graduate diploma in engineering from a recognised higher education institution.

Master of

ENGINEERING (ELECTRICAL POWER) LMEL

ML 2 unisa.edu.au/engineering

ENTRY

CRICOS code* 079908C
Fees* (indicative 2019) A\$35,100 pa
IELTS Total 6.5
IELTS Reading 6.0
IELTS Writing 6.0
Start date February, July

*See pages 67–69 for details

Develop advanced knowledge in engineering theory and practice with a focus on information and communication technologies, and electrical engineering.

Specialise in electrical power studying modern power systems, renewable and distributed energy generation, and advanced machine modelling.

Complete a research project and a minor engineering thesis as part of your studies.

Learn in purpose-built facilities on campus and be supported by world-class researchers and academics.

CAREER OPPORTUNITIES

- Electrical engineer
- Energy researcher
- Engineering operations manager
- Renewable energy development manager

ENTRY REQUIREMENTS

Bachelor degree in electrical engineering, or a related discipline, or equivalent qualification.

Note: Entry is competitive and experience in engineering and information technology, along with completion of professional qualifications will be taken into account.

RELATED DEGREES

- Master of Engineering (Engineering Management)
- Master of Engineering (Telecommunications)

PROGRAM STRUCTURE

FIRST YEAR

CORE COURSES

Renewable Energy Systems UG
Power System Analysis
Engineering Research Practice

ELECTIVE COURSES

ELECTRICAL POWER SPECIALISATION COURSES

Design and Integration of Renewable Energy Systems
Operation and Control of Modern Power Systems
Power Electronics and Drives
Learning in the Workplace Project

ELECTRICAL ENGINEERING COURSES

Autonomous Mechatronic Systems
Linear Electronic Circuits
Advanced Control
Principles of Test and Evaluation N
Energy and Society

SECOND YEAR

Engineering Economic Analysis
OR
Engineering Management

CORE COURSES

Renewable and Distributed Power Generation
Advanced Electrical Machines
Advanced Power System Modelling and Analysis
Engineering Minor Thesis 1
Engineering Minor Thesis 2

Master of

ENGINEERING (TELECOMMUNICATIONS) LMEL

ML 2 unisa.edu.au/engineering

ENTRY

CRICOS code* 079909B
Fees* (indicative 2019) A\$35,100 pa
IELTS Total 6.5
IELTS Reading 6.0
IELTS Writing 6.0
Start date February, July

*See pages 67–69 for details

Develop advanced knowledge in engineering theory and practice with a focus on information and communication technologies, and electrical engineering.

Specialise in wireless and mobile communication systems, theory and coding, and telecommunications.

Complete a minor engineering thesis and a major workplace project in a key area of interest as part of your studies.

Benefit from links to the University's internationally-recognised Institute for Telecommunications Research, dedicated to developing new technologies for wireless communications.

CAREER OPPORTUNITIES

- Electrical engineer
- Network planning manager
- Telecommunications researcher
- Telecommunications development manager

ENTRY REQUIREMENTS

Bachelor degree in electrical engineering, or a related discipline, or equivalent qualification.

Note: Entry is competitive and experience in engineering and information technology, along with completion of professional qualifications will be taken into account.

RELATED DEGREES

- Master of Engineering (Engineering Management)
- Master of Engineering (Electrical Power)

PROGRAM STRUCTURE

FIRST YEAR

CORE COURSES

Communication Systems
Digital Signal Processing
Engineering Research Practice

ELECTIVE COURSES

TELECOMMUNICATIONS SPECIALISATION COURSES

Modern Communication Systems
Internet Technology
Optical Communications G
Learning in the Workplace Project

ELECTRICAL ENGINEERING COURSES

Linear Electronic Circuits
Advanced Control
Principles of Test and Evaluation N

SECOND YEAR

Engineering Economic Analysis
OR
Engineering Management

CORE COURSES

Telecommunications Networks
Mobile Communications and Wireless Access
Information Theory and Coding
Engineering Minor Thesis 1
Engineering Minor Thesis 2

Master of

ENGINEERING (CIVIL AND INFRASTRUCTURE) LMCL

  unisa.edu.au/engineering

ENTRY

CRICOS code* O88538E
 Fees*(indicative 2019) A\$35,100 pa
 IELTS Total 6.5
 IELTS Reading 6.0
 IELTS Writing 6.0
 Start date February, July
 *See pages 67–69 for details

Develop advanced knowledge in structural and geotechnical engineering.

Focus on the design and development of critical infrastructure including bridges, buildings, roads, and water and transport systems.

Benefit from links to the University's Natural and Built Environments Research Centre, focused on addressing real-world, multi-disciplinary challenges faced by industry and the wider community.

Learn in industry-standard facilities and work with the latest high-tech testing and computer modelling equipment.

CAREER OPPORTUNITIES

- Civil engineer
- Structural engineer
- Project manager
- Operations manager

ENTRY REQUIREMENTS

Bachelor degree in civil engineering, or a related discipline, or equivalent qualification. A related discipline may be other four-year engineering or science degrees.

Some applicants may be eligible for Advanced Standing and can complete the program in 1.0 or 1.5 years full-time study, or equivalent part-time study.

Note: Applicants who do not meet the standard entry requirements will be assessed on a case-by-case basis by the Program Director.

RELATED DEGREES

- Master of Engineering (Engineering Management)
- Master of Engineering (Water Resource Management)

PROGRAM STRUCTURE

FIRST YEAR

Soil Mechanics
 Steel and Timber Design
 Research Data Analysis
 Elective 1

Geotechnical Engineering
 Reinforced Concrete Design
 Advanced Soil Mechanics
 Elective 2

SECOND YEAR

Engineering Masters Design Project
 Masters Research Theory and Practice
 Elective 3

NBE Masters Research Project
 Elective 4
 Elective 5

Master of

ENGINEERING (WATER RESOURCE MANAGEMENT) LMCL

  unisa.edu.au/engineering

ENTRY

CRICOS code* O88540M
 Fees*(indicative 2019) A\$35,100 pa
 IELTS Total 6.5
 IELTS Reading 6.0
 IELTS Writing 6.0
 Start date February, July
 *See pages 67–69 for details

Study advanced water and environmental engineering theories to support our all-important waterways.

Focus on the design and development of critical water resources and management systems.

Benefit from links to the Australian Flow Management Group Laboratories, providing specialist industry services and advances in engineering hydraulics technology through applied research.

Learn in industry-standard facilities and work with the latest high-tech testing and computer modelling equipment.

CAREER OPPORTUNITIES

- Water resources engineer
- Project manager
- Operations manager

ENTRY REQUIREMENTS

Bachelor degree in civil engineering, or a related discipline, or equivalent qualification. A related discipline may be other four-year engineering or science degrees.

Some applicants may be eligible for Advanced Standing and can complete the program in 1.0 or 1.5 years full-time study, or equivalent part-time study.

Note: Applicants who do not meet the standard entry requirements will be assessed on a case-by-case basis by the Program Director.

RELATED DEGREES

- Master of Engineering (Engineering Management)
- Master of Engineering (Civil and Structural)

PROGRAM STRUCTURE

FIRST YEAR

Soil Mechanics
 Hydraulics and Hydrology
 Research Data Analysis
 Geographical Information Systems and Analysis

Water Resources Systems Design
 Geotechnical Engineering
 Surface Water Hydrology
 Elective 1

SECOND YEAR

Masters Research Theory and Practice
 Engineering Masters Design Project
 Elective 2

NBE Masters Research Project
 Elective 3
 Elective 4

SCIENCE AND BUILT ENVIRONMENTS

Engage with industry and research experts to improve the natural and built environments. Seek out ways to build new foundations and improve the quality of life for the present and future generations. Explore how the physical universe impacts our society or the science behind environmental mapping and sustainability in the modern world. Develop your professional career in environmental management, project management or surveying.

FEATURED PROGRAMS

- Master of Environmental Science
- Master of Quantity Surveying
- Master of Project Management

WE ALSO OFFER

- Graduate Certificate in Built Environment (Building Surveying)
- Graduate Certificate in Environmental Science
- Graduate Diploma in Built Environment (Building Surveying)
- Graduate Diploma in Project Management
- Graduate Diploma in Environmental Science
- Master of Applied Project Management

For more information visit:
unisa.edu.au/study

WORLD TOP
100

IN ARCHITECTURE
AND BUILT
ENVIRONMENT

2017 QS Subject
Rankings

AUSTRALIA'S ONLY

MASTER OF QUANTITY
SURVEYING

Master of

ENVIRONMENTAL SCIENCE LMEV

NESTED WITH

- Graduate Certificate in Environmental Science (LCES)
- Graduate Diploma in Environmental Science (LGES)

ML 2 unisa.edu.au/enviro

ENTRY

CRICOS code* O58635G
Fees*(indicative 2019) A\$33,100 pa
IELTS Total 6.5
IELTS Reading 6.0
IELTS Writing 6.0
Start date February, July

*See pages 67–69 for details

Develop integrated knowledge in sustainability, natural resources and geospatial sciences.

Further your skills in natural and/or water resources management.

Work with the latest Geographic Information Systems (GIS) and spatial data analysis equipment in state-of-the-art laboratories located on campus.

Complete a major research project that is closely aligned with industry in your final year.

Benefit from links to the University's Barbara Hardy Institute and the Natural and Built Environments Research Centre.

RELATED DEGREES

- Master of Engineering (Water Resources Management)

PROGRAM STRUCTURE

FIRST YEAR

Seminar in Sustainability
Ecological Economics N
Elective 1
Elective 2

Community Partnerships
Natural Resource Management
Research Theory and Practice
Elective 3

SECOND YEAR

Elective 4
Elective 5
NBE Masters Thesis Part A

Elective 6
Elective 7
NBE Masters Thesis Part B

CAREER OPPORTUNITIES

- Natural resource manager
- Environmental manager
- Environmental adviser
- Environmental planner
- Sustainability adviser

ENTRY REQUIREMENTS

- Bachelor degree, graduate certificate or graduate diploma in a relevant discipline (typically including science, engineering, environmental studies or management) from a recognised higher education institution, or equivalent qualification.
- Applicants with qualifications in other disciplines are encouraged to apply and will be assessed on a case-by-case basis.
- Some applicants may be also eligible for Advanced Standing and can complete the program in one year of full-time study, or equivalent part-time study.

Master of QUANTITY SURVEYING IMQS

  unisa.edu.au/construction

ENTRY

| | |
|------------------------|----------------|
| CRICOS code* | O92658G |
| Fees*(indicative 2019) | A\$33,100 pa |
| IELTS Total | 6.5 |
| IELTS Reading | 6.0 |
| IELTS Writing | 6.0 |
| Start date | February, July |

*See pages 67–69 for details

Gain advanced knowledge in financial and project management.

Learn to estimate and monitor construction costs from project feasibility through to completion.

Develop the skills to advise in post-construction activities such as tax depreciation schedules, replacement cost estimation and dispute resolution.

Relate theoretical concepts to workplace applications using real data collected from the construction industry.

Benefit from links to the University's Barbara Hardy Institute – bringing together scientists, engineers and social scientists focused on sustainability.

CAREER OPPORTUNITIES

- Quantity surveyor
- Cost manager
- Estimator
- Project manager
- Operations manager
- Construction economist

ENTRY REQUIREMENTS

- Bachelor degree in construction management or a relevant discipline* from a recognised higher education institution, or equivalent qualification; or
- Graduate certificate or graduate diploma in construction/project management or a relevant discipline* from a recognised higher education institution.

*Relevant disciplines typically include architectural studies, interior architecture, civil engineering, built environments and building. Applicants with qualifications in other disciplines are encouraged to apply and will be assessed on a case-by-case basis.

Some applicants may also be eligible for Advanced Standing and can complete the program in one year of full-time study, or equivalent part-time study.

PROGRAM STRUCTURE

| FIRST YEAR |
|---|
| Quantity Surveying Practice 2 |
| Principles of Project Management |
| Project Risk Management |
| Project Governance and Ethics |
| Masters Research Theory and Practice |
| Advanced Quantity Surveying |
| Economic, Social and Environmental Analysis |
| Project Control Methods |
| SECOND YEAR |
| Portfolio and Program Management |
| Research Data Analysis |
| NBE Masters Thesis Part A |
| Construction Claims and Disputes Resolution |
| Commercial Contract Management |
| NBE Masters Thesis Part B |

Master of PROJECT MANAGEMENT IMPA

NESTED WITH

- Graduate Diploma in Project Management (IGBP)

  unisa.edu.au/projectmanagement

ENTRY

| | |
|------------------------|----------------|
| CRICOS code* | O81832M |
| Fees*(indicative 2019) | A\$33,100 pa |
| IELTS Total | 6.5 |
| IELTS Reading | 6.0 |
| IELTS Writing | 6.0 |
| Start date | February, July |

*See pages 67–69 for details

Undertake industry-standard studies in project management that can be applied across different industries, businesses and government institutions.

Graduate with the skills to apply project management methodologies, work in interdisciplinary project teams, and manage projects from inception to commissioning.

Complete a major integrated research project, which can focus on a real issue within your workplace.

Benefit from coursework based on the industry-standard *A Guide to the Project Management Body of Knowledge (PMBok® Guide)*.

CAREER OPPORTUNITIES

Qualified project managers can work across a wide-range of industries, including:

- Information technology
- Construction
- Engineering
- Health
- Defence
- Finance
- Mining and resources
- Biopharmaceuticals
- The arts
- Government
- Not-for-profit

PROFESSIONAL RECOGNITION

This program is endorsed by the Australian Institute of Project Management (AIPM).

ENTRY REQUIREMENTS

- Bachelor degree or equivalent qualification, from a recognised higher education institution; or
- Graduate certificate or graduate diploma, in project management, or equivalent qualification, from a recognised higher education institution.

Some applicants may be eligible for Advanced Standing and can complete the program in 1.0 or 1.5 years of full-time study, or equivalent part-time study.

PROGRAM STRUCTURE

| FIRST YEAR |
|---|
| Principles of Project Management |
| Project Risk Management |
| Procurement and Contract Management |
| Project Governance and Ethics |
| Project Control Methods |
| Project Leadership and Teams |
| Economic, Social and Environmental Analysis |
| Masters Research Theory and Practice |
| SECOND YEAR |
| NBE Masters Research Project |
| Portfolio and Program Management |
| Strategy in Project Organisations |
| International Project Practices |
| Professional Practice Project |
| Elective 1 |
| Elective 2 |

HOW TO APPLY



1

FIND THE BEST PROGRAM FOR YOU

Research your options using this guide or by checking information online.

study.unisa.edu.au



2

CHECK ADMISSION REQUIREMENTS

Confirm that you meet all admission requirements including English language, academic entry, program specific requirements and information relevant to your home country. Refer to page 66 for further details.

study.unisa.edu.au

Please note the University of South Australia calculates a grade point average (GPA) on a scale from 1 – 7. For more information, go to:

unisa.edu.au/gpa

If you have further questions about programs or admission requirements at the University of South Australia, you can send your query through to us online. We will respond to your enquiry within the next business day. Go to:

unisa.edu.au/enquire



3

APPLY

You can apply to study at the University of South Australia via two methods:

- > **Online** – apply directly using our secure and streamlined online service. You can save your application and return later to continue the process, as well as track its progress.

unisa.edu.au/international/apply

- > **Agents** – you can also apply via one of the University's registered education agents. A list of our agents is available at:

unisa.edu.au/find-an-agent

Depending on your country of citizenship, you may be required to apply through a registered University of South Australia education agent unless you are already onshore in Australia. View the full list of countries by citizenship at:

unisa.edu.au/Do-you-need-to-apply-through-a-registered-UNISA-Agent

Please submit your application at least two months prior to when you wish to commence your studies. Some students may require more time to ensure they receive their visa.

Supporting documentation

Attach the following application documents to your online application to avoid delays.

- > Certified* copies of academic transcripts and graduation certificates – including information on your institution's grading system as required;
- > English language test results (eg IELTS or TOEFL) where applicable;
- > Detailed syllabi/course outlines of previous studies if you are applying for credit or advanced standing;
- > Additional academic and employer references, if required;
- > Certified* copy of personal details page and signature page of your passport.

**A certified copy is a copy of the original document that has been certified by an official such as a University of South Australia Education Agent, University of South Australia staff member, Justice of the Peace, Notary Public, police officer or examining authority. Please do not send originals as they will not be returned.*



4

APPLICATION ASSESSMENT

The University of South Australia or a registered University of South Australia Education Agent will acknowledge receipt of your application. You will be notified of the outcome of your application **between one and three weeks** (from the date your application and supporting documentation is received).

If you are eligible for your chosen program, an offer letter package will be sent to you via email. If you are not eligible, we may suggest an alternative program or pathway studies. Your application will be assessed in accordance with the *Selection and entry to programs policy* which includes the *Guidelines on genuine temporary entry* and *Guidelines on living costs and evidence of funds*. These can be found at:

unisa.edu.au/international/apply



5

ACCEPT YOUR OFFER

To accept a place in your offered program you will need to:

- > Check the offer letter package carefully to ensure all information is correct in the International Application System:

Go to: student-unisa.studylink.com

- > If you're ready to accept your offer, log in and complete the following steps:
 1. View your offer online.
 2. Click on the 'Actions' button and select 'Respond to Offer'.
 3. Ensure the offer details are correct and select 'Accept Offer'.
 4. Upload any additional documents required to meet your condition/s (if applicable).
 5. Select the box to confirm that you have read, understood and agree to the terms and conditions of the offer.
 6. Enter your full name and any comments you have and then click 'Accept Offer'.
 7. You will then be taken to the University's Western Union Global Pay For Students where you will be instructed on how to make a payment via Bank Transfer or Credit Card.
 8. Once you have finalised your payment, your Admissions Officer will be advised so they can action your acceptance of offer.

Please note: If you have used an agent as part of your application process, your agent will be able to assist with acceptance of your offer.

Confirmation of Enrolment (CoE) and student visa

Once you have accepted, a CoE document will be issued to you by the University which you can use to apply for a student visa for entry into Australia.

We encourage you to apply for your student visa as soon as you receive your CoE. Pre-departure information is available in the acceptance email that is forwarded to you with the CoE document.

unisa.edu.au/student-visa

International Student Payments

We proudly offer the WU® GlobalPay for Students platform to help you make payments in the currency of your choice without extra fees or delays.



Pay your tuition fees quickly



Make payments online, by Bank Transfer, Credit Card or in person



Track payments and receive status updates by text and email

For more information go to:

unisa.edu.au/westernunion



6

PREPARE FOR ARRIVAL

Once you have accepted your place there are a few things you can do to help prepare for your arrival at the University of South Australia.

- > **Enrol online** – As an international student, you will be able to enrol online from anywhere, giving you the same choice as local students when it comes to organising your timetable.
- > **Travel bookings** – Flights to Australia can be heavily booked during January, February and July so check with your travel agent early for flight bookings. However, you should not confirm bookings until you receive your CoE document. Once you have confirmed your travel arrangements, you can arrange airport pickup and on-arrival temporary accommodation via the University.
- > **Arrive on time** – It is important you arrive on time to start your program before orientation week as this provides you with vital information and the best possible start to your university career. If you are unable to arrive by the commencement date you may have to defer your offer. Please note: Orientation is compulsory for some programs.
- > **Orientation** – University staff will ensure you receive a warm welcome to Adelaide. Orientation sessions and activities introduce you to life in Adelaide and the University. You also get the opportunity to meet other new students.

unisa.edu.au/international/pre-departure-checklist

Any questions? Visit unisa.edu.au/international, or phone +61 8 8302 0114

MINIMUM ENGLISH LANGUAGE ENTRY REQUIREMENTS

The table below sets out the minimum English language requirements for entry into programs at the University of South Australia and is provided as a guide only. Many programs require higher international English language proficiency scores than those below, so you'll need to check the specific score for your preferred program in the charts on pages 67–69.

Applicants from countries where English is an official language or who have recent study experience in an English setting may

be able to use this study to meet the English language proficiency requirement. If you have completed previous study in English you must send certified documentation from the educational institution stating that the language of instruction was English. The University will consider all applications on a case-by-case basis.

For more information, please visit unisa.edu.au/english-language-requirements

| English language test (see Note 1) | Score |
|--|---|
| IELTS (International English Language Testing System) (Academic) | 6.5 overall with a 6.0 in Reading and Writing |
| University of Cambridge ESOL (English for Speakers of Other Languages) examination | |
| Certificate of Proficiency in English | 177 |
| Certificate in Advanced English | 177 |
| TOEFL (Test of English as a Foreign Language) | |
| iBT (Internet-based test) | 79 with Reading and Writing not less than 18 |
| PBT (Paper-based test) | 577 with TWE (Test of Written English) of 4.5 |
| PTE (Pearson Test of English) Academic | 58 with Reading and Writing communicative scores not less than 50 |

| English language programs | Score |
|---|---|
| Successful completion of the Centre for English Language at the University of South Australia (CELUSA) Academic English Program | Level 5 |
| Successful completion of relevant TAFE SA English program | TAFE SA English for Academic Purpose (EAP) Advanced |

| Other qualifications |
|--|
| Successful completion within the last two years of an Australian matriculation qualification (or equivalent) undertaken in English in a country in which English is widely used, as determined by the University; or |
| Successful completion within the last two years of a tertiary qualification at diploma level or above and undertaken in English in Australia; or |
| Successful completion of at least two years of tertiary study at diploma level or above and undertaken in English within the last four years in a country in which English is widely used, as determined by the University (see Note 2). |

Note 1: English language test results are generally valid for two years prior to the date of commencement at the University of South Australia.

Note 2: Significant and relevant work experience obtained in an English speaking setting may also be accepted at the University's discretion.

For English language help

CENTRE FOR ENGLISH LANGUAGE AT THE UNIVERSITY OF SOUTH AUSTRALIA (CELUSA)

Applicants who do not meet the University of South Australia English language entry requirements may be able to study at CELUSA. CELUSA specialises in helping international students improve their English for undergraduate and postgraduate study. CELUSA offers International English Language Testing System (IELTS) testing and Academic English (AE) language preparation programs for students continuing on to study at the University of South Australia, and the South Australian Institute of Business and Technology (SAIBT).

The length of your AE language program will depend on your English level prior to commencement and the language requirements of your program. However, as a guide, you will normally need to complete 10 weeks of study for every additional 0.5 needed in your overall IELTS score.

Students who are eligible for and successfully complete a CELUSA program at an appropriate level will not generally be required to take the IELTS or other English language test. Please note that some programs will require IELTS for registration.

CELUSA is Adelaide's IELTS test centre and is based at City West campus. For further information visit the website.

unisa.edu.au/celusa

CRICOS provider code:
CELUSA 02193C

POSTGRADUATE COURSEWORK PROGRAMS OFFERED IN 2019

For international students
IELTS English language
requirements
Please refer to page 66 for minimum
English language requirements for
postgraduate study

| PROGRAM | Program Code | CRICOS Code | Program Duration (in EFTSL) | 2019 Indicative Annual Tuition Fee (A\$) | Start Date | Quota Applies | Home Campus | IELTS OVERALL TOTAL SCORE | IELTS READING | IELTS WRITING | IELTS LISTENING | IELTS Speaking |
|--|--------------|-------------|--------------------------------|--|------------|---------------|-------------|------------------------------|---------------|---------------|-----------------|----------------|
| Master Degrees | | | | | | | | | | | | |
| Master of Advanced Clinical Physiotherapy (Musculoskeletal) | IMAP | O88576K | 1 | 37,500 | Jan | | CE | 7 | 7 | 7 | 7 | 7 |
| Master of Advanced Clinical Physiotherapy (Sports) | IMAP | O88577J | 1 | 37,500 | Jan | | CE | 7 | 7 | 7 | 7 | 7 |
| Master of Applied Project Management | IMAM | O95898M | 1.5 | 33,100 | Feb, Jul | | CE | 6.5 | 6 | 6 | | |
| Master of Architecture | DMAE | O60208J | 2 | 34,400 | Feb, Jul | | CW | 6.5 | 6 | 6 | | |
| Master of Clinical Pharmacy** | IMCM | | 1.5 | 32,000 | Feb, Jul | | CE | 7 | 7 | 7 | | |
| Master of Cybersecurity | LMCY | O92659F | 2 | 32,000 | Feb, Jul | | ML | 6.5 | 6 | 6 | | |
| Master of Data Science | LMDS | O79912G | 2 | 33,100 | Feb, Jul | | ML | 6.5 | 6 | 6 | | |
| Master of Design (Communication Design) | DMSP | O82771M | 2 | 31,000 | Feb, Jul | | CW | 6.5 | 6 | 6 | | |
| Master of Design (Contemporary Art) | DMSP | O95763D | 2 | 31,000 | Feb, Jul | | CW | 6.5 | 6 | 6 | | |
| Master of Design (Design and Construct) | DMSP | O82770A | 2 | 31,000 | Feb, Jul | | CW | 6.5 | 6 | 6 | | |
| Master of Design (Industrial Design) | DMSP | O71952G | 2 | 31,000 | Feb, Jul | | CW | 6.5 | 6 | 6 | | |
| Master of Design (Interior Architecture) | DMSP | O82769E | 2 | 31,000 | Feb, Jul | | CW | 6.5 | 6 | 6 | | |
| Master of Design (Sustainable Design) | DMSP | O82768F | 2 | 31,000 | Feb, Jul | | CW | 6.5 | 6 | 6 | | |
| Master of Education (TESOL) | MMTL | O82450F | 2 | 28,900 | Feb, Jul | | M | 6.5 | 6 | 6 | | |
| Master of Engineering (Civil and Infrastructure) | LMCL | O88538E | 2 | 35,100 | Feb, Jul | | ML | 6.5 | 6 | 6 | | |
| Master of Engineering (Electrical Power) | LMEL | O79908C | 2 | 35,100 | Feb, Jul | | ML | 6.5 | 6 | 6 | | |
| Master of Engineering (Engineering Management) | LMEB | O77355C | 2 | 35,100 | Feb, Jul | | ML | 6.5 | 6 | 6 | | |
| Master of Engineering (Telecommunications) | LMEL | O79909B | 2 | 35,100 | Feb, Jul | | ML | 6.5 | 6 | 6 | | |
| Master of Engineering (Water Resources Management) | LMCL | O88540M | 2 | 35,100 | Feb, Jul | | ML | 6.5 | 6 | 6 | | |
| Master of Environmental Science | LMEV | O58635G | 2 | 33,100 | Feb, Jul | | ML | 6.5 | 6 | 6 | | |
| Master of Health Services Management | IMHM | O96783C | 2 | 26,500* | Feb | | CE | 6.5 | | 6.5 | | 6.5 |
| Master of Information Management (Archives and Records Management) | DMIL | O81827G | 2 | 31,000 | Feb, Jul | | CW | 6.5 | 6 | 6 | | |
| Master of Information Management (Library and Information Management) | DMIL | O81829F | 2 | 31,000 | Feb, Jul | | CW | 6.5 | 6 | 6 | | |
| Master of Information Technology (Enterprise Management) | LMIG | O81872C | 2 | 31,000 | Feb, Jul | | ML | 6.5 | 6 | 6 | 6 | 6 |
| Master of Medical Sonography** | IMSO | | 1.5 | 28,900 | Feb, Jul | | CE | 7 | 7 | 7 | 7 | 7 |
| Master of Nursing | IMNI | O46395G | 1.5 | 31,000 | Feb | | CE | 6.5 | 6.5 | 6.5 | 6.5 | 6.5 |
| Master of Occupational Therapy (Graduate Entry) | IMOG | O24071J | 2 | 38,400 | Feb | Q | CE | 7 | 7 | 7 | 7 | 7 |
| Master of Physiotherapy (Graduate Entry) | IMPE | O45406F | 2 | 41,500 | Feb | Q | CE | 7 | 7 | 7 | 7 | 7 |

KEY

Home campus codes

| | |
|----|---------------------|
| CE | City East Campus |
| CW | City West Campus |
| ML | Mawson Lakes Campus |
| M | Magill Campus |

*Indicative 2018. 2019 fee
subject to change.

**This program is not available to
international students studying
onshore under a student visa.

IMPORTANT INFORMATION

The University of South Australia reserves the right to
alter, amend or delete any program, fee, course, admission
requirement, or mode of delivery without prior notice.

For the most up-to-date program information visit:
study.unisa.edu.au

Please note the University calculates a grade
point average (GPA) on a scale from 1 – 7.

For more information, go to: unisa.edu.au/gpa

Flexible study

Flexible study options, including online, are offered
in many programs.

For more information visit: unisa.edu.au/newstudents

Fees

Fees listed are valid for students enrolling in the 2019 academic
year only. Commencing students enrolled should be aware
that annual tuition fees will increase for each year of study at
the University of South Australia. You will be liable for these
fees upon acceptance of an offer from the University.

In the event of a variation between the fees listed here and
the approved University schedule of tuition fees found at
study.unisa.edu.au, the approved University schedule will prevail.

All fees are listed in Australian dollars (A\$).

2019 Academic Calendar

SP = Study Period

| | | |
|-------------------|-----|---------------------------|
| Semester 1 | SP1 | 14 Jan 2019 – 29 Mar 2019 |
| | SP2 | 4 Mar 2019 – 7 Jul 2019 |
| | SP3 | 8 Apr 2019 – 23 Jun 2019 |

| | | |
|-------------------|-----|---------------------------|
| Semester 2 | SP4 | 1 Jul 2019 – 15 Sept 2019 |
| | SP5 | 29 Jul 2019 – 1 Dec 2019 |
| | SP6 | 23 Sept 2019 – 8 Dec 2019 |

| | | |
|--------------------|-----|-------------------------|
| Summer Term | SP7 | 4 Nov 2019 – 9 Feb 2020 |
|--------------------|-----|-------------------------|

Please note that some programs may have a different
start date. Please check your offer letter for details.

Actual teaching dates may vary in a small percentage
of programs. It is important that students consult their
timetable for exact teaching dates for their specific program.

Commencement of study begins with the University
of South Australia's Orientation program. Please ensure
your travel plans enable you to arrive in time for this.

Visit: unisa.edu.au/newstudents

POSTGRADUATE COURSEWORK PROGRAMS OFFERED IN 2019

For international students
IELTS English language
requirements

Please refer to page 66 for minimum
English language requirements for
postgraduate study.

| PROGRAM | Program Code | CRICOS Code | Program Duration (in EFTSL) | 2019 Indicative Annual Tuition Fee (A\$) | Start Date | Quota Applies | Home Campus | IELTS OVERALL TOTAL SCORE | IELTS READING | IELTS WRITING | IELTS LISTENING | IELTS Speaking |
|--|--------------|-------------|--------------------------------|--|---------------------|---------------|-------------|------------------------------|---------------|---------------|-----------------|----------------|
| Master of Project Management | IMPA | O81832M | 2 | 33,100 | Feb, Jul | | CE | 6.5 | 6 | 6 | | |
| Master of Quantity Surveying | IMQS | O92658G | 2 | 33,100 | Feb, Jul | | CE | 6.5 | 6 | 6 | | |
| Master of Social Work | MMSK | O64242G | 2 | 28,900 | Feb | | M | 7 | 7 | 7 | 7 | 7 |
| Master of Teaching (Early Childhood) | MMET | O77214E | 2 | 28,900 | Feb | | M | 7 | 7 | 7 | 7 | 7 |
| Master of Teaching (Primary) | MMET | O77215D | 2 | 28,900 | Feb | | M | 7 | 7 | 7 | 7 | 7 |
| Master of Teaching (Secondary) | MMET | O77217B | 2 | 28,900 | Feb, Jul | | M | 7 | 7 | 7 | 7 | 7 |
| Master of Urban and Regional Planning | DMUR | O71951J | 2 | 33,100 | Feb, Jul | | CW | 6.5 | 6 | 6 | | |
| Graduate Diplomas | | | | | | | | | | | | |
| Graduate Diploma in Built Environment (Building Surveying)** | IGBE | | 1 | 32,000 | Feb, Jul | | CE | 6.5 | 6 | 6 | | |
| Graduate Diploma in Communication (Public Relations)** | MGPU | | 1 | 28,900 | Feb, Jul | | M | 6.5 | 6 | 6 | | |
| Graduate Diploma in Data Science | LGDS | O79911G | 1 | 33,100 | Feb, Jul | | ML | 6.5 | 6 | 6 | | |
| Graduate Diploma in Design (Communication Design) | DCSP | O82776F | 1 | 31,000 | Feb, Jul | | CW | 6.5 | 6 | 6 | | |
| Graduate Diploma in Design (Contemporary Art) | DCSP | O95762E | 1 | 31,000 | Feb, Jul | | CW | 6.5 | 6 | 6 | | |
| Graduate Diploma in Design (Design and Construct) | DCSP | O82775G | 1 | 31,000 | Feb, Jul | | CW | 6.5 | 6 | 6 | | |
| Graduate Diploma in Design (Industrial Design) | DCSP | O82774G | 1 | 31,000 | Feb, Jul | | CW | 6.5 | 6 | 6 | | |
| Graduate Diploma in Design (Interior Architecture) | DCSP | O82773J | 1 | 31,000 | Feb, Jul | | CW | 6.5 | 6 | 6 | | |
| Graduate Diploma in Design (Sustainable Design) | DCSP | O82772K | 1 | 31,000 | Feb, Jul | | CW | 6.5 | 6 | 6 | | |
| Graduate Diploma in Education (Islamic Education**) | MGIM | | 1 | 27,900 | Feb, Jul | | M | 6.5 | 6 | 6 | | |
| Graduate Diploma in Education Studies (Digital Learning)** | MCDL | | 1 | 27,900 | Apr | | M | 6.5 | 6 | 6 | | |
| Graduate Diploma in Engineering (Engineering Management) | LGEB | O77354D | 1 | 36,000 | Feb, Jul | | ML | 6.5 | 6 | 6 | | |
| Graduate Diploma in Environmental Science | LGES | O58636G | 1 | 33,100 | Feb, Jul | | ML | 6.5 | 6 | 6 | | |
| Graduate Diploma in Human Factors and Safety Management Systems** | IGHF | NONE | 1 | 36,000 | Feb, Jul | | CE | 6.5 | 6 | 6 | | |
| Graduate Diploma in Information Management (Archives and Records Management) | DGIL | O81825K | 1 | 31,000 | Feb, Jul | | CW | 6.5 | 6 | 6 | | |
| Graduate Diploma in Information Management (Library and Information Management) | DGIL | O81824M | 1 | 31,000 | Feb, Jul | | CW | 6.5 | 6 | 6 | | |
| Graduate Diploma in Information Technology (Enterprise Management) | LGIG | O81822B | 1 | 31,000 | Feb, Jul | | ML | 6.5 | 6 | 6 | | |
| Graduate Diploma in Medical Sonography** | IGSO | | 1 | 28,900 | Feb, Jul | | CE | 7 | 7 | 7 | 7 | 7 |
| Graduate Diploma in Organisational Safety Management** | IGOY | | 1 | 36,000 | Feb, Jul | | CE | 6.5 | 6 | 6 | | |
| Graduate Diploma in Project Management | IGBP | O13176B | 1 | 33,100 | Feb, Jul | | CE | 6.5 | 6 | 6 | | |
| Graduate Diploma in Urban and Regional Planning | DGUR | O00579A | 1 | 33,100 | Feb, Jul | | CW | 6.5 | 6 | 6 | | |
| Graduate Certificates | | | | | | | | | | | | |
| Graduate Certificate in Breast Imaging** | ICBR | | 0.5 | 27,900 | Feb, Jul | | CE | 7 | 7 | 7 | 7 | 7 |
| Graduate Certificate in Built Environment (Building Surveying)** | ICBE | | 0.5 | 32,000 | Feb, Jul | | CE | 6.5 | 6 | 6 | | |
| Graduate Certificate in Compositing and Tracking | ICVE | O88908F | 0.5 | 24,400 | Feb, Sept | | CE | 6.5 | 6 | 6 | | |
| Graduate Certificate in Data Science | LCDS | O79910J | 0.5 | 33,100 | Feb, Jul | | ML | 6.5 | 6 | 6 | | |
| Graduate Certificate in Dynamic Effects and Lighting | ICDL | O92822M | 0.5 | 24,400 | Feb, Sept | | CE | 6.5 | 6 | 6 | | |
| Graduate Certificate in Environmental Science | LCES | O58637F | 0.5 | 33,100 | Feb, Jul | | ML | 6.5 | 6 | 6 | | |
| Graduate Certificate in Film and Television | MCFT | O95897A | 0.5 | 33,100 | Feb, Jul | | M | 6.5 | 6.5 | 6.5 | | |
| Graduate Certificate in Information Management | DCIL | O81821C | 0.5 | 31,000 | Feb, Jul | | CW | 6.5 | 6 | 6 | | |
| Graduate Certificate in Information Technology | LCIG | O81820D | 0.5 | 31,000 | Feb, Jul | | ML | 6.5 | 6 | 6 | | |
| Graduate Certificate in Nursing (Bridging & Re-entry) | ICNB | O84729G | 0.5 | 37,500 | Feb, Sept | | CE | 7 | 7 | 7 | 7 | 7 |
| Graduate Certificate in Organisational Safety and Human Factors** | ICOY | | 0.5 | 36,000 | Feb, Jul | | CE | 6.5 | 6 | 6 | | |
| Graduate Certificate in Population Health Practice | ICPR | O84730D | 0.5 | 34,100 | Feb, Jul | | CE | 7 | 6.5 | 7 | 6.5 | 6.5 |
| Graduate Certificate in Space Studies** | LCSD | | 0.5 | 32,000 | Jan | | ML | 6.5 | 6 | 6 | | |
| UniSA Business School – Master Degrees | | | | | | | | | | | | |
| Master of Business Administration | DMMA | O48635B | 1.5 | 38,400 | Jan, Apr, Jun, Sept | | CW | 6.5 | 6 | 6 | | |
| Master of Business Administration (Finance) | DMMA | O83050C | 1.5 | 38,400 | Jan, Apr, Jun, Sept | | CW | 6.5 | 6 | 6 | | |
| Master of Business Administration (Human Resource Management) | DMMA | O83052A | 1.5 | 38,400 | Jan, Apr, Jun, Sept | | CW | 6.5 | 6 | 6 | | |
| Master of Business Administration (Marketing) | DMMA | O83054K | 1.5 | 38,400 | Jan, Apr, Jun, Sept | | CW | 6.5 | 6 | 6 | | |
| Master of Finance | DMFC | O82591D | 2 | 34,400 | Feb, Jul | | CW | 6.5 | 6 | 6 | | |

**For international students
IELTS English language
requirements**
Please refer to page 66 for minimum
English language requirements for
postgraduate study.

| PROGRAM | Program Code | CRICOS Code | Program Duration (in EFTSL) | 2019 Indicative Annual Tuition Fee (A\$) | Start Date | Quota Applies | Home Campus | IELTS OVERALL TOTAL SCORE | IELTS READING | IELTS WRITING | IELTS LISTENING | IELTS Speaking |
|---|--------------|-------------|--------------------------------|--|---------------------|---------------|-------------|------------------------------|---------------|---------------|-----------------|----------------|
| Master of Finance (Banking) | DMFC | O82594A | 2 | 34,400 | Feb, Jul | | CW | 6.5 | 6 | 6 | | |
| International Master of Business Administration | DMIN | O81137A | 2 | 34,100 | Feb, Jul | | CW | 6.5 | 6 | 6 | | |
| International Master of Business Administration (Finance) | DMIN | O92314J | 2 | 34,100 | Feb, Jul | | CW | 6.5 | 6 | 6 | | |
| International Master of Business Administration (Human Resource Management) | DMIN | O91996G | 2 | 34,100 | Feb, Jul | | CW | 6.5 | 6 | 6 | | |
| International Master of Business Administration (Marketing) | DMIN | O91997G | 2 | 34,100 | Feb, Jul | | CW | 6.5 | 6 | 6 | | |
| International Master of Business Administration (Supply Chain Management) | DMIN | O91995J | 2 | 34,100 | Feb, Jul | | CW | 6.5 | 6 | 6 | | |
| International Master of Business Administration (Tourism and Event Management) | DMIN | O91994K | 2 | 34,100 | Feb, Jul | | CW | 6.5 | 6 | 6 | | |
| Master of Management | DMMX | O91989G | 1.5 | 34,400 | Feb, Jul | | CW | 6.5 | 6 | 6 | | |
| Master of Management (Arts and Cultural Management) | DMMC | O81136B | 2 | 34,400 | Feb, Jul | | CW | 6.5 | 6 | 6 | | |
| Master of Management (Human Resource Management) | DMMX | O91992A | 1.5 | 34,400 | Feb, Jul | | CW | 6.5 | 6 | 6 | | |
| Master of Management (Marketing) | DMMX | O91993M | 1.5 | 34,400 | Feb, Jul | | CW | 6.5 | 6 | 6 | | |
| Master of Management (Supply Chain Management) | DMMX | O91991B | 1.5 | 34,400 | Feb, Jul | | CW | 6.5 | 6 | 6 | | |
| Master of Management (Tourism and Event Management) | DMMX | O91990C | 1.5 | 34,400 | Feb, Jul | | CW | 6.5 | 6 | 6 | | |
| Master of Professional Accounting | DMPC | O82982M | 2 | 34,100 | Feb, Jul | | CW | 6.5 | 6 | 6 | | |
| UniSA Business School – Graduate Diplomas | | | | | | | | | | | | |
| Graduate Diploma in Business Administration | DGMA | O24133M | 1 | 38,400 | Jan, Apr, Jun, Sept | | CW | 6.5 | 6 | 6 | | |
| Graduate Diploma in Human Resource Management | DGHU | O55259G | 1 | 34,400 | Feb, Jul | | CW | 6.5 | 6 | 6 | | |
| Graduate Diploma in Management (Arts and Cultural Management) | DGAC | O24151J | 1 | 34,400 | Feb, Jul | | CW | 6.5 | 6 | 6 | | |
| UniSA Business School – Graduate Certificate | | | | | | | | | | | | |
| Graduate Certificate in Business | DCBB | O81140F | 0.5 | 34,400 | Feb, Jul | | CW | 6.5 | 6 | 6 | | |
| Graduate Certificate in Business Administration | DCMA | O24119J | 0.5 | 38,400 | Jan, Apr, Jun, Sept | | CW | 6.5 | 6 | 6 | | |
| Graduate Certificate in Human Resource Management | DCHU | O55258G | 0.5 | 34,400 | Feb, Jul | | CW | 6.5 | 6 | 6 | | |

KEY

Home campus codes

| | |
|----|---------------------|
| CE | City East Campus |
| CW | City West Campus |
| ML | Mawson Lakes Campus |
| M | Magill Campus |

*Indicative 2018. 2019 fee
subject to change.

**This program is not available to
international students studying
onshore under a student visa.

IMPORTANT INFORMATION

The University of South Australia reserves the right to
alter, amend or delete any program, fee, course, admission
requirement, or mode of delivery without prior notice.

For the most up-to-date program information visit:
study.unisa.edu.au

Please note the University calculates a grade
point average (GPA) on a scale from 1 – 7.

For more information, go to: unisa.edu.au/gpa

Flexible study

Flexible study options, including online, are offered
in many programs.

For more information visit: unisa.edu.au/newstudents

Fees

Fees listed are valid for students enrolling in the 2019 academic
year only. Commencing students enrolled should be aware
that annual tuition fees will increase for each year of study at
the University of South Australia. You will be liable for these
fees upon acceptance of an offer from the University.

In the event of a variation between the fees listed here and
the approved University schedule of tuition fees found at
study.unisa.edu.au, the approved University schedule will prevail.

All fees are listed in Australian dollars (A\$).

2019 Academic Calendar

SP = Study Period

| | | |
|-------------------|-----|---------------------------|
| Semester 1 | SP1 | 14 Jan 2019 – 29 Mar 2019 |
| | SP2 | 4 Mar 2019 – 7 Jul 2019 |
| | SP3 | 8 Apr 2019 – 23 Jun 2019 |

| | | |
|-------------------|-----|---------------------------|
| Semester 2 | SP4 | 1 Jul 2019 – 15 Sept 2019 |
| | SP5 | 29 Jul 2019 – 1 Dec 2019 |
| | SP6 | 23 Sept 2019 – 8 Dec 2019 |

| | | |
|--------------------|-----|-------------------------|
| Summer Term | SP7 | 4 Nov 2019 – 9 Feb 2020 |
|--------------------|-----|-------------------------|

Please note that some programs may have a different
start date. Please check your offer letter for details.

Actual teaching dates may vary in a small percentage
of programs. It is important that students consult their
timetable for exact teaching dates for their specific program.

Commencement of study begins with the University
of South Australia's Orientation program. Please ensure
your travel plans enable you to arrive in time for this.

Visit: unisa.edu.au/newstudents

OFFSHORE PROGRAMS

We are committed to building strong global links with highly ranked partners to deliver quality offshore programs meaning you can still be part of the University of South Australia from your home country. Discover some of our offshore offerings in Hong Kong below.

Hong Kong Management Association (HKMA)

HKMA is a non-profit organisation aiming to advance management excellence in Hong Kong and the region since 1960. Since its establishment, HKMA has played a major role in contributing to the economic success of Hong Kong by providing a wide variety of high quality management training and services.

PROGRAMS:

- Master of Business Administration (Finance) – OMMAA
- Master of Business Administration (Human Resource Management) – OMMAA
- Master of Business Administration (Marketing) – OMMAA

hkma.org.hk

Hong Kong Baptist University (HKBU)

The University has partnered with the School of Continuing Education (SCE), at Hong Kong Baptist University for over 20 years. The SCE was founded in 1975 and has been providing people of all ages with options for professional and academic advancement to meet the needs of the rapidly changing society.

PROGRAMS:

- Bachelor of Business (Management) – OBBGH
- Bachelor of Business (Tourism and Event Management) – OBBTH
- Bachelor of Nutrition and Food Sciences (Food Sciences) – OBFSH
- Bachelor of Psychological Sciences – OBPSH
- Bachelor of Aviation (Management) – OBANH

sce.hkbu.edu.hk

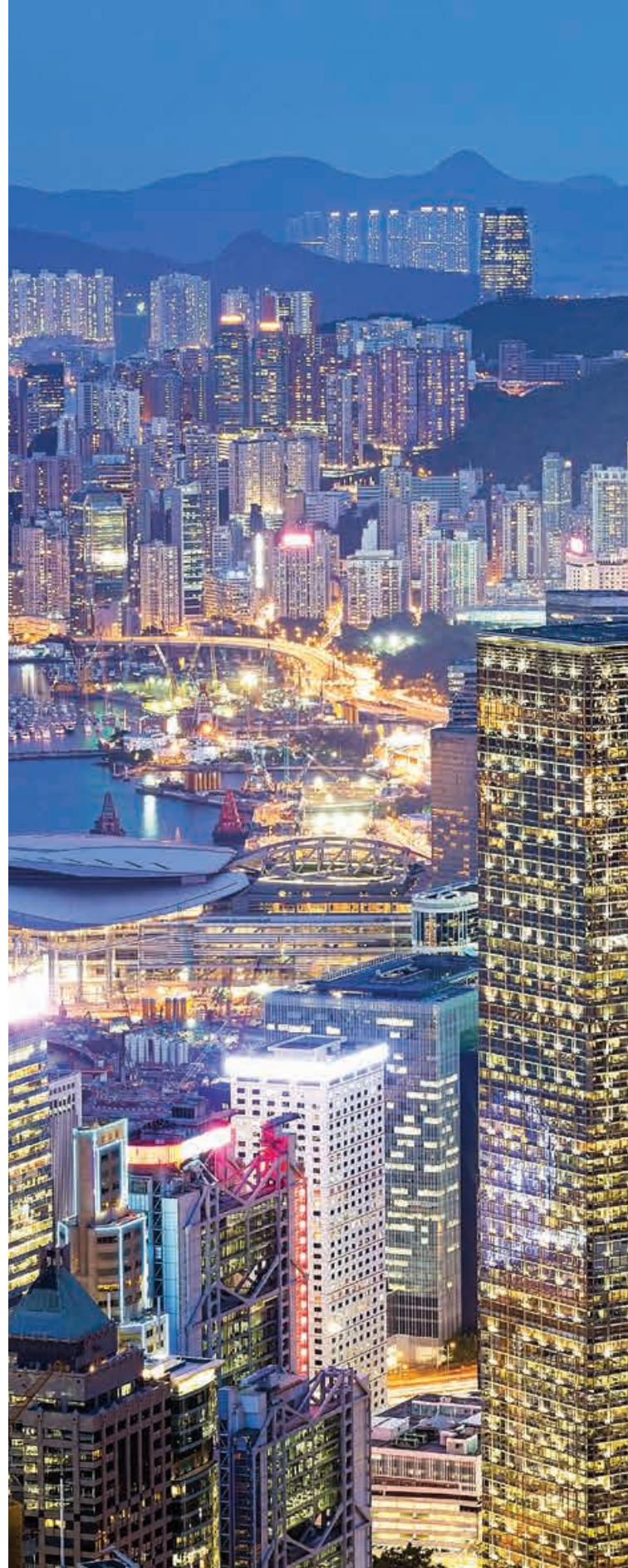

For more information about our global partnerships and other offshore programs visit:

unisa.edu.au/university-partners



HOW TO BECOME A RESEARCH STUDENT

Your pathway to becoming a research student at the University of South Australia.



1

FIND A RESEARCH AREA

Match your interest to an area of research at the University of South Australia.

Our research areas include:

BUSINESS AND LAW

- Accounting
- Applied Economics
- Arts Management
- Finance
- Human Resource Management and Organisation Behaviour
- International Business
- Law
- Management and Corporate Social Responsibility
- Marketing
- Property
- Sports, Tourism and Leisure Management
- Sustainability Governance

For more information about research possibilities, contact PhDEnquiriesBusiness@unisa.edu.au

HEALTH AND MEDICAL SCIENCES

- Cancer Biology
- Health Sciences
- Human Movement
- Laboratory Technology (Masters only)
- Medical Radiation
- Medical Science
- Nursing
- Occupational Therapy
- Pharmaceutical Science (Masters only)
- Pharmacology (PhD only)
- Pharmacy
- Physiotherapy
- Podiatry
- Population Health
- Public Health

For more information about research possibilities, contact HSC-HealthResearch@unisa.edu.au

EDUCATION, ARTS AND SOCIAL SCIENCES

- Architecture
- Australian Studies
- Cognitive Neuroscience
- Communication
- Creative Industries
- Design (Industrial)
- Design (Visual Communication)
- Education
- Indigenous Studies
- Interior Architecture
- Languages and Linguistics
- Psychology (PhD only)
- Social Work and Social Policy
- Sociology
- Visual Arts

For more information about research possibilities, contact EASResearchStudents@unisa.edu.au

ENGINEERING, SCIENCE AND TECHNOLOGY

- Applied Physics
- ATN Industry Doctoral Training Centre
- Bioinformatics
- Biomaterials Engineering and Nanomedicine
- Civil Engineering
- Computer and Information Science
- Construction Management
- Electrical and Information Engineering
- Energy and Advanced Manufacturing
- Environmental Science and Engineering
- Environmental Science
- Geographic Information Science
- Mathematics
- Mechanical and Manufacturing Engineering
- Minerals and Resources
- Project Management
- Statistics
- Systems Engineering

For more information about research possibilities, contact research.itee@unisa.edu.au

Refer to pages 74–76 for the course codes you will need for your application.

Please send an email to the relevant email address if unsure which course code to use.



2

CHECK YOUR ELIGIBILITY

Your eligibility to become a research student at the University depends on the type of degree you wish to study, as well as your prior qualifications and professional experience. Students from non-English speaking countries will also need to demonstrate their capacity to undertake study in English before being accepted into a program.

The eligibility criteria listed below are a minimum. Eligibility is also subject to the assessment of the proposed research, the availability of a supervisor, and any school or research-specific requirements.

| Degree | Minimum eligibility requirements |
|------------------------|---|
| PhD | <p><i>Honours 1, Honours 1 equivalence, Honours 2A, Honours 2A equivalence or an appropriate master degree or equivalent (your qualifications will be assessed).</i></p> <p>OR</p> <p>Individual assessment of qualifications and research capabilities as proven through evidence of professional work experience in the field of proposed study and by relevant quality publications. The outcome of this assessment will determine which of the degree options are available to you.</p> |
| Professional Doctorate | <p><i>Honours 1, Honours 1 equivalence, Honours 2A, Honours 2A equivalence or an appropriate master degree or equivalent (your qualifications will be assessed).</i></p> <p>OR</p> <p>Individual assessment of qualifications and research capabilities as proven through evidence of professional work experience in the field of proposed study and by relevant quality publications. The outcome of this assessment will determine which of the degree options are available to you.</p> <p>Professional Doctorate candidates must also demonstrate at least five years practice in a relevant field, and normally within the last ten years.</p> |
| Masters | <p><i>An Honours degree or a bachelor degree with Honours or a relevant bachelor degree (or equivalent) of at least three years with a minimum credit average, or an appropriate master degree (your qualifications will be assessed for equivalence).</i></p> <p>OR</p> <p>No tertiary qualifications, but you can demonstrate research capabilities through evidence of professional work experience in the field of proposed study and by relevant publications.</p> |

Minimum English language entry requirements for international research students

| English Language Test (see Note 1) | Score |
|--|---|
| IELTS (International English Language Testing System) Academic | 7.0 for English language-rich programs with a minimum of 6.0 in each sub-score (see Note 2) |
| | 6.5 for non English language-rich programs with a minimum of 6.0 in each sub-score (see Note 2) |
| OR corresponding results from an equivalent test such as Test of English as a Foreign Language (TOEFL); the University of Cambridge English for Speakers of Other Languages (ESOL) Examinations for the Certificate of Proficiency in English (CPE) or the Certificate in Advanced English (CAE); the Pearson test; or the appropriate academic English language level delivered by the Centre for English Language at the University of South Australia (CELUSA). | |

Applicants from countries where English is an official language or who have had recent and relevant experience in an English setting may meet our minimum English entry requirements in a number of alternative ways. Evidence must be provided.

unisa.edu.au/research-degree-english-language-requirements

Note 1: Results from IELTS, University of Cambridge ESOL examinations and TOEFL are generally valid for two years and must be valid at time of commencement. For scholarships, test results must be valid at the scholarship closing date.

Note 2: To determine which programs are language-rich and which are not, please visit:

unisa.edu.au/research-degree-english-language-requirements



3

SEARCH FOR A SUPERVISOR

The University of South Australia has internationally renowned research supervisors who provide expert supervision across an impressive range of research interests. Many students come to the University to work with specific researchers and learn directly from their expertise and experience.

There are several possible ways of finding a supervisor. For example they could be a UniSA academic you've worked with in the past, or whose research you've read.

Tips on finding a supervisor can be found on the research degrees website:

unisa.edu.au/find-a-supervisor



4

FIND A SCHOLARSHIP

There are a variety of scholarships and funding opportunities available to help support you financially throughout your studies. Scholarships are assessed based on competitive merit, and are awarded to the very best applicants. Scholarships normally provide support for three years for PhD and Professional Doctorates, and two years for Masters by Research candidates.

Scholarships will normally have specific opening and closing dates – make sure you read the criteria and application requirements.

If you are applying for a scholarship, you should indicate this when you apply for your research degree. Our online application system will ask for this information.

For more details about scholarship opportunities visit:

unisa.edu.au/resdegrees



5

APPLY

You should prepare these things before you commence your online application:

- > Organise two referee reports. Find out more at: unisa.edu.au/research-degree-referee-reports
- > Transcripts and parchments of undergraduate, honours and postgraduate courses undertaken;
- > Certification of English language proficiency;
- > Passport details or evidence of citizenship;
- > Outline of your proposed research;
- > Current CV;
- > Evidence of publications.

You will also need to know which course code to apply for. See pages 74-76 for options, or please send an email to the relevant address if unsure.

For more information please visit:

unisa.edu.au/resdegrees

You are now ready to apply.

Apply for entry into your program at:

unisa.edu.au/applyonline

For more information on each of these steps please visit:

unisa.edu.au/resdegrees

RESEARCH DEGREES OFFERED IN 2019

| Program Name | Program Code | CRCOS Code | Duration (in EFTSL) | 2019 Indicative Annual Tuition Fee (A\$) |
|--|--------------|------------|---------------------|--|
| Business, Management and Law | | | | |
| Masters by Research | | | | |
| Accounting A | DMRU | 000547J | 2 | 34,400 |
| Business and Management A | DMRU | 000547J | 2 | 34,400 |
| Business and Management C | DMRU | 000547J | 2 | 34,400 |
| Law A | DMRU | 000547J | 2 | 34,400 |
| Law B | DMRU | 000547J | 2 | 34,400 |
| Human Resource Management A | DMRU | 000547J | 2 | 34,400 |
| Tourism Management A | DMRU | 000547J | 2 | 34,400 |
| Marketing and related studies B | DMRU | 000547J | 2 | 34,400 |
| Finance and related studies A | DMRU | 000547J | 2 | 34,400 |
| Applied Economics | DMRU | 000547J | 2 | 34,400 |
| Doctor of Philosophy (PhD) | | | | |
| Accounting A | DPBU | 018568A | 4 | 34,400 |
| Business and Management A | DPBU | 018568A | 4 | 34,400 |
| Business and Management C | DPBU | 018568A | 4 | 34,400 |
| Human Resource Management A | DPBU | 018568A | 4 | 34,400 |
| Law A | DPBU | 018568A | 4 | 34,400 |
| Law B | DPBU | 018568A | 4 | 34,400 |
| Tourism Management A | DPBU | 018568A | 4 | 34,400 |
| Marketing and related studies B | DPBU | 018568A | 4 | 34,400 |
| Finance and related studies A | DPBU | 018568A | 4 | 34,400 |
| Applied Economics | DPBU | 018568A | 4 | 34,400 |
| Education, Arts and Social Sciences | | | | |
| Masters by Research | | | | |
| Architecture | MMRD | 013177A | 2 | 31,000 |
| Australian Studies | MMDE | 039461E | 2 | 27,900 |
| Communication | MMRD | 024083E | 2 | 31,000 |
| Design - Visual Communication | MMRD | 013571B | 2 | 31,000 |
| Education | MMDE | 000619J | 2 | 27,900 |
| Indigenous, Aust Stud | MMDE | 039461E | 2 | 27,900 |
| Industrial Design | MMRD | 013571B | 2 | 31,000 |
| Interior Architecture | MMRD | 013177A | 2 | 31,000 |
| International Studies | MMRD | 020957C | 2 | 31,000 |
| Languages and Linguistics | MMRD | 020957C | 2 | 31,000 |
| Social Work and Social Policy | MMRD | 040747C | 2 | 31,000 |
| Sociology | MMRD | 020957C | 2 | 31,000 |
| Urban and Regional Planning | MMRD | 024074F | 2 | 31,000 |
| Visual Arts | MMRD | 024083E | 2 | 31,000 |
| Visual Arts - Major Studio Project | MMRD | 024083E | 2 | 31,000 |
| Doctor of Philosophy (PhD) | | | | |
| Architecture | MPHD | 015040B | 4 | 31,000 |
| Australian Studies | MPDE | 048558K | 4 | 27,900 |
| Communication | MPHD | 040645J | 4 | 31,000 |
| Design - Major Studio Project | MPHD | 070417F | 4 | 31,000 |
| Design - Visual Communication | MPHD | 070417F | 4 | 31,000 |
| Education | MPDE | 016149C | 4 | 27,900 |
| Indigenous Studies | MPDE | 048558K | | 27,900 |
| Industrial Design | MPHD | 070417F | 4 | 31,000 |
| Interior Architecture | MPHD | 015040B | 4 | 31,000 |
| International Studies | MPHD | 040646G | 4 | 31,000 |
| Languages and Linguistics | MPHD | 070418E | 4 | 31,000 |
| Psychology | MPHD | 040647G | 4 | 31,000 |

| Program Name | Program Code | CRICOS Code | Duration (in EFTSL) | 2019 Indicative Annual Tuition Fee (A\$) |
|---|--------------|-------------|---------------------|--|
| Social Work and Social Policy | MPHD | O4O648F | 4 | 31,000 |
| Sociology | MPHD | O72915E | 4 | 31,000 |
| Urban and Regional Planning | MPHD | O65911A | 4 | 31,000 |
| Visual Arts | MPHD | O36284G | 4 | 31,000 |
| Visual Arts - Major Studio Project | MPHD | O36284G | 4 | 31,000 |
| Health and Medical Sciences | | | | |
| Masters by Research | | | | |
| Biomaterials Engineering and Nanomedicine | IMHC | O88999J | 2 | 34,100 |
| Health Sciences A | IMHC | O36358F | 2 | 34,100 |
| Human Movement | IMHC | O36359E | 2 | 34,100 |
| Medical Radiation | IMHC | O65561G | 2 | 34,100 |
| Medical Science | IMHC | O95535E | 2 | 34,100 |
| Nursing | IMHC | O24O73G | 2 | 34,100 |
| Occupational Therapy | IMHC | O36361M | 2 | 34,100 |
| Pharmaceutical Sciences | IMHC | O65562F | 2 | 34,100 |
| Pharmacology | IMHC | O95536D | 2 | 34,100 |
| Pharmacy | IMHC | O096O3M | 2 | 34,100 |
| Physiotherapy | IMHC | O24O52A | 2 | 34,100 |
| Podiatry | IMHC | O65563E | 2 | 34,100 |
| Population Health Practice | IMHC | O8475OM | 2 | 34,100 |
| Public Health | IMHC | O95537C | 2 | 34,100 |
| Doctor of Philosophy (PhD) | | | | |
| Biomaterials Eng and Nanomedicine | IPHD | O88989M | 4 | 34,100 |
| Health Sciences A | IPHD | O793O8E | 4 | 34,100 |
| Human Movement | IPHD | O48569G | 4 | 34,100 |
| Medical Radiation | IPHD | O72917C | 4 | 34,100 |
| Medical Science | IPHD | O72918B | 4 | 34,100 |
| Nursing | IPHD | O24O85C | 4 | 34,100 |
| Occupational Therapy | IPHD | O72919A | 4 | 34,100 |
| Pharmaceutical Sciences | IPHD | O95534F | 4 | 34,100 |
| Pharmacology | IPHD | O72920G | 4 | 34,100 |
| Pharmacy | IPHD | O48570C | 4 | 34,100 |
| Physiotherapy | IPHD | O72921G | 4 | 34,100 |
| Podiatry | IPHD | O72922F | 4 | 34,100 |
| Public Health A | IPHD | O72923E | 4 | 34,100 |
| Public Health B | IPHD | O72923E | 4 | 34,100 |
| Science and Technology | | | | |
| Masters by Research | | | | |
| Applied Physics | LMIE | O24O51B | 2 | 36,000 |
| Bioinformatics | LMIE | O65888F | 2 | 36,000 |
| Biomaterials Engineering and Nanomedicine | LMIE | O88999J | 2 | 36,000 |
| Biomaterials Engineering and Nanomedicine | LMIE | O88998K | 2 | 36,000 |
| Biomaterials Engineering and Nanomedicine | LMIE | O88993D | 2 | 36,000 |
| Civil Engineering | LMIE | O65883M | 2 | 36,000 |
| Computer Information Science | LMIE | O65882A | 2 | 36,000 |
| Construction Management | LMIE | O13179K | 2 | 36,000 |
| Electrical and Information Engineering | LMIE | O65884K | 2 | 36,000 |
| Energy and Advanced Manufacturing | LMIE | O88991F | 2 | 36,000 |
| Energy and Advanced Manufacturing | LMIE | O88996A | 2 | 36,000 |
| Energy and Advanced Manufacturing | LMIE | O88991F | 2 | 36,000 |
| Environmental Science | LMIE | O65881B | 2 | 36,000 |
| Environmental Science and Engineering | LMIE | O88992E | 2 | 36,000 |
| Environmental Science and Engineering | LMIE | O88997M | 2 | 36,000 |

RESEARCH DEGREES OFFERED IN 2019

| Program Name | Program Code | CRICOS Code | Duration (in EFTSL) | 2019 Indicative Annual Tuition Fee (A\$) |
|---|--------------|-------------|------------------------|---|
| Environmental Science and Engineering | LMIE | O88992E | 2 | 36,000 |
| Geographic Information Science | LMIE | O65889E | 2 | 36,000 |
| Information and Communication Technology | LMIE | O92179M | 2 | 36,000 |
| Master of Project Management | LMIE | O88579G | 2 | 36,000 |
| Mathematics | LMIE | O00161E | 2 | 36,000 |
| Mechanical and Industry Eng | LMIE | O65886G | 2 | 36,000 |
| Mechanical and Manufacturing Engineering | LMIE | O65886G | 2 | 36,000 |
| Minerals and Resources | LMIE | O88994C | 2 | 36,000 |
| Minerals and Resources | LMIE | O88995B | 2 | 36,000 |
| Minerals and Resources | LMIE | O88990G | 2 | 36,000 |
| Statistics | LMIE | O65891M | 2 | 36,000 |
| Systems Engineering | LMIE | O65887G | 2 | 36,000 |
| Doctor of Philosophy (PhD) | | | | |
| Applied Physics | LPHD | O48559J | 4 | 36,000 |
| Bioinformatics | LPHD | O65902B | 4 | 36,000 |
| Biomaterials Eng and Nanomedicine | LPHD | O88988A | 4 | 36,000 |
| Biomaterials Engineering and Nanomedicine | LPHD | O88988A | 4 | 36,000 |
| Biomaterials Engineering and Nanomedicine | LPHD | O88988A | 4 | 36,000 |
| Civil Engineering | LPHD | O73042G | 4 | 36,000 |
| Computer and Information Science | LPHD | O65903A | 4 | 36,000 |
| Construction Management | LPHD | O73043G | 4 | 36,000 |
| Electrical and Information Engineering | LPHD | O65904M | 4 | 36,000 |
| Energy and Advanced Manufacturing | LPHD | O88986C | 4 | 36,000 |
| Energy and Advanced Manufacturing | LPHD | O88986C | 4 | 36,000 |
| Energy and Advanced Manufacturing | LPHD | O88986C | 4 | 36,000 |
| Environmental Science | LPHD | O65905K | 4 | 36,000 |
| Environmental Science and Engineering | LPHD | O88987B | 4 | 36,000 |
| Environmental Science and Engineering | LPHD | O88987B | 4 | 36,000 |
| Environmental Science and Engineering | LPHD | O88987B | 4 | 36,000 |
| Geographic Information Science | LPHD | O13566K | 4 | 36,000 |
| Industry Doctoral Training Centre | LPHD | O65909F | 4 | 36,000 |
| Information and Communication Technology | LPHD | O92180G | 4 | 36,000 |
| Mathematics | LPHD | O65909F | 4 | 36,000 |
| Mechanical and Industry Eng | LPHD | O65910B | 4 | 36,000 |
| Mechanical and Manuf Eng | LPHD | O65910B | 4 | 36,000 |
| Minerals and Resources | LPHD | O88985D | 4 | 36,000 |
| Minerals and Resources | LPHD | O88985D | 4 | 36,000 |
| Minerals and Resources | LPHD | O88985D | 4 | 36,000 |
| Project Management | LPHD | O75140A | 4 | 36,000 |
| Statistics | LPHD | O65909F | 4 | 36,000 |
| Systems Engineering | LPHD | O65901C | 4 | 36,000 |

CONNECT WITH UniSA



Facebook

facebook.com/UniSA
facebook.com/UniSACityEast
facebook.com/UniSACityWest
facebook.com/unisamagillcampus
facebook.com/UniSAMawsonLakes



Twitter

twitter.com/UniversitySA
twitter.com/UniSAnewsroom



Youtube

youtube.com/unisouthaustralia



Instagram

instagram.com/universitysa



Linkedin

linkedin.com/company/university-of-south-australia



International Student Blog

unisablog.com



Weibo

weibo.com/studyatunisa



University of South Australia

Further information

unisa.edu.au/international

Telephone: +61 8 8302 0114

Facsimile: +618 8302 9121

Email: international@unisa.edu.au

Freecall: (Australia) 1800 1818 58

 youtube.com/unisouthaustralia

 facebook.com/UniSA

 twitter.com/UniversitySA

 instagram/universitysa

 Weibo: @studyatunisa

 Wechat: unisaofficial

The information provided in this publication is for general information only, and the University of South Australia makes no representation about the content, suitability, accuracy or completeness of this information for any purpose. It is provided "as is" without express or implied warranty.

Information correct at time of printing (January 2018)

CRICOS provider number 00121B



studyinaustralia.gov.au