

**STRUCTURES 1**

DEFERRED EXAMINATION : Semester 2, 2000 (January 2001)

TIME : 2 HOURS

**INSTRUCTIONS:-**

1. Attempt any two questions [ 40 marks total ]
2. State any assumptions made
3. Any references are permitted

**Question 1**

Calculate the forces in all members of this loaded truss. [ 20 marks ]

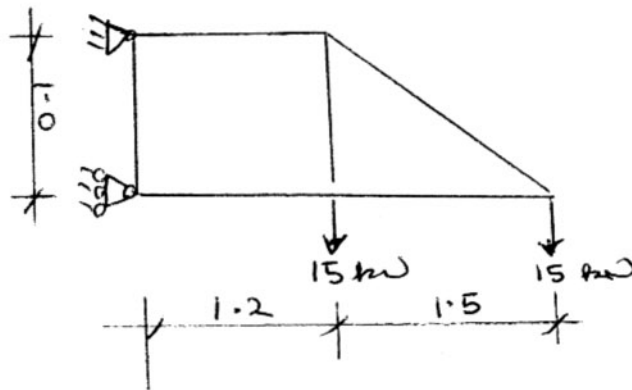

**Question 2**

Calculate and draw the shear force and bending moment diagrams for this loaded frame. Include all maximum values and any points of contraflexure. [20 marks ]

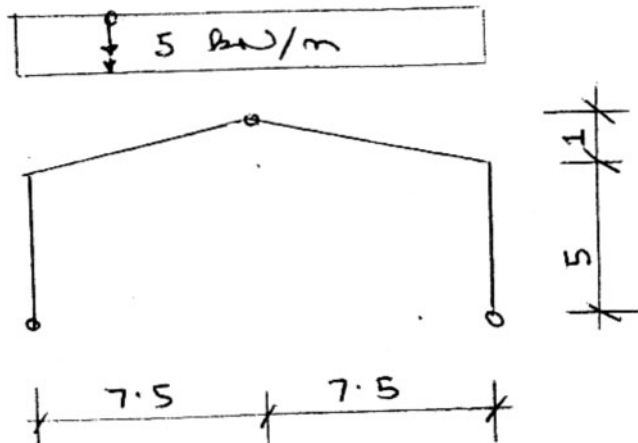

**Question 3**

Calculate the deflections at B and D for this loaded beam.

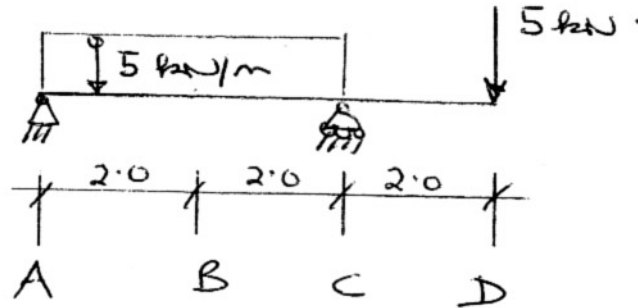

##### END OF QUESTIONS #####