

2 4 6 8 10m 20 40 60

NOTES:
Building Records drawings remain the property of the University of South Australia and must be returned upon request.
These drawings may be inaccurate, and are subject to change without notice. Any errors and/or omissions should be reported to the Facilities Management Unit.

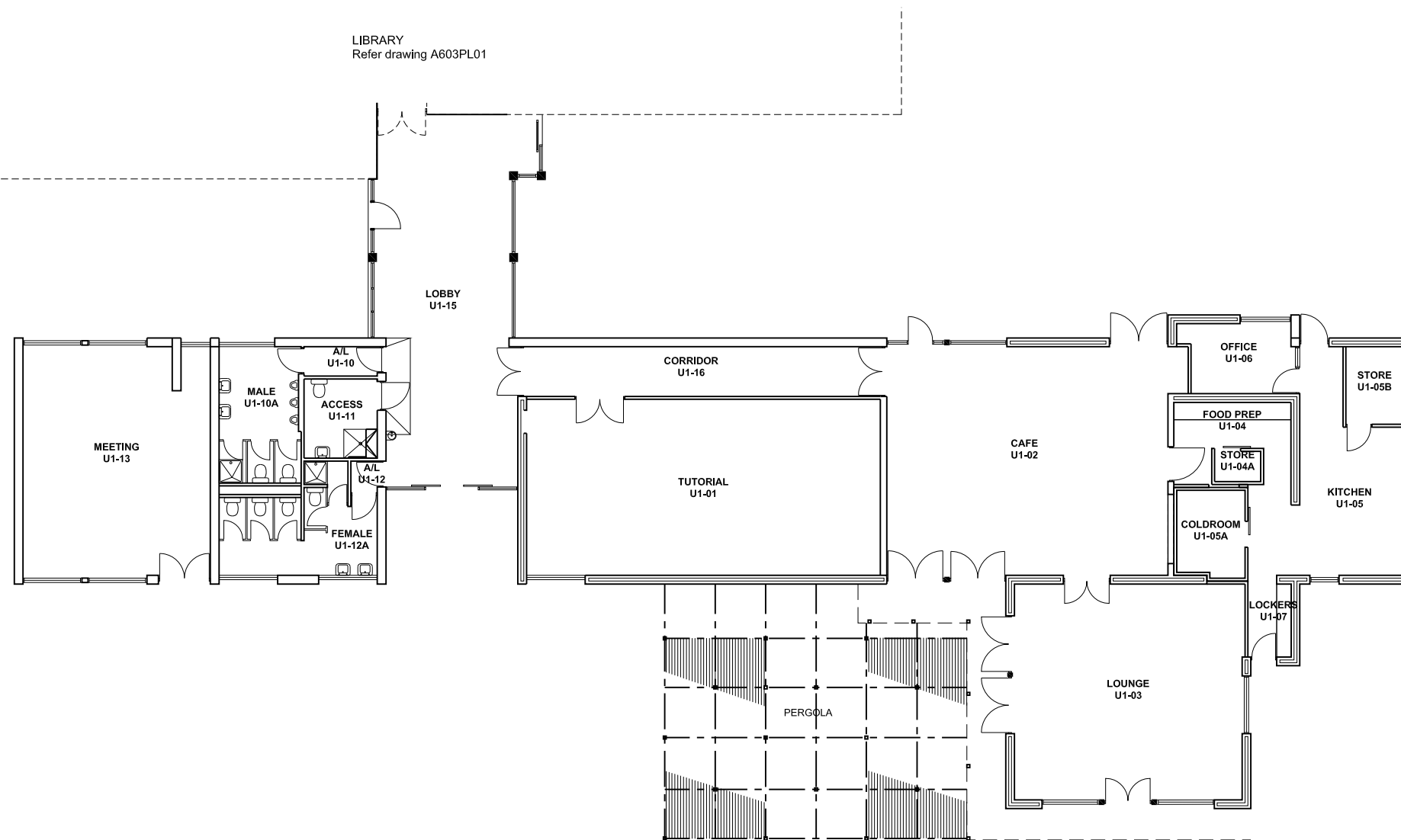

**UNIVERSITY OF
SOUTH AUSTRALIA**

FACILITIES MANAGEMENT UNIT	Level 2, 101 Currie Street, Adelaide, SA 5000 Phone 8302 2762 Fax 8302 2708
---	---

**BUILDING RECORDS
WHYALLA CAMPUS**

Building
**UNION BUILDING
LEVEL 01**

Scale: Refer to scale bar	Drawn: J Hvalica
Last Update: 24/06/2009	

Drawing No.:	Revision:
A605PL01 - W	D

